

PROPERTY FOR LEASE

12 West Medical Center

28625 Northwestern Highway Southfield, MI 48034

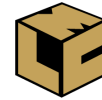

L. MASON CAPITANI
CORFAC INTERNATIONAL

PROPERTY SUMMARY



Property Highlights

- Fully Renovated Class 'A' Medical Building
- Central Southfield Location
- Seconds from Telegraph Road, I-696, M-10 and M-39
- Up to 19,526 SF Available
- Building Naming Rights Available
- Backup Generator On-Site
- Generous Improvement Allowance

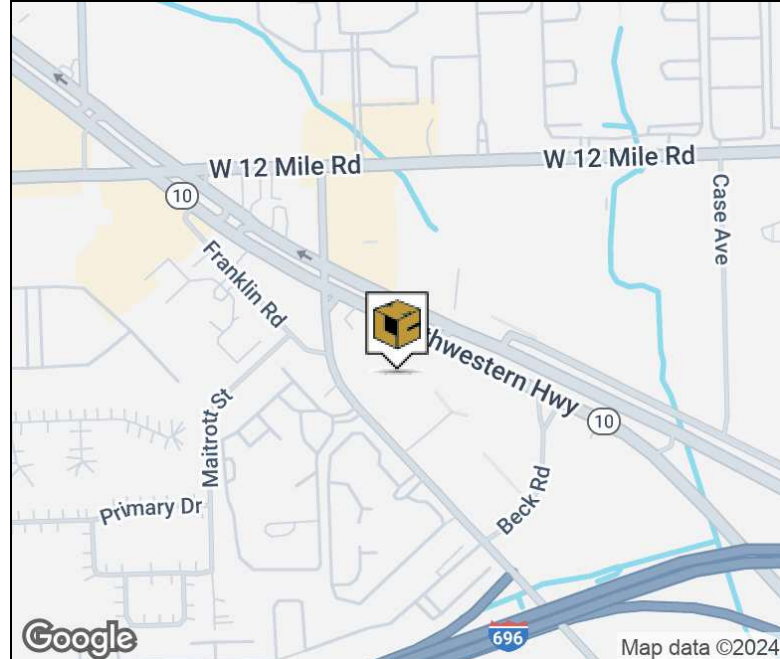

FOR MORE INFORMATION:

Mason L. Capitani, SIOR

Managing Partner

248.637.7795

mlcapitani@lmcap.com

Aaron Smith

Vice President

248.637.3515

asmith@lmcap.com



CONNECT WITH US

248.637.9700 | www.LMCap.com

Information contained herein was obtained from sources deemed to be reliable but is not guaranteed. Subjects to prior sales, changes of price or withdrawal.

PROPERTY FOR LEASE

12 West Medical Center

28625 Northwestern Highway Southfield, MI 48034



L. MASON CAPITANI
CORFAC INTERNATIONAL

LOCATION MAP

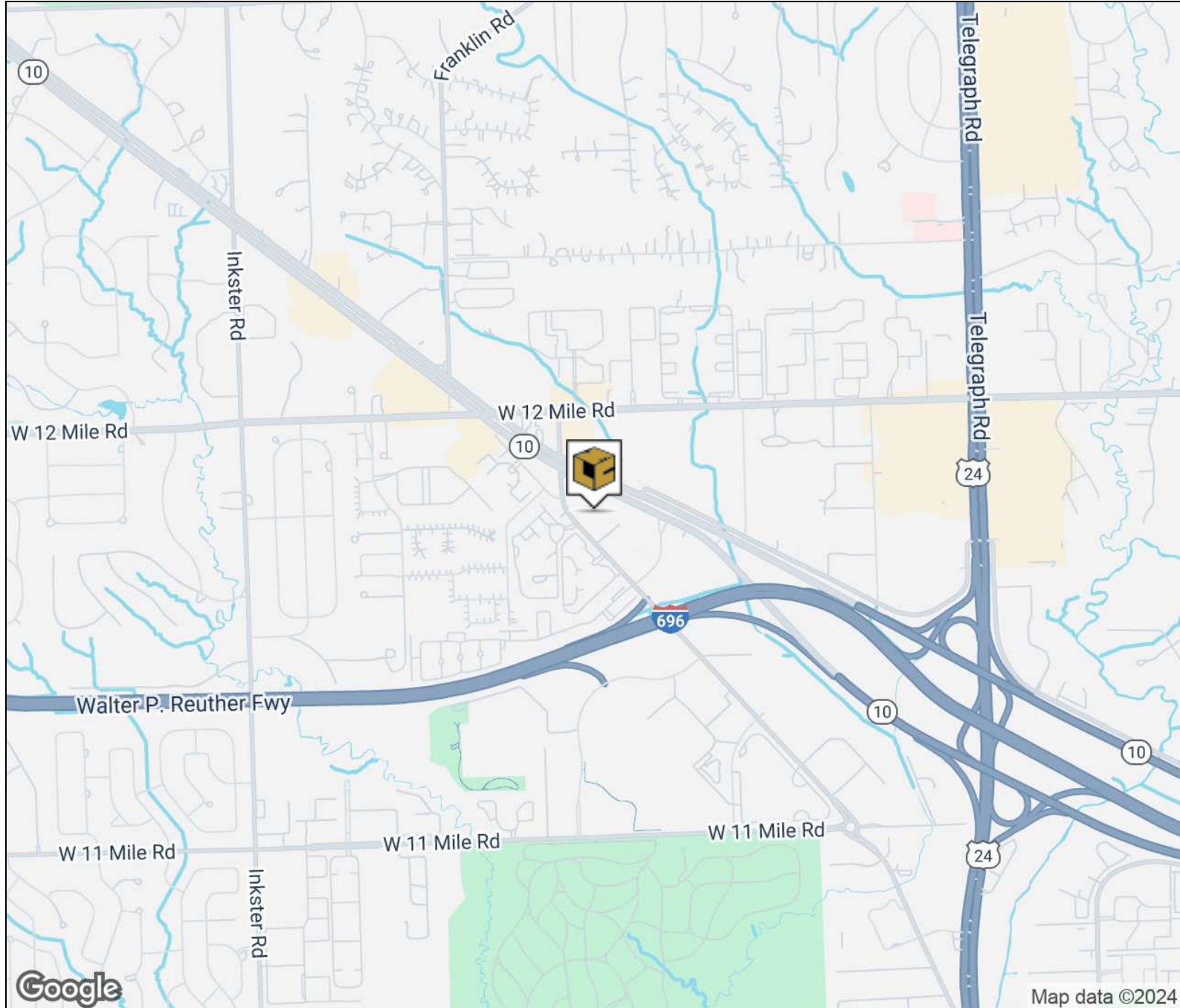

FOR MORE INFORMATION:

Mason L. Capitani, SIOR

Managing Partner

248.637.7795

mlcapitani@lmcap.com

Aaron Smith

Vice President

248.637.3515

asmith@lmcap.com



CONNECT WITH US

248.637.9700 | www.LMCap.com

Information contained herein was obtained from sources deemed to be reliable but is not guaranteed. Subjects to prior sales, changes of price or withdrawal.

PROPERTY FOR LEASE

12 West Medical Center

28625 Northwestern Highway Southfield, MI 48034



L. MASON CAPITANI
CORFAC INTERNATIONAL

OFFICE PROPERTY DETAILS

Location Information

Street Address	28625 Northwestern Highway
City, State, Zip	Southfield, MI 48034
County	Oakland
Cross-Streets	-
Nearest Highway	I-696, M-10, M-39

Building Information

Building Size	39,052 SF
Building Class	A
Occupancy %	-
Tenancy	Multiple
Number of Floors	2
Year Built	1988
Gross Leasable Area	39,052 SF
Load Factor	16.0%
Operating Expenses	\$6.00 (Est.)
Annual Escalations	3.0%
Partition Allowance	\$45

Lease Rate

\$21.50 SF/yr NNN

Property Information

Property Type	Office
Property Subtype	Medical
Zoning	B-3
Lot Size	2.42 Acres
APN #	-

Parking & Transportation

Parking Type	Surface
Parking Ratio	5.88

Available Suites

Suite 150 - 4,601 SF	\$21.50 NNN
Second Floor - 19,526 SF	\$21.50 NNN

FOR MORE INFORMATION:

Mason L. Capitani, SIOR

Managing Partner
248.637.7795
mlcapitani@lmcap.com

Aaron Smith

Vice President
248.637.3515
asmith@lmcap.com



CONNECT WITH US

248.637.9700 | www.LMCap.com

Information contained herein was obtained from sources deemed to be reliable but is not guaranteed. Subjects to prior sales, changes of price or withdrawal.

PROPERTY FOR LEASE

12 West Medical Center

28625 Northwestern Highway Southfield, MI 48034



L. MASON CAPITANI
CORFAC INTERNATIONAL

ADDITIONAL PHOTOS



FOR MORE INFORMATION:

Mason L. Capitani, SIOR
Managing Partner
248.637.7795
mlcapitani@lmcap.com

Aaron Smith
Vice President
248.637.3515
asmith@lmcap.com



CONNECT WITH US

248.637.9700 | www.LMCap.com

Information contained herein was obtained from sources deemed to be reliable but is not guaranteed. Subjects to prior sales, changes of price or withdrawal.

PROPERTY FOR LEASE

12 West Medical Center

28625 Northwestern Highway Southfield, MI 48034

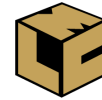

L. MASON CAPITANI
CORFAC INTERNATIONAL

ADDITIONAL PHOTOS



FOR MORE INFORMATION:

Mason L. Capitani, SIOR

Managing Partner

248.637.7795

mlcapitani@lmcap.com

Aaron Smith

Vice President

248.637.3515

asmith@lmcap.com



CONNECT WITH US

248.637.9700 | www.LMCap.com

Information contained herein was obtained from sources deemed to be reliable but is not guaranteed. Subjects to prior sales, changes of price or withdrawal.

PROPERTY FOR LEASE

12 West Medical Center

28625 Northwestern Highway Southfield, MI 48034



L. MASON CAPITANI
CORFAC INTERNATIONAL

FIRST FLOOR



Available Spaces

Suite	Tenant	Size (SF)	Lease Type	Lease Rate
Suite 150	Available	4,601 SF	NNN	\$21.50 SF/yr

FOR MORE INFORMATION:

Mason L. Capitani, SIOR
Managing Partner
248.637.7795
mlcapitani@lmcap.com

Aaron Smith
Vice President
248.637.3515
asmith@lmcap.com



CONNECT WITH US

248.637.9700 | www.LMCap.com

Information contained herein was obtained from sources deemed to be reliable but is not guaranteed. Subjects to prior sales, changes of price or withdrawal.

PROPERTY FOR LEASE

12 West Medical Center

28625 Northwestern Highway Southfield, MI 48034



L. MASON CAPITANI
CORFAC INTERNATIONAL

SECOND FLOOR

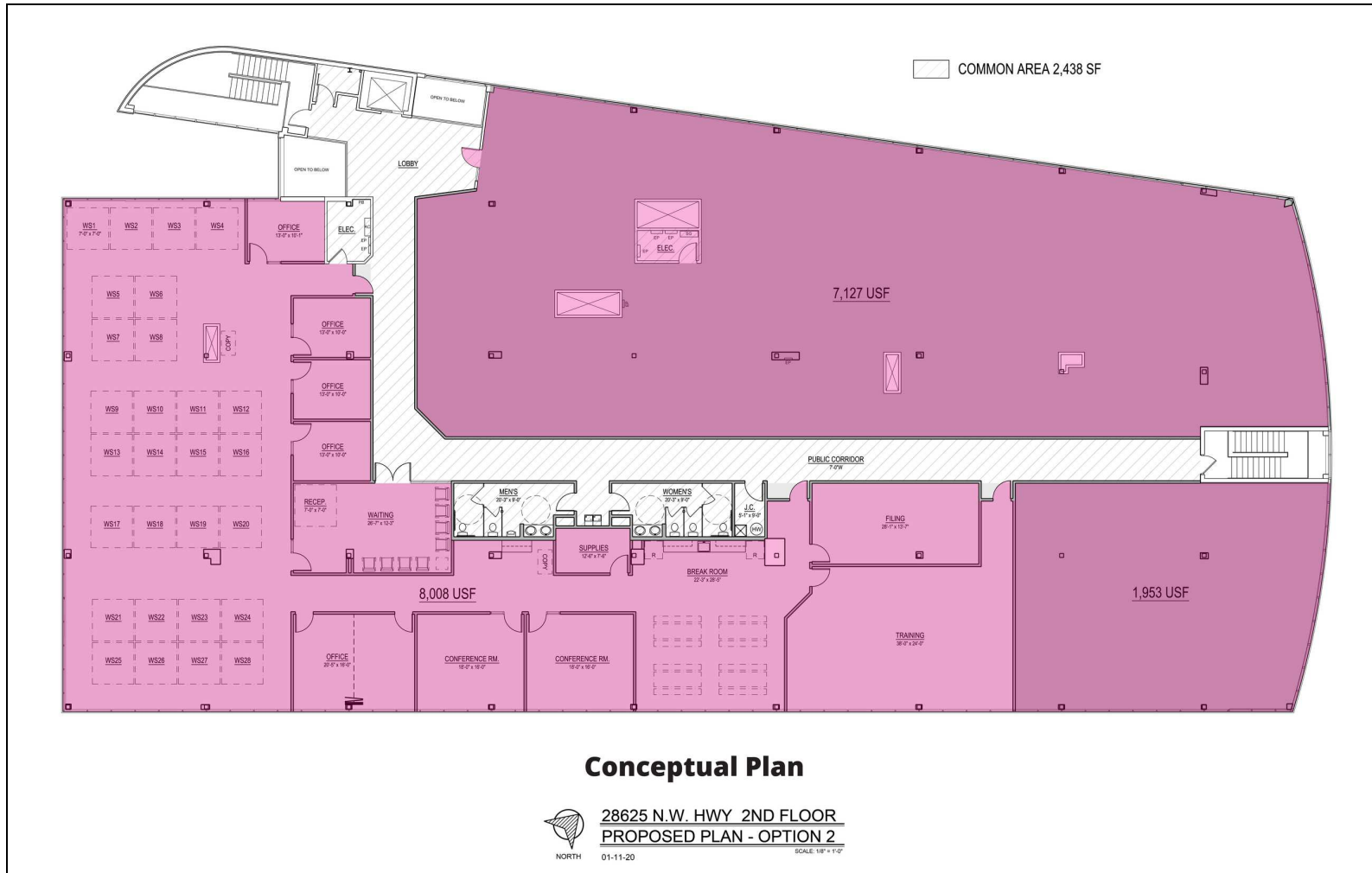

Available Spaces

Suite	Tenant	Size (SF)	Lease Type	Lease Rate
Second Floor	Available	19,526 SF	NNN	\$21.50 SF/yr

FOR MORE INFORMATION:

Mason L. Capitani, SIOR
Managing Partner
248.637.7795
mlcapitani@lmcap.com

Aaron Smith
Vice President
248.637.3515
asmith@lmcap.com



CONNECT WITH US

248.637.9700 | www.LMCap.com

Information contained herein was obtained from sources deemed to be reliable but is not guaranteed. Subjects to prior sales, changes of price or withdrawal.