



## OFFICE/WAREHOUSE SPACE

11501-11595 K-TEL DRIVE  
MINNETONKA, MN 55343

### Available Space

#### Suites 11503 & 11515

2,725 SF - Office  
5,417 - Warehouse  
8,142 SF - Total  
One (1) Dock Door  
One (1) Drive-in Door  
Available Now

#### Suite 11535

1,323 SF - Office  
8,676 - Warehouse  
9,999 SF - Total  
One (1) Dock Door  
One (1) Drive-in Door  
Available Now

#### Suite 11505

688 SF - Office  
2,609 SF - Warehouse  
3,297 SF - Total  
One (1) Drive-In Door  
Available Now

#### Suite 11501

1,647 SF - Office Total  
Available Now

### Suites 11505 & 11501

2,335 SF - Office  
2,609 SF - Warehouse  
4,944 SF - Total  
One (1) Drive-In Door  
Available Now

### Lease Rates

Market Rate - Office  
Market Rate - Warehouse

### Est. CAM/Tax

\$4.18 PSF

### Property Highlights

- Central Minnetonka location with access to I-494, MN-7, and US-169
- 12' Clear Height
- 127,354 total building square feet



For information, please contact:

**DAN FRIEDNER**  
Senior Managing Director  
t 612-430-9991  
dan.friedner@nmrk.com

**JAY CHMIELESKI**  
Senior Managing Director  
t 612-430-9982  
jay.chmielecki@nmrk.com

**PATRICK CULLEN**  
Associate Director  
t 612-430-9995  
patrick.cullen@nmrk.com

100 South Fifth St, Suite 2100  
Minneapolis, MN 55402

**nmrk.com**



**BIG RIVER®**  
REAL ESTATE

11501-11595 K-TEL DRIVE | MINNETONKA, MN 55343

## Floor Plan

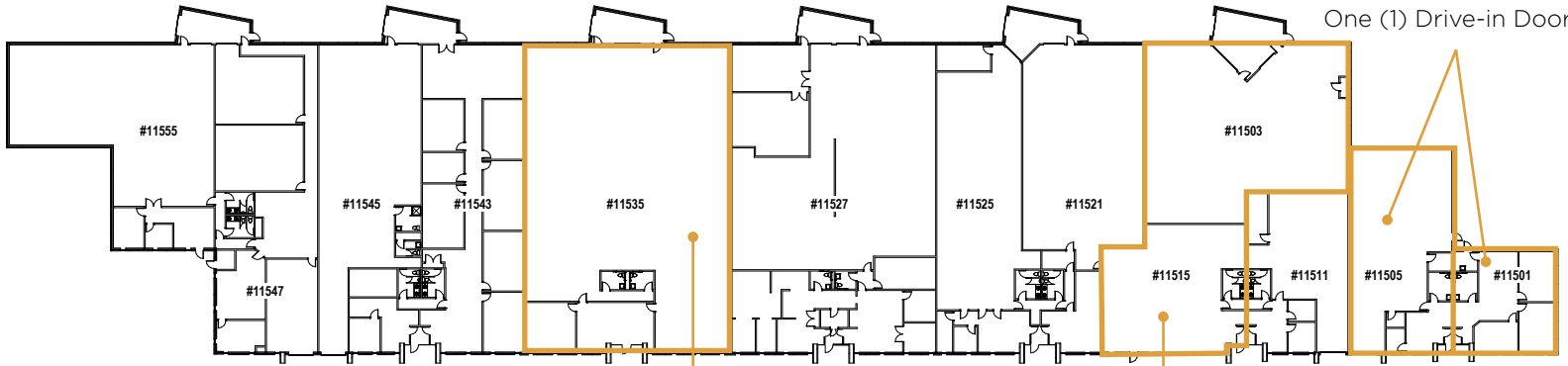

### Suites 11505 & 11501

2,335 SF - Office  
2,609 - Warehouse  
4,944 SF - Total  
One (1) Drive-in Door

### Suite 11535

1,323 SF - Office  
8,676 - Warehouse  
9,999 SF - Total  
One (1) Dock Door  
One (1) Drive-in Door

### Suites 11503 & 11515

2,725 SF - Office  
5,417 - Warehouse  
8,142 SF - Total  
One (1) Dock Door  
One (1) Drive-in Door



For information, please contact:

**DAN FRIEDNER**  
Senior Managing Director  
t 612-430-9991  
dan.friedner@nrmk.com

**JAY CHMIELESKI**  
Senior Managing Director  
t 612-430-9982  
jay.chmielewski@nrmk.com

**PATRICK CULLEN**  
Associate Director  
t 612-430-9995  
patrick.cullen@nrmk.com

100 South Fifth St, Suite 2100  
Minneapolis, MN 55402

**nrmk.com**

**NEWMARK**

The information contained herein has been obtained from sources deemed reliable but has not been verified and no guarantee, warranty or representation, either express or implied, is made with respect to such information. Terms of sale or lease and availability are subject to change or withdrawal without notice.