

RETAIL FOR LEASE

MODERA AVENTURA

2681 NE 191ST STREET • MIAMI, FL 33180





PROPERTY HIGHLIGHTS

- Situated at the base of Modera Aventura, a new ground up development with 420 studio, one-, two- and three-bedroom homes with select den layouts and an average size of 951 square feet
- 6,400 SF corner retail opportunity with potential for divisions
- Restaurants welcomed, with tie-ins to grease traps and venting to be in place
- Steps from the Brightline Aventura station

3 Miles Demographics

194,967

Population

81,323

Estimated Households

43

Median Age

\$96,053

Average Household Income

AREA RETAIL



SITE PLAN

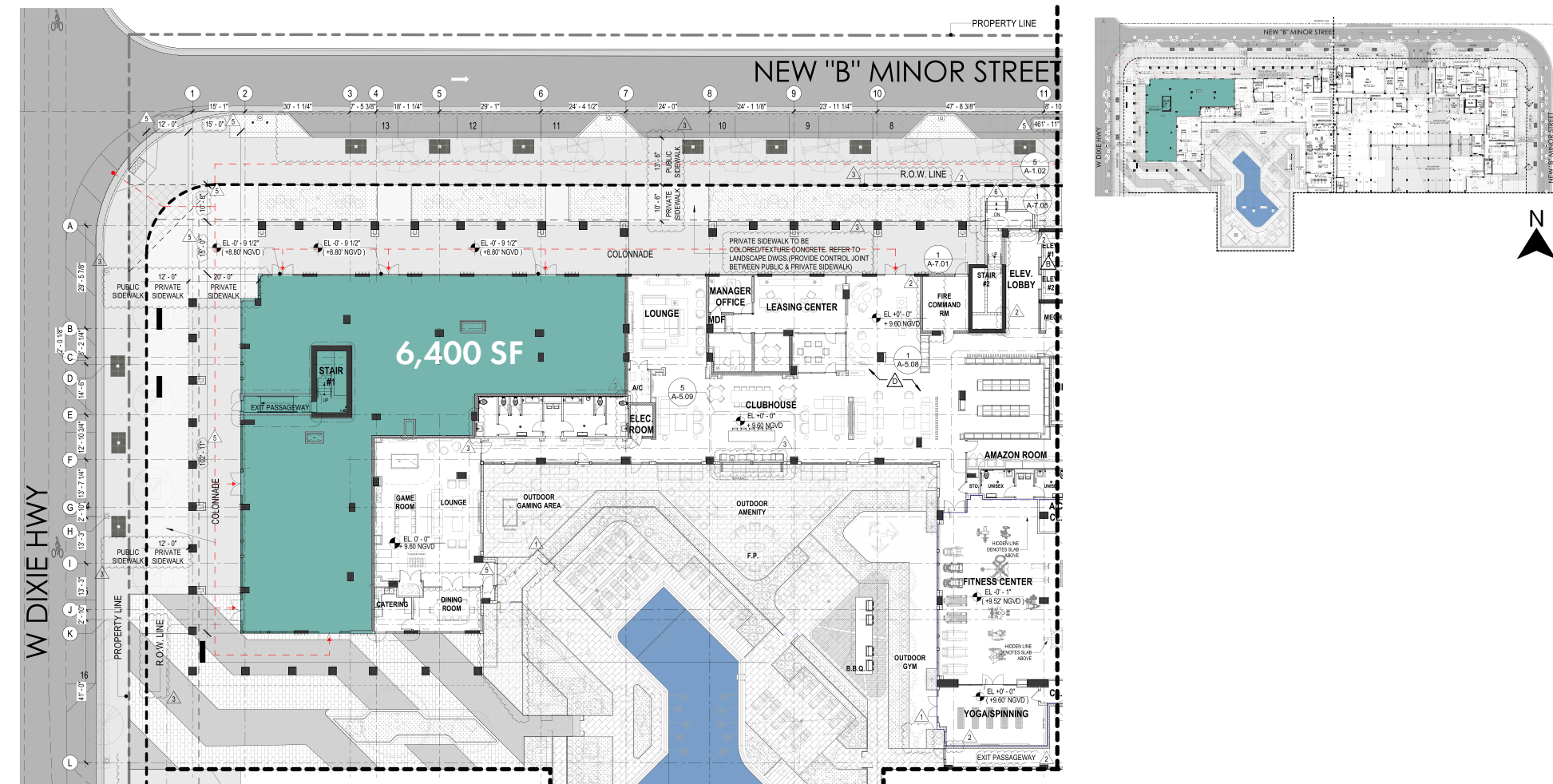

■ Available Space

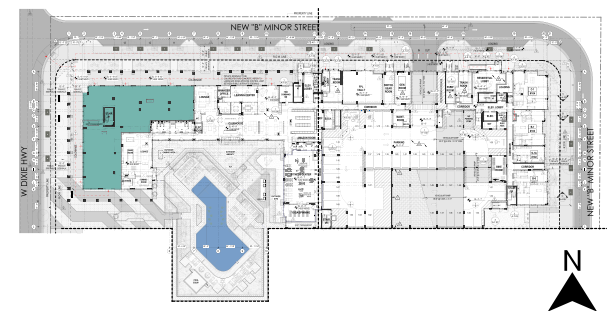

CONTACT

Zach Winkler
+ 1 305 704 1333
zach.winkler@am.jll.com

