

21370 W. MCNICHOLS ROAD
DETROIT, MICHIGAN

RETAIL FOR LEASE
2,400 Square Feet Available



**SIGNATURE
ASSOCIATES**
KNOW SIGNATURE | KNOW RESULTS

ENDCAP WITH DRIVE-THRU



PROPERTY FEATURES

- 2,400 square feet available
- Currently occupied by Vik's Coney Island
DO NOT APPROACH EMPLOYEES
- Turn-key restaurant with FF&E, including hood system
- Please contact the broker for additional information
- Lease Rate: \$37.50/sq. ft. Gross



For more information, please contact:

MARVIN PETROUS
(248) 359 0647
mpetrous@signatureassociates.com

SIGNATURE ASSOCIATES
One Towne Square, Suite 1200
Southfield, MI 48076
www.signatureassociates.com

21370 W. McNichols Road – Detroit, Michigan

Retail For Lease

2,400
Square Feet
AVAILABLE

Site Plan

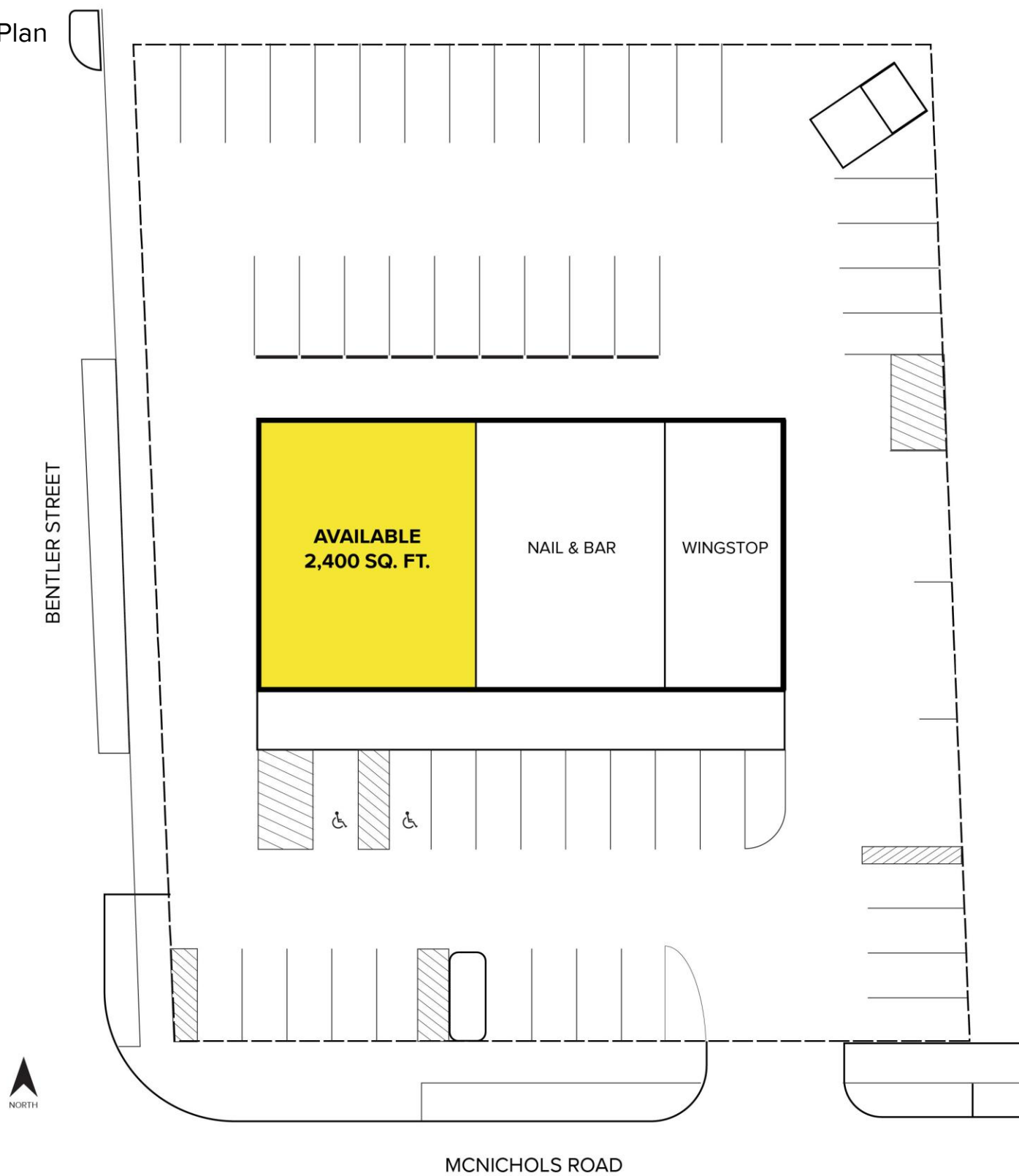

For more information, please contact:

MARVIN PETROUS

(248) 359 0647

mpetrous@signatureassociates.com

SIGNATURE ASSOCIATES

One Towne Square, Suite 1200

Southfield, MI 48076

www.signatureassociates.com

Information is subject to verification and no liability for errors or omissions is assumed. Price is subject to change and listing withdrawal.

21370 W. McNichols Road – Detroit, Michigan

Retail For Lease

2,400
Square Feet
AVAILABLE



DEMOGRAPHICS

	POPULATION	MED. HH INCOME
1 MILE	15,136	\$48,066
3 MILE	130,591	\$50,131
5 MILE	341,332	\$54,396

TRAFFIC COUNTS (TWO-WAY)

27,654	Grand River Ave. N of W. McNichols Rd.
23,379	Grand River Ave. S of W. McNichols Rd.
18,449	W. McNichols Rd. E of Grand River Ave.
11,795	W. McNichols Rd. W of Grand River Ave.

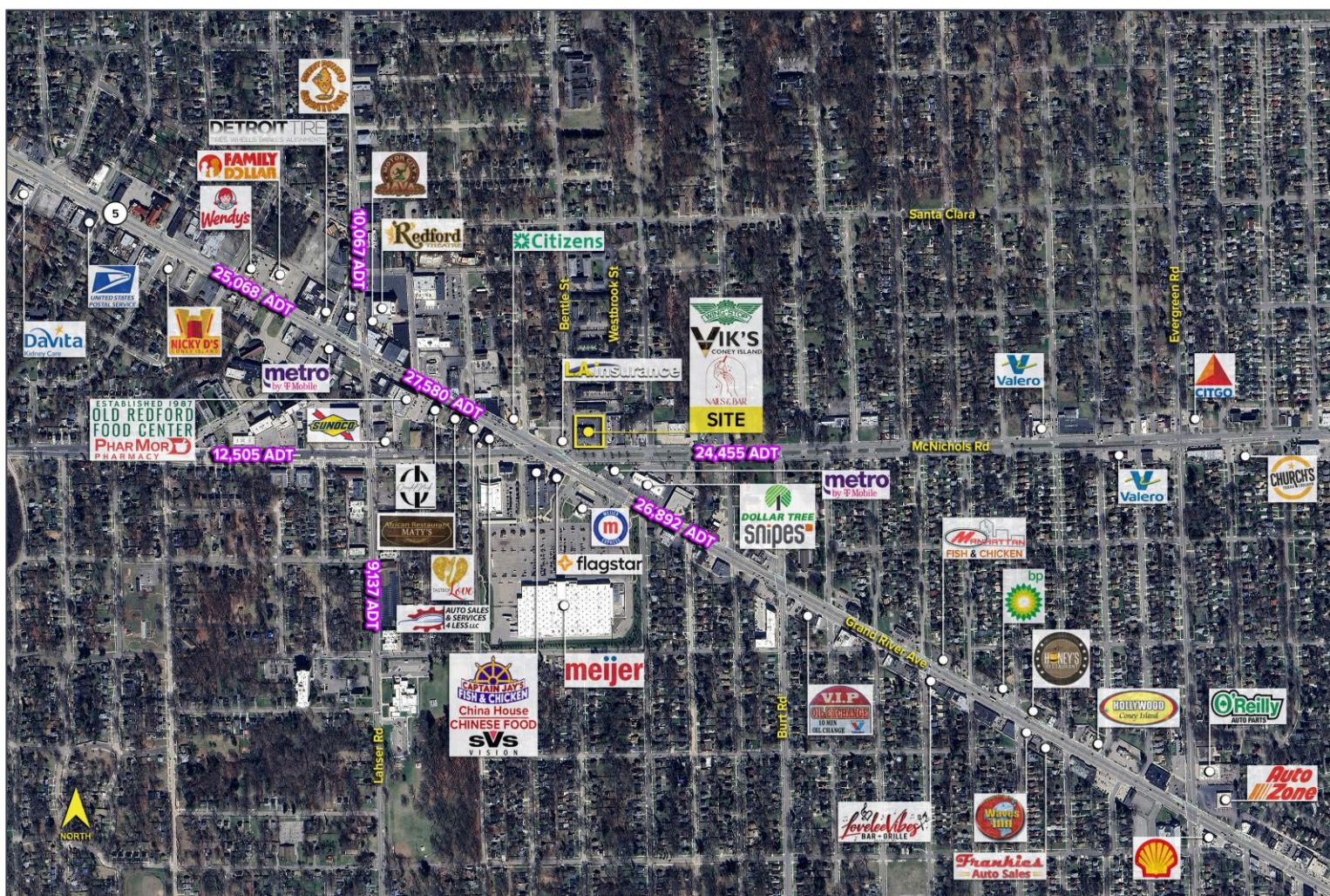

For more information, please contact:

MARVIN PETROUS
(248) 359 0647
mpetrous@signatureassociates.com

SIGNATURE ASSOCIATES
One Towne Square, Suite 1200
Southfield, MI 48076
www.signatureassociates.com