







TERRELL

LOGISTICS CENTER





PROPERTY HIGHLIGHTS

-  Triple Freeport Tax Exemption
-  Quick access to US-80 and I-20
-  Deep labor pool with quickly growing blue collar labor population
-  Robust nearby amenities
-  Incentives available through Kaufman County and City of Terrell





TERRELL LOGISTICS CENTER

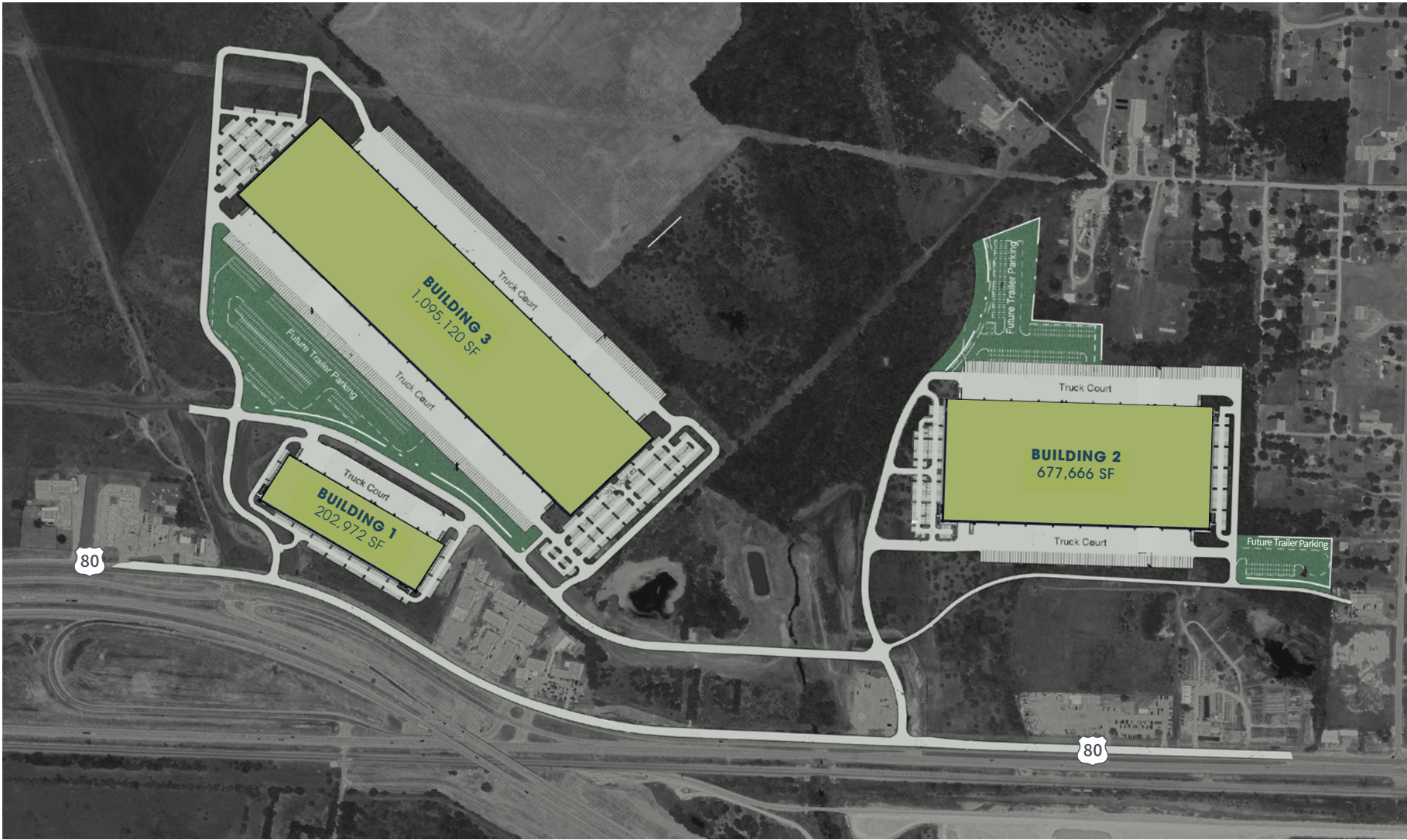

BUILDING 1 | 202,972 SF (810' x 250')

- COLUMN SPACING**
Speed Bay - 60' x 54'; Typical Bays - 47'6" x 54'
- CONFIGURATION**
Rear Load
- CLEAR HEIGHT**
32' measured at the first column
- ROOF**
60-mil R-25
- INTERIOR LIGHTING**
LED warehouse lights, 30' candles
- FIRE PROTECTION**
ESFR sprinkler system
- DOCKS LAYOUT & EQUIPMENT**
46 dock doors, 2 drive-ins, (20) 40,000lb mechanical dock levelers
- CAR PARKING**
187 parking spaces available
- TRUCK COURT**
131' total depth
- SPEC OFFICE**
1,500 SF spec office

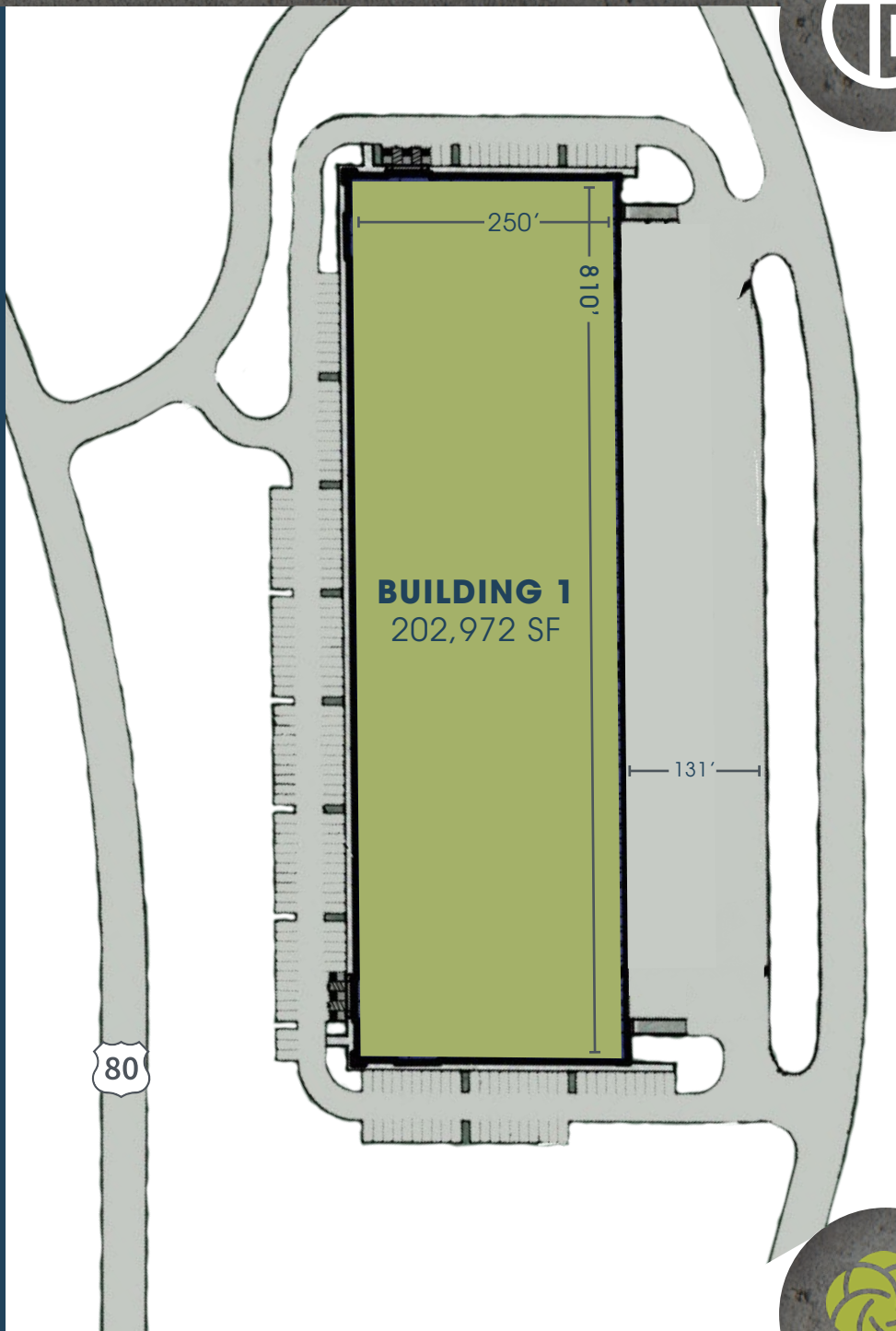





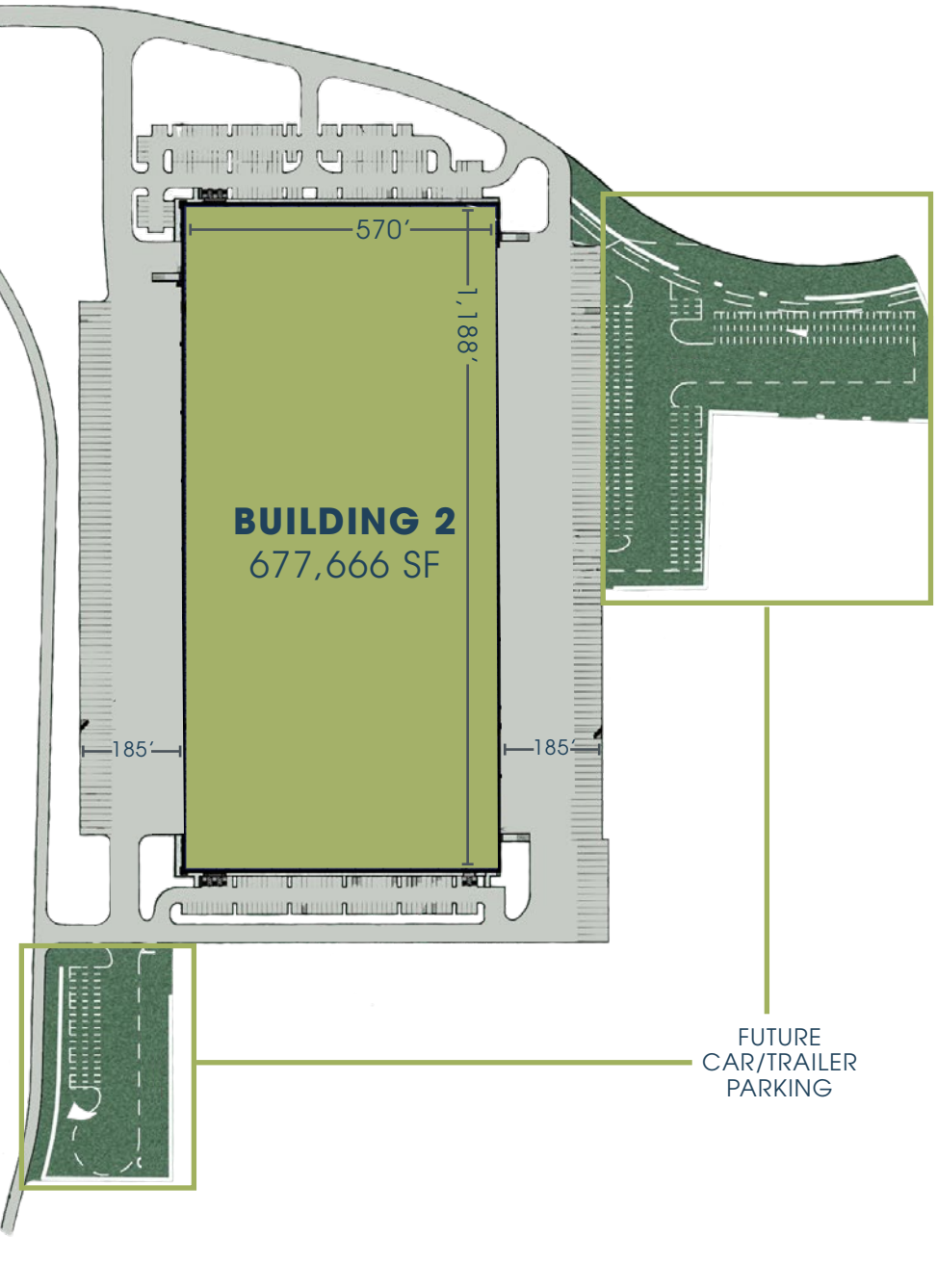

BUILDING 2 | 677,666 SF (1,188' x 570')

-  **COLUMN SPACING**
Speed Bay - 60' x 54'; Typical Bays - 50' x 54'
-  **CONFIGURATION**
Cross Dock
-  **CLEAR HEIGHT**
40' measured at the first column
-  **ROOF**
60-mil R-25
-  **INTERIOR LIGHTING**
LED warehouse lights, 30' candles
-  **FIRE PROTECTION**
ESFR sprinkler system
-  **DOCKS LAYOUT & EQUIPMENT**
134 dock doors, 4 drive-ins, (50) 40,000lb mechanical dock levelers
-  **CAR PARKING**
281 parking spaces available
-  **TRAILER PARKING**
182 parking spaces available + 97 future parking spaces
-  **TRUCK COURT**
185' total depth
-  **SPEC OFFICE**
3,000 SF spec office



BUILDING 3 | 1,095,120 SF (2,106' x 520')

-  **DOCK DOORS**
(244) 9' x 10'
-  **RAMP DOORS**
(4) 12' x 14'
-  **CAR PARKING**
659 parking spaces available + 51 future parking spaces
-  **TRAILER PARKING**
307 parking spaces available + 214 future parking spaces
-  **TRUCK COURT**
190' total depth

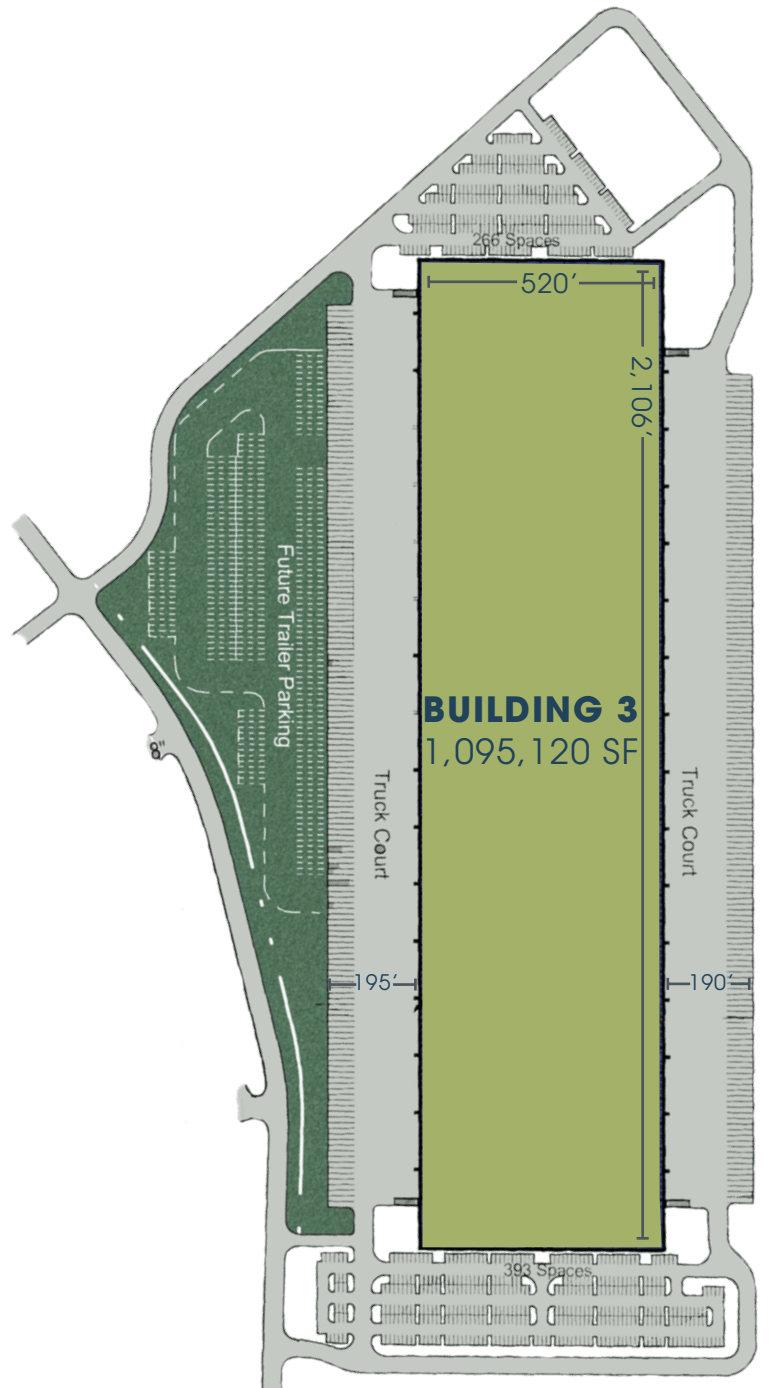



CORPORATE NEIGHBORS

- 1. Amazon
- 2. Amazon
- 3. AutoZone Distribution Center
- 4. Carlisle Construction Materials
- 5. Conesus LLC
- 6. Goodyear Logistics Center
- 7. Hayes Retail Services
- 8. Hithium
- 9. Lineage
- 10. Martin Marietta - Terrell Ready Mix
- 11. Nucor Building Systems
- 12. Olympic Services Inc.
- 13. RealTruck
- 14. Steelway International
- 15. WalMart Distribution Center
- 16. Whitmore

NEARBY AMENITIES

- 1. ALDI
- 2. Applebee's Grill + Bar
- 3. Brookshire's
- 4. Buc-ee's
- 5. Burger King
- 6. Chick-fil-A
- 7. Chili's Grill & Bar
- 8. Chipotle Mexican Grill
- 9. Chuy's
- 10. Country House Café
- 11. Frank's BBQ
- 12. IHOP
- 13. Jack in the Box
- 14. Kroger Marketplace
- 15. Los Hermanos
- 16. Lowe's Home Improvement
- 17. Marshalls
- 18. McDonald's
- 19. Napolis Italian Restaurant
- 20. Olive Garden Italian Restaurant
- 21. Raising Cane's Chicken Fingers
- 22. Schlotzsky's
- 23. Sonic Drive-In
- 24. Sonic Drive-In
- 25. Starbucks
- 26. Starbucks
- 27. Taco Bell
- 28. Texas Roadhouse
- 29. The Home Depot
- 30. The Shops at Terrell
- 31. Waffle House
- 32. Walmart Supercenter
- 33. Walmart Supercenter
- 34. Wendy's





CONNECTIVITY

-  **UP INTERMODAL MESQUITE**
20 MILES
-  **UP INTERMODAL WILMER**
27 MILES
-  **KCS INTERMODAL WYLIE**
29 MILES
-  **DALLAS LOVE FIELD AIRPORT**
32 MILES
-  **DALLAS FORT WORTH INT'L AIRPORT**
44 MILES
-  **FORT WORTH ALLIANCE AIRPORT**
66 MILES
-  **BNSF RAILWAY INTERMODAL (ALLIANCE)**
67 MILES

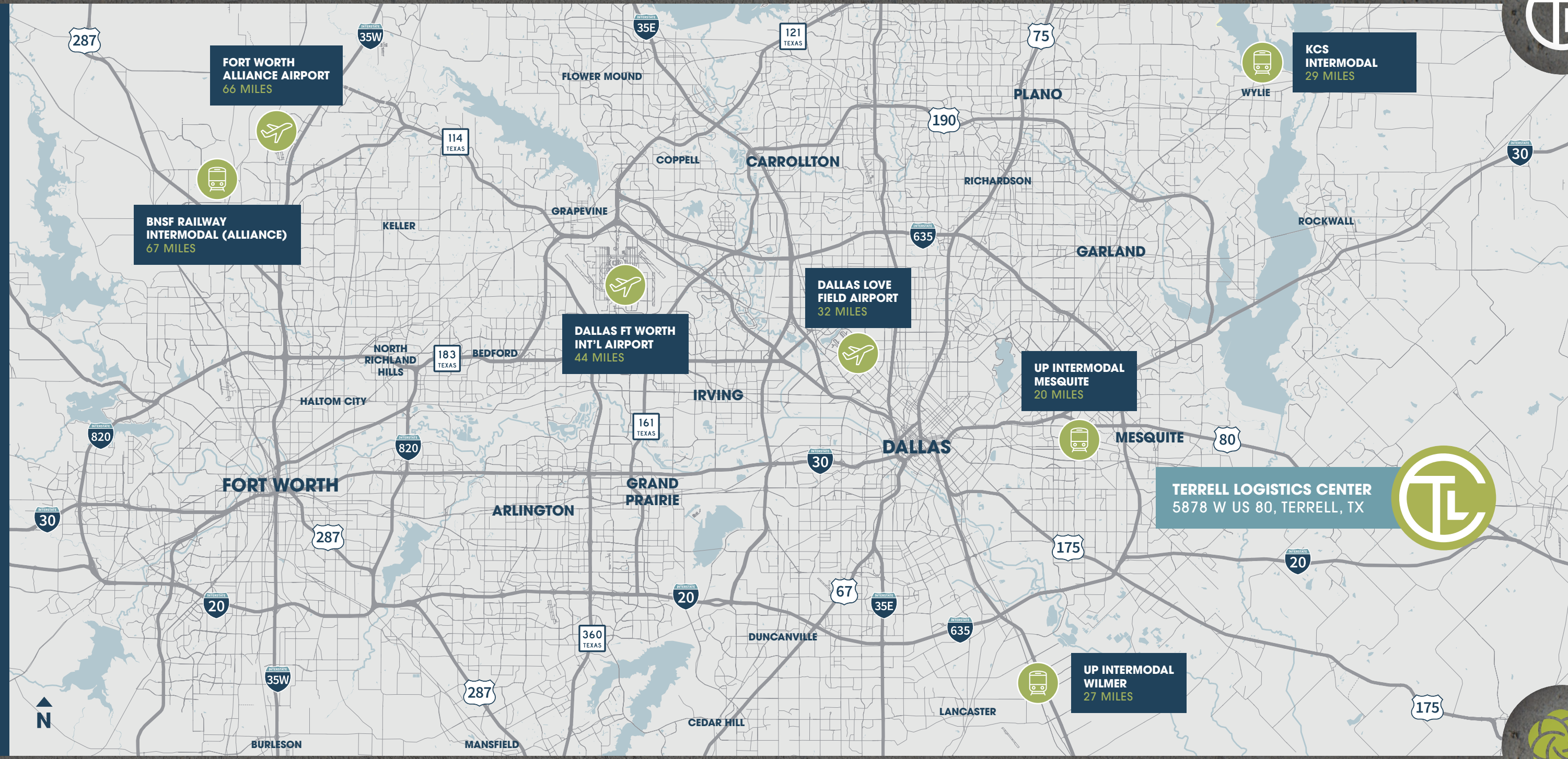



TERRELL

LOGISTICS CENTER

KURT GRIFFIN

Kurt.Griffin@jll.com
214 438 6372

NATHAN ORBIN

Nathan.Orbin@jll.com
214 438 1649



Although information has been obtained from sources deemed reliable, neither Owner nor JLL makes any guarantees, warranties or representations, express or implied, as to the completeness or accuracy as to the information contained herein. Any projections, opinions, assumptions or estimates used are for example only. There may be differences between projected and actual results, and those differences may be material. The Property may be withdrawn without notice. Neither Owner nor JLL accepts any liability for any loss or damage suffered by any party resulting from reliance on this information. If the recipient of this information has signed a confidentiality agreement regarding this matter, this information is subject to the terms of that agreement. ©2024. Jones Lang LaSalle IP, Inc. All rights reserved.