



For Sublease

±22,500 SF Industrial Office/Warehouse

Site features:

- **Total:** ±22,500 SF
- **Office:** ±2,070 SF
- 24' Eve Height
- 10-Ton Crane ready
- Grade Level Loading
- One (1) 12' x 14' OH Doors
- Three (3) 9' x 10' OH Doors
- Fenced Lot
- **Asking Rate:** \$0.95/sf NNN
- **OPEX:** Please contact broker
- **Sublease Expiration:** 1/31/2025 (longer term available)

1150 Hall Court
Deer Park, TX 77536

Carl Mueller

+1 713 425 1829

carl.mueller@jll.com

Katie Madden

+1 346 352 5512

katie.madden@jll.com



For Sublease

±22,500 SF Industrial Office/Warehouse

1150 Hall Court | Deer Park, TX 77536

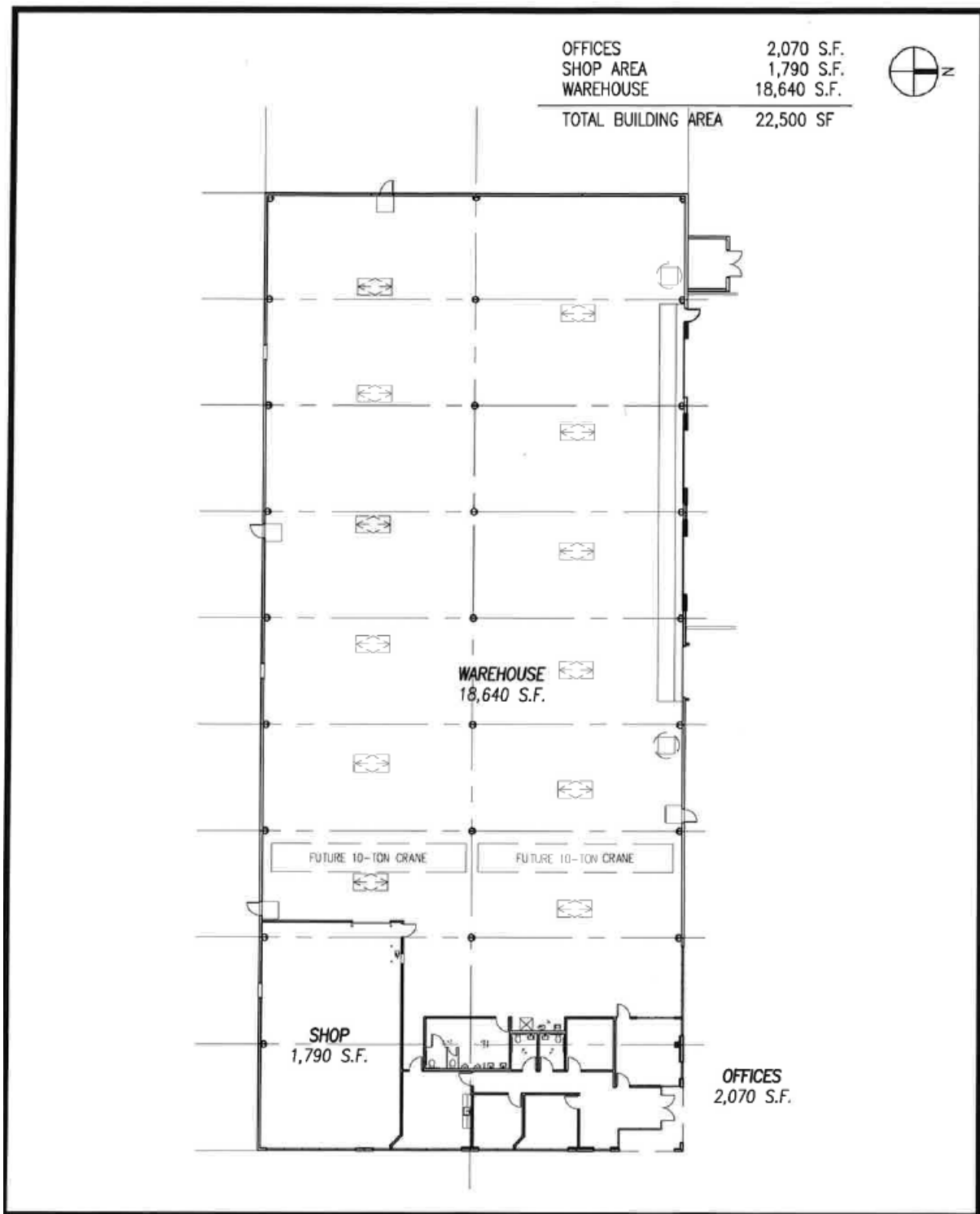

Although information has been obtained from sources deemed reliable, JLL does not make any guarantees, warranties or representations, express or implied, as to the completeness or accuracy as to the information contained herein. Any projections, opinions, assumptions or estimates used are for example only. There may be differences between projected and actual results, and those differences may be material. JLL does not accept any liability for any loss or damage suffered by any party resulting from reliance on this information. If the recipient of this information has signed a confidentiality agreement with JLL regarding this matter, this information is subject to the terms of that agreement. ©2021 Jones Lang LaSalle IP, Inc. All rights reserved.



For Sublease

±22,500 SF Industrial Office/Warehouse

1150 Hall Court | Deer Park, TX 77536



Although information has been obtained from sources deemed reliable, JLL does not make any guarantees, warranties or representations, express or implied, as to the completeness or accuracy as to the information contained herein. Any projections, opinions, assumptions or estimates used are for example only. There may be differences between projected and actual results, and those differences may be material. JLL does not accept any liability for any loss or damage suffered by any party resulting from reliance on this information. If the recipient of this information has signed a confidentiality agreement with JLL regarding this matter, this information is subject to the terms of that agreement. ©2021 Jones Lang LaSalle IP, Inc. All rights reserved.

