

INTERNATIONAL CORPORATE PARK

MIAMI-DADE
DORAL

9905 NW 17th St.
Doral, FL 33172



FOR LEASE

Suite #101 & #105

#101: $\pm 28,390$ SF

#105: $\pm 29,052$ SF



LEASED BY





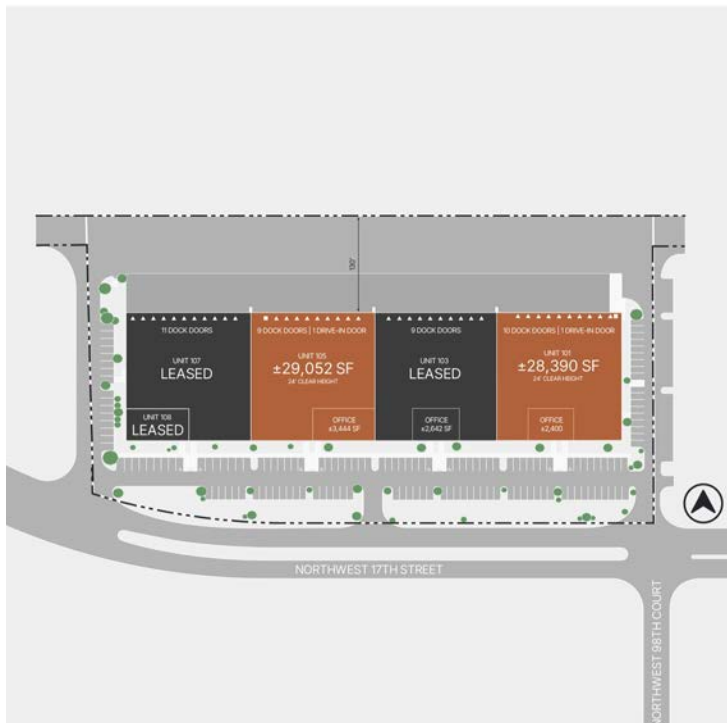
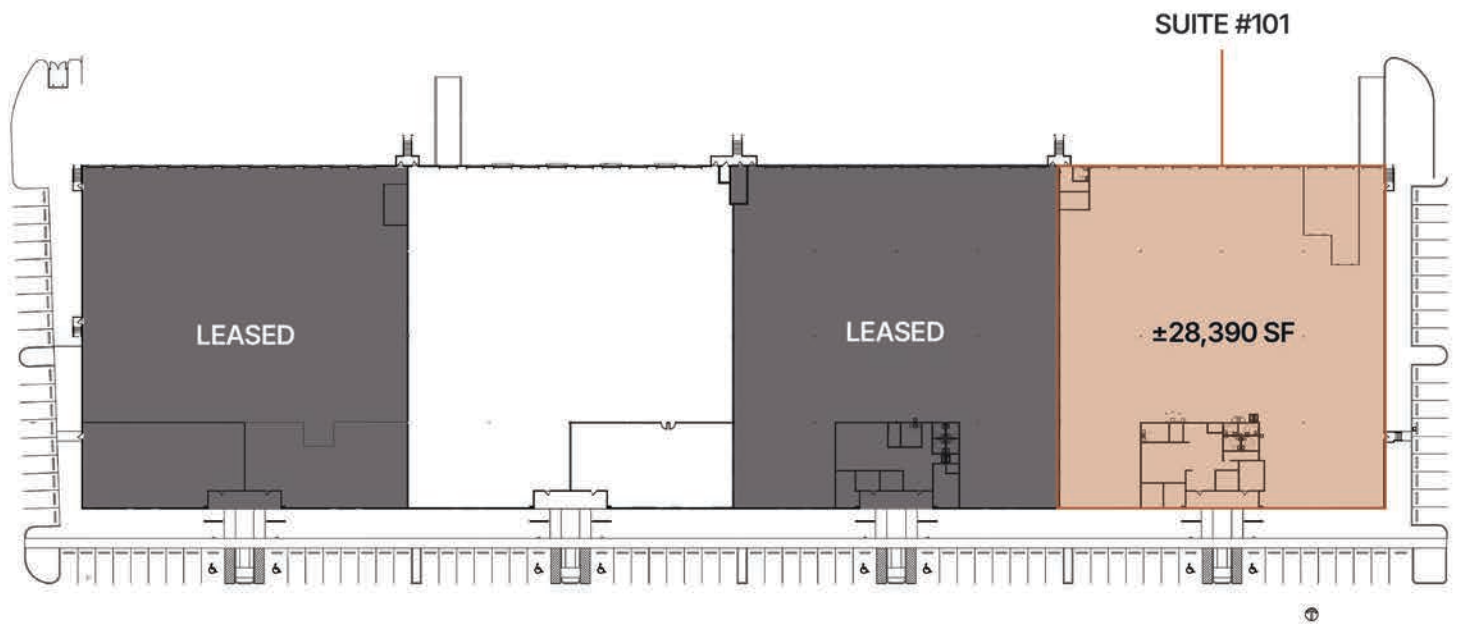

SUITE #101 PROPERTY FEATURES

Available Size	±28,390 SF
Office Suite	±2,400 SF (New Const.)
Clear Height	±24'
Dock High	10 Doors (2 Recessed)
Dock Equipment	6 Pit Levelers
Ground Level	1 Concrete Ramp
Parking	1/1,000 SF
Building Depth	175'
Sprinkler	Wet System
Column Spacing	43'9" x 41'6"
Truck Court	±130' Non-Shared Truck Court
Additional	End Cap Unit

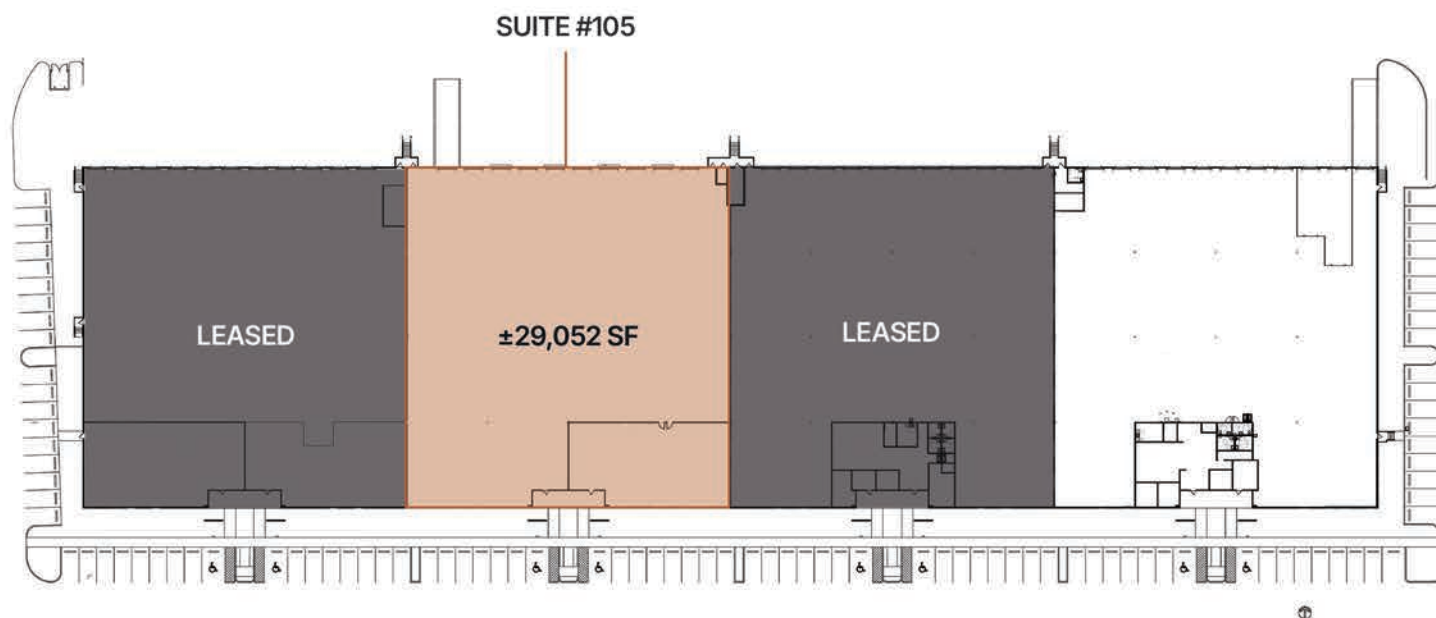

SUITE #105 PROPERTY FEATURES

Available Size	±29,052 SF
Office Suite	±3,444 SF
Clear Height	±24'
Dock High	9 Doors
Dock Equipment	6 Edge of Dock Levelers
Ground Level	1 Concrete Ramp
Parking	1/1,000 SF
Building Depth	175'
Sprinkler	Wet System
Column Spacing	43'9" x 41'6"
Truck Court	±130' Non-Shared Truck Court

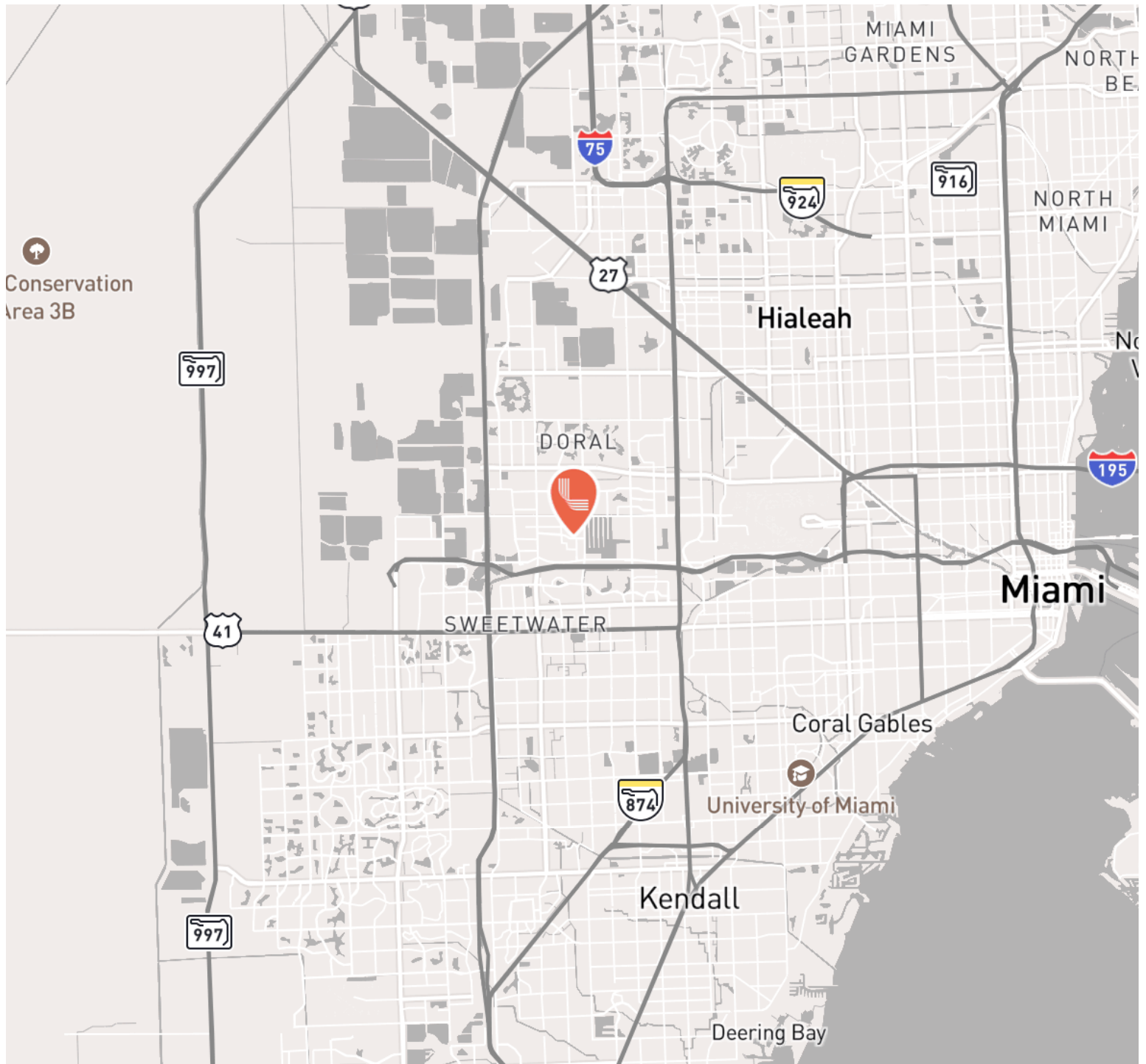

Port of Miami:
±13 Miles



Dolphin Expressway:
±1.5 Miles



I-95:
±11 Miles



Miami International Airport:
±5 Miles



Palmetto Expressway:
±3 Miles



Florida's Turnpike:
±2.5 Miles

Committed to Driving Value for Our Customers

Properties with a Competitive Edge

Our scale, proprietary data and local relationships allow our 1,200+ skilled team members to help customers stay ahead of market trends.

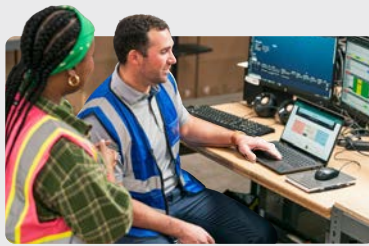

Best-in-Class Customer Service

Our on-the-ground regional teams provide you with local expertise, leveraging data-driven insights to find the right solutions for your business.

Link+

Our digital customer experience platform provides easy access to your property management teams, lease documents, billing and service requests. Sign up today!

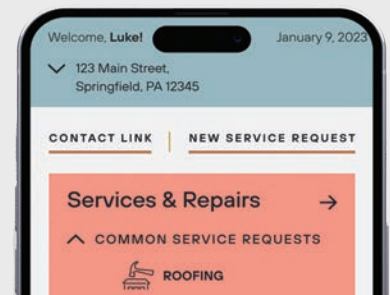

500 Million
Square Foot
Portfolio

Energy Solutions

Our comprehensive energy and utility management program enables customers to achieve savings and access our in-house sustainability experts. Enroll through Link+.



CONTACT INFORMATION



201 S. Biscayne Blvd. Suite 1420
Miami, FL 33131

Steve Medwin, SIOR, CCIM
steve.medwin@streamrealty.com
(305) 615-4415

Nick Wigoda, SIOR
nick.wigoda@streamrealty.com
(305) 615-4461

This is not an offer or acceptance of an offer to lease space. A lease will only be offered or made in a written agreement signed by landlord. No representation or warranty of any kind is made by landlord unless set forth in a written definitive lease executed by the landlord.



LEASED BY

