



# FOR LEASE

- ✔ Unit #300 | 5,500 SF Available
- ✔ Brand New Class A Flex Space
- ✔ Direct I-15 / I-84 Visibility & Access
- ✔ Strategic Northern Utah Location
- ✔ Ample Parking & Truck Circulation
- ✔ 14' H x 16' W Rear Overhead Door
- ✔ 28'-30' High Ceilings w/ 23'-25' Clear
- ✔ 3-Phase Power Available
- ✔ Ready for Tenant Improvements



**\$1.15/SF/NNN**

**1204 N 2000 W #300  
Farr West, UT 84404**

**CREST**  
REALTY

# Floor Plan



Unit #300 = 5,500 Sq Ft  
 Total Building = 22,000 Sq Ft

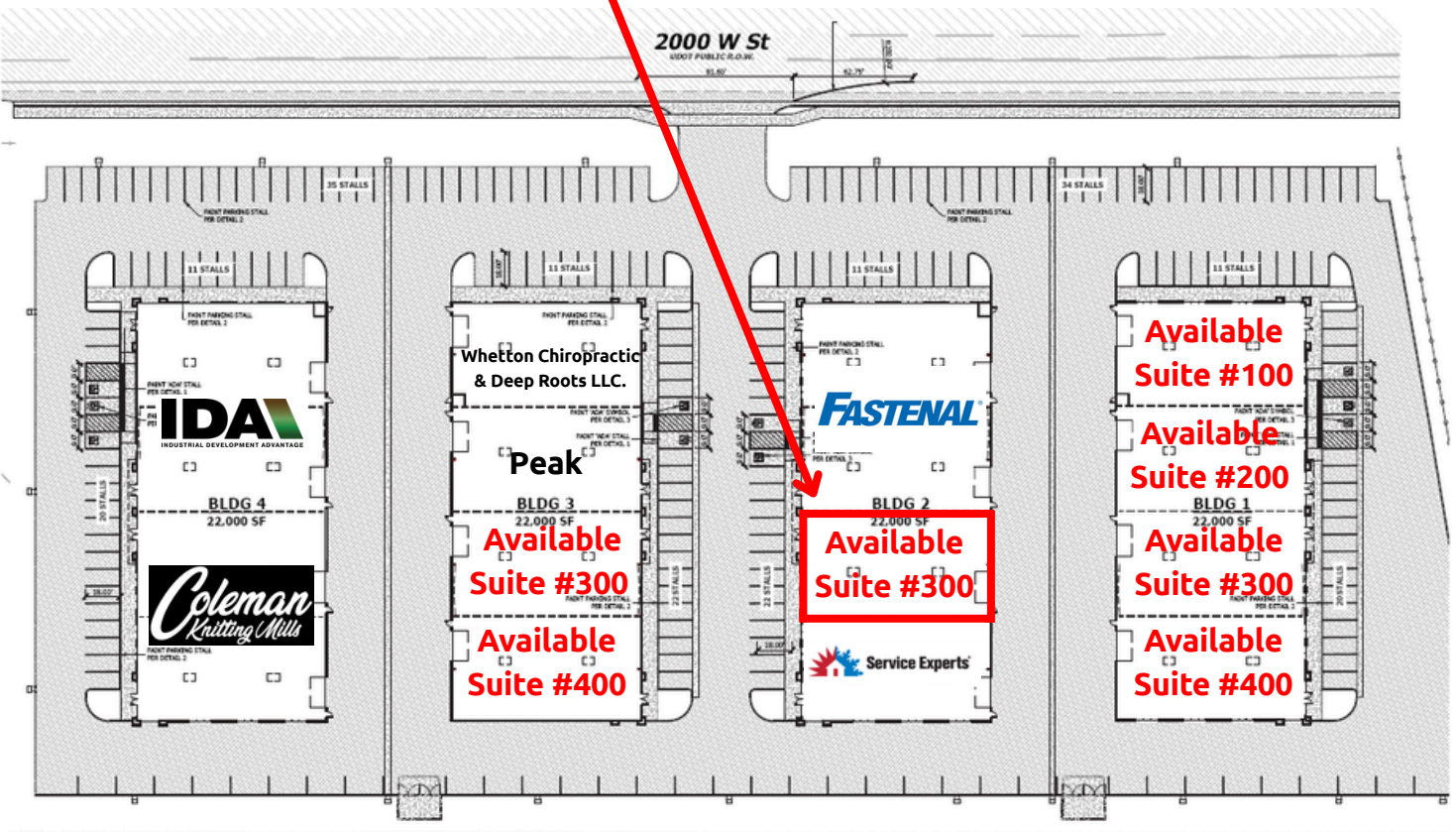
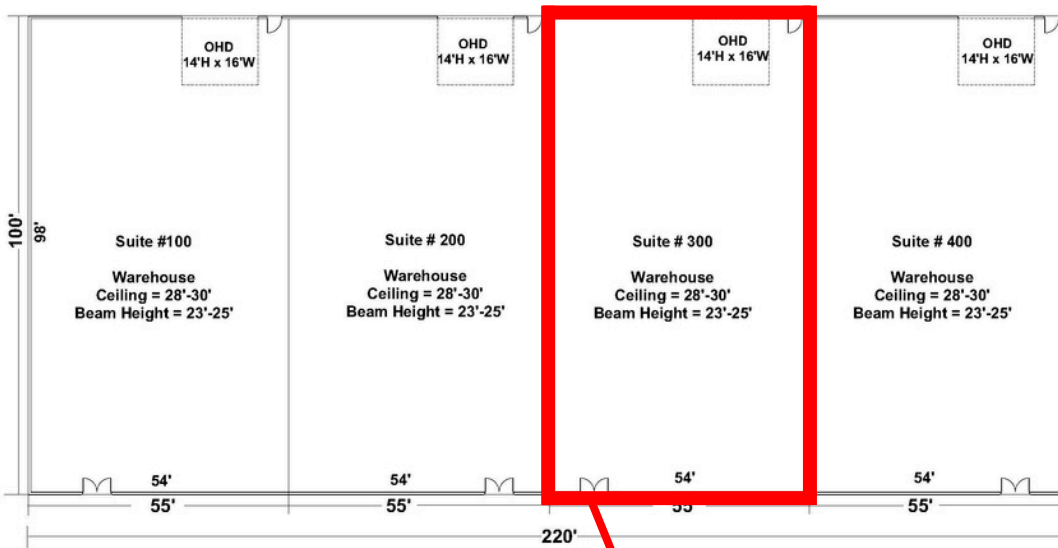

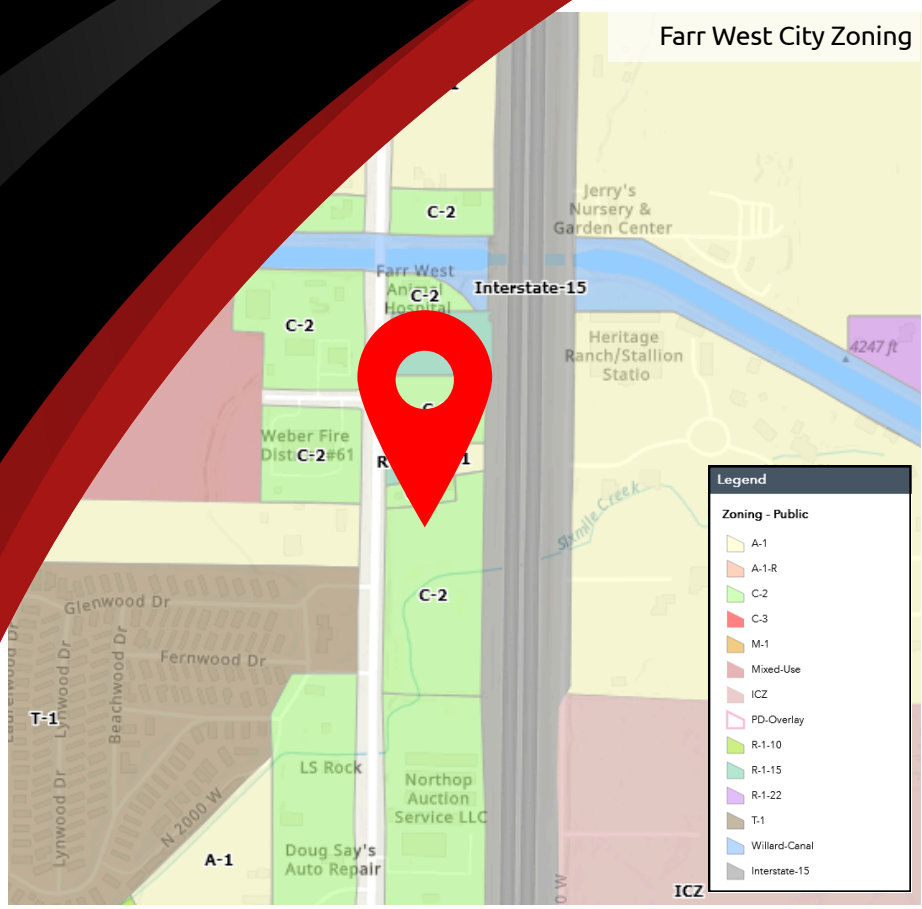

1204 N 2000 W  
FARR WEST, UT 84404



**Garrett Pierson**  
801-644-1361  
g@crestutah.com



**Aaron McCrady**  
801-953-7012  
aaroncrest@gmail.com



# Contact Us



**Garrett Pierson**  
801-644-1361  
g@crestutah.com



**Aaron McCrady**  
801-953-7012  
aaroncrest@gmail.com



www.crestutah.com  
968 Chambers St #2,  
South Ogden UT 84403  
801-476-9500

