

# The COLONIAL

at Seneca Steps

1119 1st Avenue, Seattle



# The COLONIAL at Seneca Steps

with direct access to  
Post Alley & Seattle's  
New Waterfront District

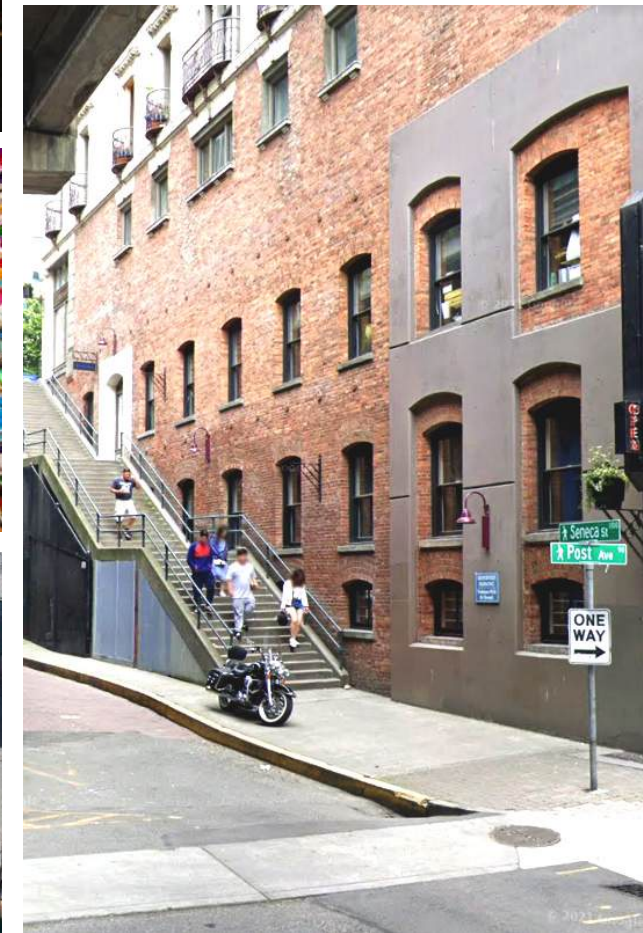



## Introducing SEATTLE'S WATERFRONT DISTRICT

The Colonial is located along First Avenue, at the Seneca Steps access point of Seattle's New Waterfront District and across the street from Post Alley & the famous Pike Place Market which receives 21M Annual Visitors.

**18M+**  
SQ.FT OF NEW OFFICE  
(DEVELOPED OR  
PLANNED)

**37M+**  
ANNUAL VISITORS

**15K+**  
HOTEL ROOMS

**13K+**  
NEW RESIDENTIAL  
UNITS



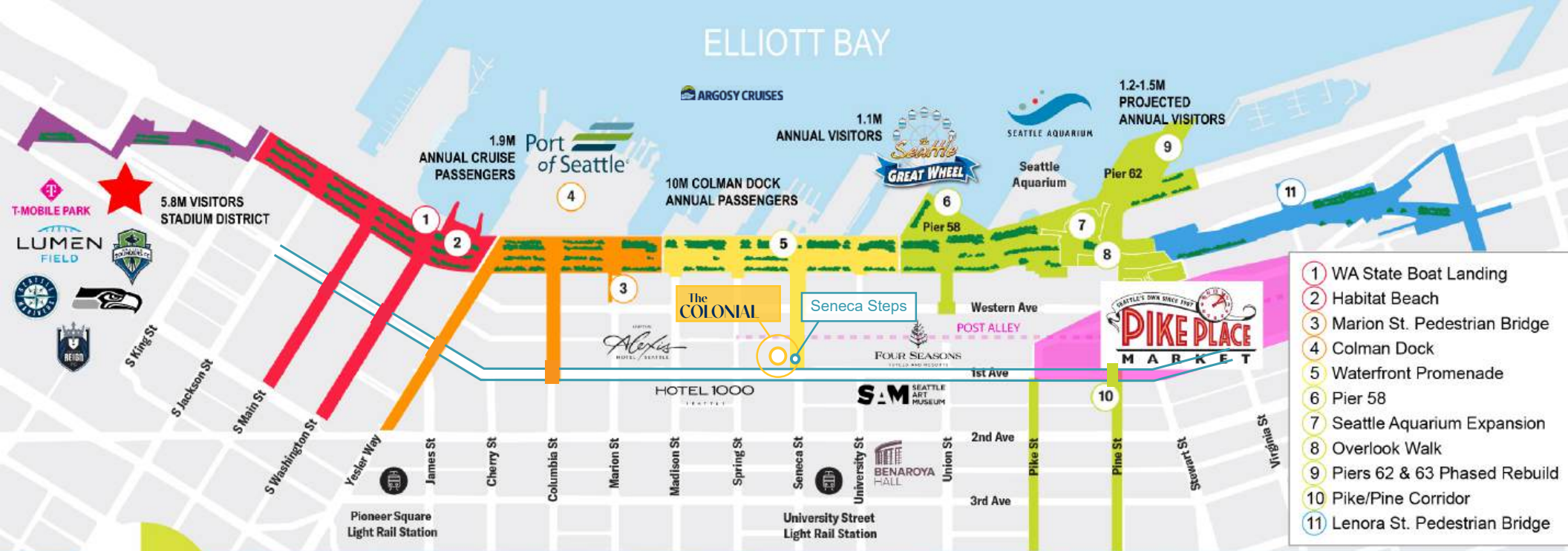

THE SEATTLE WATERFRONT REDEVELOPMENT EXTENDS UP ALASKAN WAY FROM LUMEN FIELD TO BELL STREET, WITH SIGNIFICANT IMPROVEMENTS MADE TO CREATE CONNECTIONS BETWEEN NEW AND OLD PARK SPACES, RESTAURANTS, SHOPS AND NEIGHBORHOODS WITH RAISED STREET CROSSINGS AND WIDENED SIDEWALKS FOR PEDESTRIANS. THE WATERFRONT PROJECT STARTED CONSTRUCTION IN 2020 AND IS EXPECTED TO DELIVER THE FINAL PHASES IN 2025.

**\$1.07B**  
REDEVELOPMENT PROJECT

**\$400M**  
ANNUAL BUSINESS REVENUE

**8-12M**  
PROJECTED ANNUAL VISITORS



## ICONICALLY SEATTLE

Join the most popular and exciting part of downtown Seattle, near the major ports and traffic hubs that provide access to all other outlying districts. The tourism district boasts four star hotels like the Alexis Royal Sonesta, Hotel 1000, the Seattle Four Seasons, and prime entertainment venues including the Showbox Pike Place, The Triple Door, and Benaroya Hall.



# HARBOR STEPS APARTMENTS

SENECA STEPS ACCESS TO POST ALLEY & WATERFRONT PARK

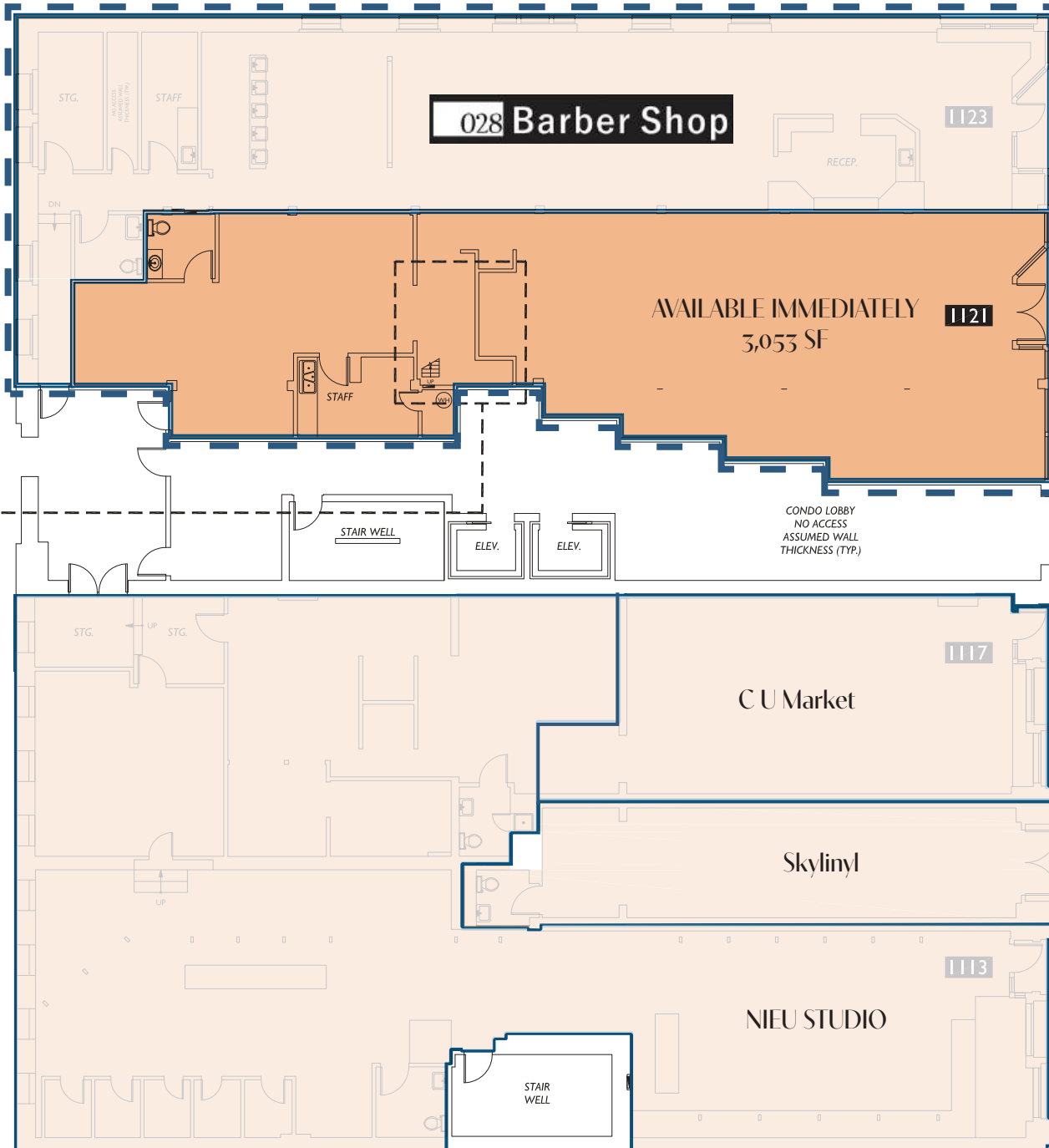

1ST AVENUE



## DETAILS

Suite 1121..... 3,053 SF  
 Rent..... Call For Rates  
 NNN's..... \$11.62 PSF

## REAL RETAIL

MARIA ROYER  
 206.619.0131 Cell  
 mroyer@real-retail.net

ERIC ZUEHLSDORFF  
 808.221.1134 Cell  
 eric@real-retail.net

This information supplied herein has been secured from sources believed to be reliable; however, no representations are made to its accuracy. Prospective tenants or buyers should consult their professional advisors and conduct their own independent investigation. Properties are subject to change in price and/or availability without notice.