

# FOR LEASE

645 NATIONAL AVE, MOUNTAIN VIEW, CA



## *A ±12,000 SF Storage/Warehouse Space*

25% office, balance warehouse

Warehouse fully sprinklered with 2 grade level doors

±1.67 per 1,000 parking

Great freeway access to 101 & 85

City of Mountain View warehouse description:  
A building or part of a building that is constructed or adapted for the storage of goods or merchandise, as distinguished from personal storage facilities.

Asking \$1.35 NNN (\$0.09 OPEX)

**JAMES VISO**  
408.970.9400  
james.viso@kidder.com  
LIC N° 01751851

**JOE SCUNCIO**  
408.588.2337  
joe.scuncio@kidder.com  
LIC N° 00861874

### **KIDDER.COM**

This information supplied herein is from sources we deem reliable. It is provided without any representation, warranty, or guarantee, expressed or implied as to its accuracy. Prospective Buyer or Tenant should conduct an independent investigation and verification of all matters deemed to be material, including, but not limited to, statements of income and expenses. Consult your attorney, accountant, or other professional advisor.



# FLOOR PLAN

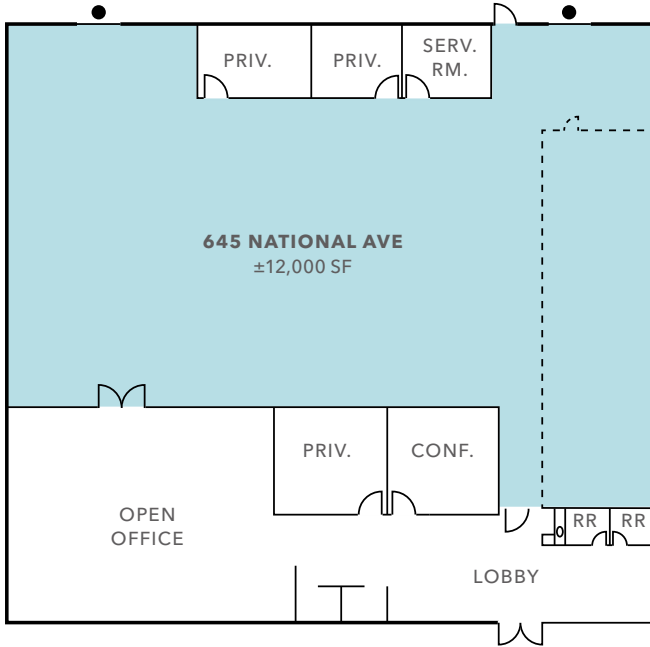

## LEGEND

- Warehouse
- Grade Level Door



[KIDDER.COM](http://KIDDER.COM)

This information supplied herein is from sources we deem reliable. It is provided without any representation, warranty, or guarantee, expressed or implied as to its accuracy. Prospective Buyer or Tenant should conduct an independent investigation and verification of all matters deemed to be material, including, but not limited to, statements of income and expenses. Consult your attorney, accountant, or other professional advisor.





KIDDER.COM

This information supplied herein is from sources we deem reliable. It is provided without any representation, warranty, or guarantee, expressed or implied as to its accuracy. Prospective Buyer or Tenant should conduct an independent investigation and verification of all matters deemed to be material, including, but not limited to, statements of income and expenses. Consult your attorney, accountant, or other professional advisor.