

120 W. MAIN STREET
MESA, AZ 85201

DOWNTOWN MESA



Caliber Mesa Properties



Caliber Properties



Local Landmarks



Upcoming Developments



Arizona Museum of
Natural History

University & Mesa
Development

I.D.E.A. Museum

ASU - Mesa City Center

Pioneer Park

48 W. Main

18 W. Main

Mesa City Hall

305 E. Main

Temple Area
Development

206 W. Main &
202 W. Main

114 W. Main &
120 W. Main

29 W. Main

Benedictine
University

The Grid

137 W. Main

Mesa Center for
the Arts

155 W. Main

Subject Property

Heritage Academy

LDS Mesa Arizona
Temple

120 W. MAIN

History

Originally built in 1910 as a former Worth's Dept. Store. Has open leasing for 120-B

Property

120-B dimensions:
3289 RSF



Amenities

Storefront property.
Upcoming renovations:
new roof.

New HVAC units.
Remodeled bathrooms
and new flooring.

120-B Floor Plan:

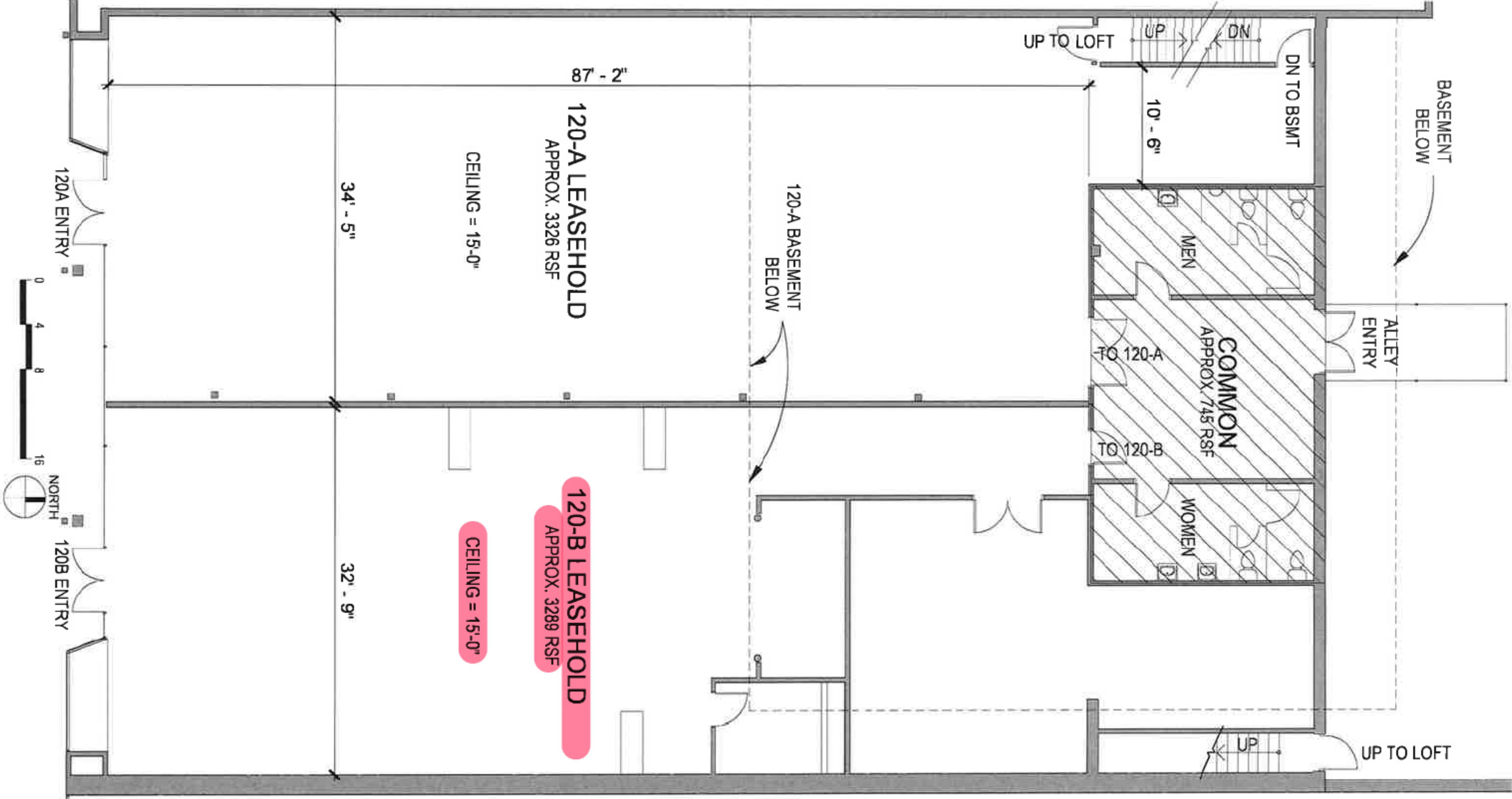

Additional Photos



**ADDITIONAL
PROPERTIES**



202 W. Main

Storefront Retail/
Residential



137 W. Main

Retail



206 W. Main

Retail

Arizona Museum of
Natural History



Downtown Mesa
Community



Mesa Convention Center

i.d.e.a Museum

Interactive Downtown Map Link:

http://www.scribblemaps.com/maps/view/Downtown_Mesa_Map/QsfyHHInZU

Population:

3 Miles 5 Miles

2018 Estimated Pop.	180,939	369,524
2023 Projected Pop.	194,016	394,709

Households:

3 Miles 5 Miles

2018 Est. Households	65,049	139,910
2023 Est. Households	69,648	149,322



500,000
people live in
Mesa, AZ



2ND
largest city in
the Phoenix-
Mesa metro area



3RD
largest city in
the state of
Arizona



New Light Rail
Three stations provide passengers
connectivity to high-quality housing,
employment, shops, restaurants,
and cultural attractions. Estimates of
9,230 weekly riders



1.8M
workforce
population within a
30 minute drive

Source: ESRI Analyst



Smart Location
for Intelligent Companies
Apple, Boeing, Infineon,
Bridgestone, Mitsubishi,
Textron, and Dexcom all have
significant operations in Mesa



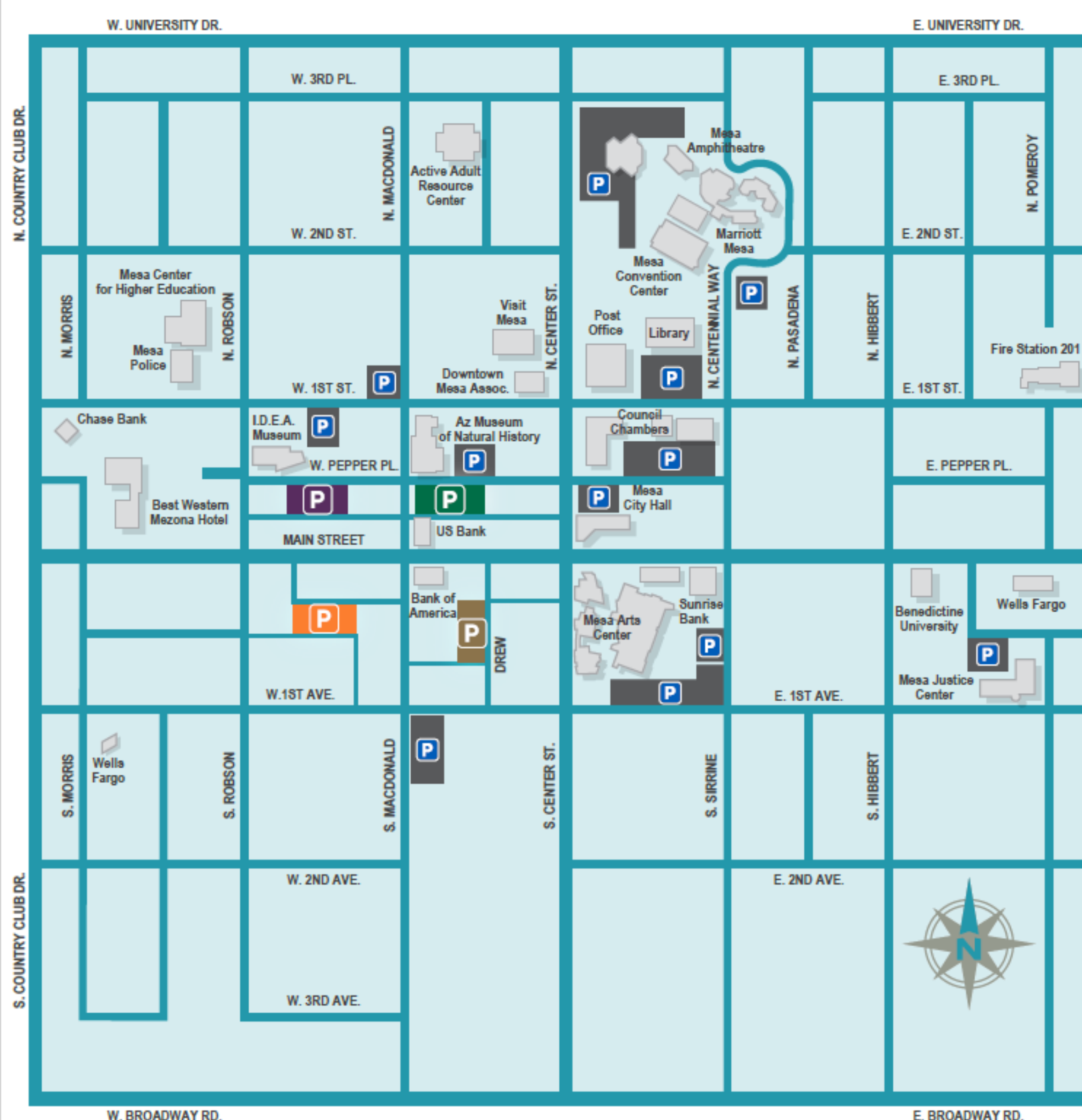

PARKING IS EASY IN DOWNTOWN MESA

Whether you're a first time visitor or a local resident who enjoys all that Downtown Mesa has to offer, we want to make your Downtown Mesa experience even better. This downtown map will help you locate where you can park for **FREE**. The map also provides information the businesses located near some of the more popular parking lots. Please know we're constantly working to make parking as easy and convenient as possible in Downtown Mesa.

Did you know that there are over 5,000 FREE parking spaces available in Downtown Mesa everyday?

- Purple Parking Lot
- Green Parking Lot
- Orange Parking Lot
- Gold Parking Lot
- Additional Parking

*Parking Garages are FREE daily after 5 PM and on the Weekends.

