

41,876 SF



## Prologis NW Corporate Park



3551 NW Yeon Avenue - Bldg 2  
Portland, OR 97210 USA

### LOCATION

- Guilds Lake / NW Industrial Area
- Ten (10) Buildings; 678,026 SF Park

### FACILITY

- Approximately 41,876 SF with 6,016 SF Office
- Five (5) Double-Wide Dock Doors
- Six (6) Single Dock Doors
- One (1) Grade Level Door
- Fully Sprinklered
- 400 Amps of Power
- 20' Clear Height

### ADVANTAGES AND AMENITIES

- Close-In NW Location
- Minutes to Downtown Portland
- Immediate Access to I-405 and I-5
- Park Amenities Include Food and Convenience Services
- Please Call Brokers for Current Rates

**Your single-source service for efficient move-in and operations: [prologisessentials.com](http://prologisessentials.com)**



# 41,876 SF



## Prologis NW Corporate Park

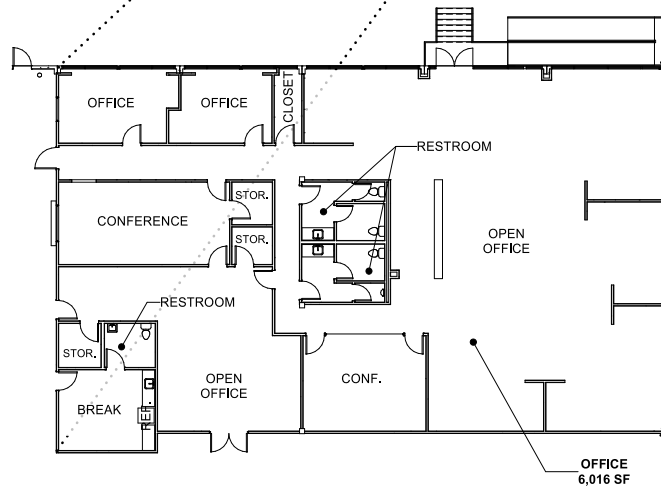
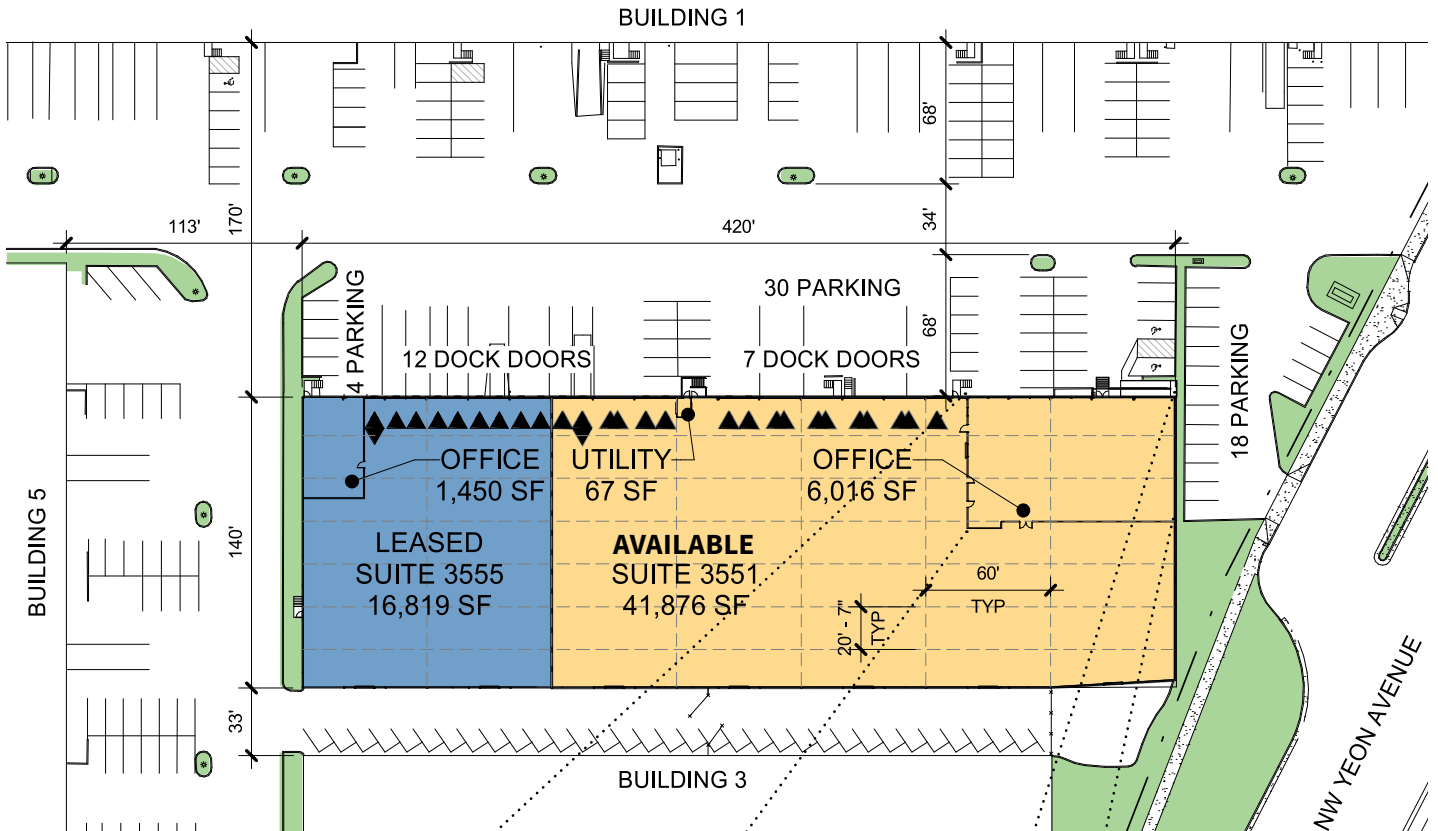

**Capacity Commercial Group**  
Scott Kappes, SIOR  
scottk@capacitycommercial.com  
ph +1 503 517 9877  
cell +1 503 816 4201  
805 SW Broadway Street,  
Suite 600,  
Portland, OR 97205 USA

**Capacity Commercial Group**  
Kenny Houser, SIOR  
kenny@capacitycommercial.com  
ph +1 503 517 9875  
cell +1 503 385 6080  
805 SW Broadway Street,  
Suite 600,  
Portland, OR 97205 USA

**Prologis**  
Sean Colletta  
scolletta@prologis.com  
ph +1 503 276 7375  
4380 SW Macadam Avenue,  
Suite 285,  
Portland, OR 97239 USA