

FIVE UNIT MULTIFAMILY PROPERTY

# 719 WEST MISSOURI AVENUE

FOR SALE

PHOENIX, ARIZONA 85013



**ETHAN ELLIOTT**  
SENIOR ASSOCIATE

M: (949) 584-0316  
ethan.elliott@orionprop.com

**ZACK MISHKIN**  
MANAGING DIRECTOR

M: (602) 363-6363  
zack.mishkin@orionprop.com



# TABLE OF CONTENTS



EXECUTIVE SUMMARY	•	3
PROPERTY OVERVIEW	•	4
PRO FORMA	•	5
PROPERTY PHOTOS	•	6
INTERIOR PHOTOS	•	7
AERIAL VIEWS	•	8
AREA OVERVIEW	•	9
DEMOGRAPHICS	•	10

## DISCLAIMER:

All materials and information received or derived from ORION Investment Real Estate its directors, officers, agents, advisors, affiliates and/or any third-party sources are provided without representation or warranty as to completeness, veracity, or accuracy, condition of the property, compliance, or lack of compliance with applicable governmental requirements, developability or suitability, financial performance of the property, projected financial performance of the property for any party's intended use or all other matters.

Materials and information from any source, whether written or verbal, that may be furnished for review are not a substitute for a party's active conduct of its own due diligence to determine these and other matters of significance to such party. ORION Investment Real Estate will not investigate or verify any such matters or conduct due diligence for a party unless otherwise agreed in writing.

*EACH PARTY SHALL CONDUCT ITS OWN INDEPENDENT INVESTIGATION AND DUE DILIGENCE.*





4.6 MILES AWAY



College of Medicine  
Phoenix



PHX AREA

CITYSCAPE

★ SUBJECT PROPERTY

North 7th Ave 24,426 VPD

West Missouri Ave 11,532 VPD

## EXECUTIVE SUMMARY

Missouri Avenue is located within Phoenix's Central Corridor — a premier infill submarket defined by the Central Avenue walking path, affluent demographics, and proximity to Downtown, Midtown, and Uptown. Investors seeking exposure to Phoenix while prioritizing an established, upscale, and walkable location consistently gravitate to this corridor, where limited land availability supports durable renter demand.

The property itself is a rare, boutique offering: effectively new construction despite its prior office use. The conversion delivered modern systems, Class A finishes, and separate metering, resulting in a clean, low-maintenance ownership profile. Missouri Avenue offers investors a newly delivered asset in a prime Central Corridor location — without the operational complexity or scale of a larger multifamily property.



# PROPERTY OVERVIEW

PARCEL NUMBER: 153-43-001A

SALE PRICE	\$1,400,000
SIZE (GBA):	3,560 SF
YEAR BUILT:	2022

## PROPERTY HIGHLIGHTS:

- ✓ **Office-to-Residential Conversion** — Thoughtfully redesigned from its former office use into modern residential units with updated systems and contemporary finishes.
- ✓ **Turnkey & Low Maintenance** — No deferred maintenance, new/updated mechanicals, and simple operations mean minimal management headaches.
- ✓ **Small Form Factor** — A rare opportunity to acquire essentially brand-new, turnkey multifamily at a bite-sized price point in a supply-constrained area.
- ✓ **Prime Central Location** — Minutes from the Biltmore District and Uptown’s popular restaurant and retail corridors along 7th Street and Central.
- ✓ **Strong Resident Appeal** — Modern interiors, in-unit laundry, and boutique scale support steady demand and durable rents.

UNIT MIX	UNITS	AVG SF
Studio	3	400
1 Bed/1 Bath	1	728
2 Bed/1 Bath	1	955
Totals	5	



RENTAL INCOME		EXPENSES	
Unit 1 (2bd)	\$1,650.00	Water/Sewer/Trash (Per Unit)	\$6,000.00 (\$100/unit/mo)
Unit 2 (1bd)	\$1,100.00	Community Electric	\$360.00 (\$30/mo)
Unit 3 (Studio)	\$1,550.00	2025 Property Tax	\$7,196.60
Unit 4 (Studio)	\$1,615.00	Contract Services	\$100.00
Unit 5 (1bd)	\$1,550.00	Insurance	\$2,000.00 (\$400/unit/yr)
Monthly Gross	\$7,465.00	Property Management (5% of Net Effective Rent)	\$4,255.05
Annual Gross	\$89,580.00	Repairs & Maintenance	\$3,750.00 (\$750/unit/yr)
Vacancy Loss (5%)	\$4,479.00	Total Expenses	\$23,661.65
Net Effective Income	\$85,101.00		
		NOI	\$61,439.35





# EXTERIOR PHOTOS



# INTERIOR PHOTOS





# AERIAL VIEWS

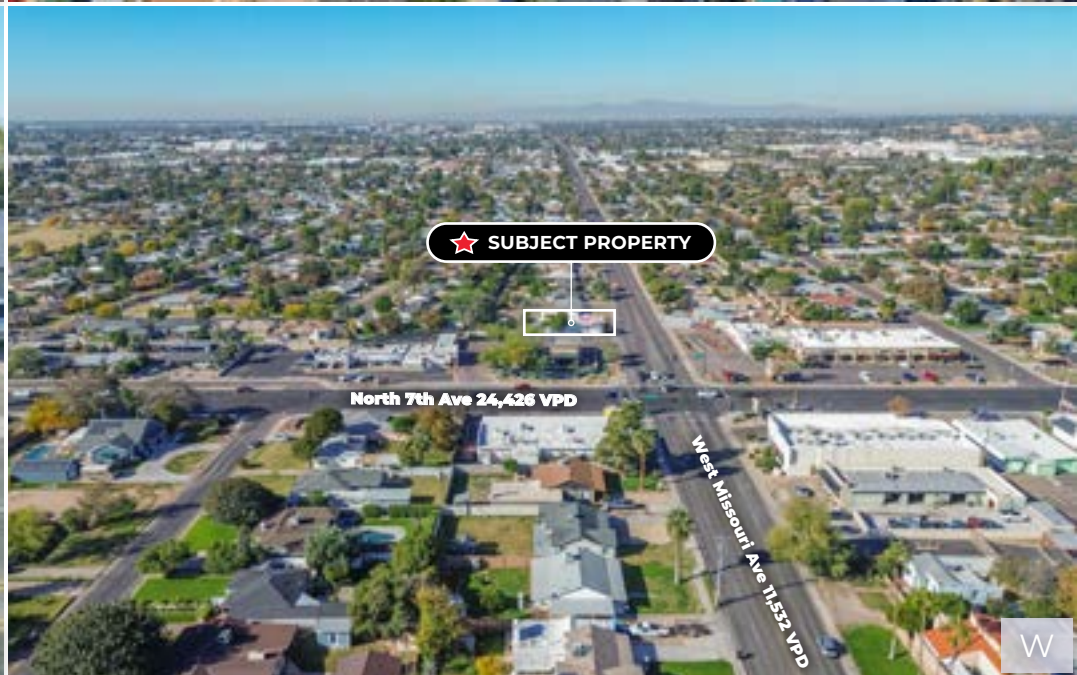
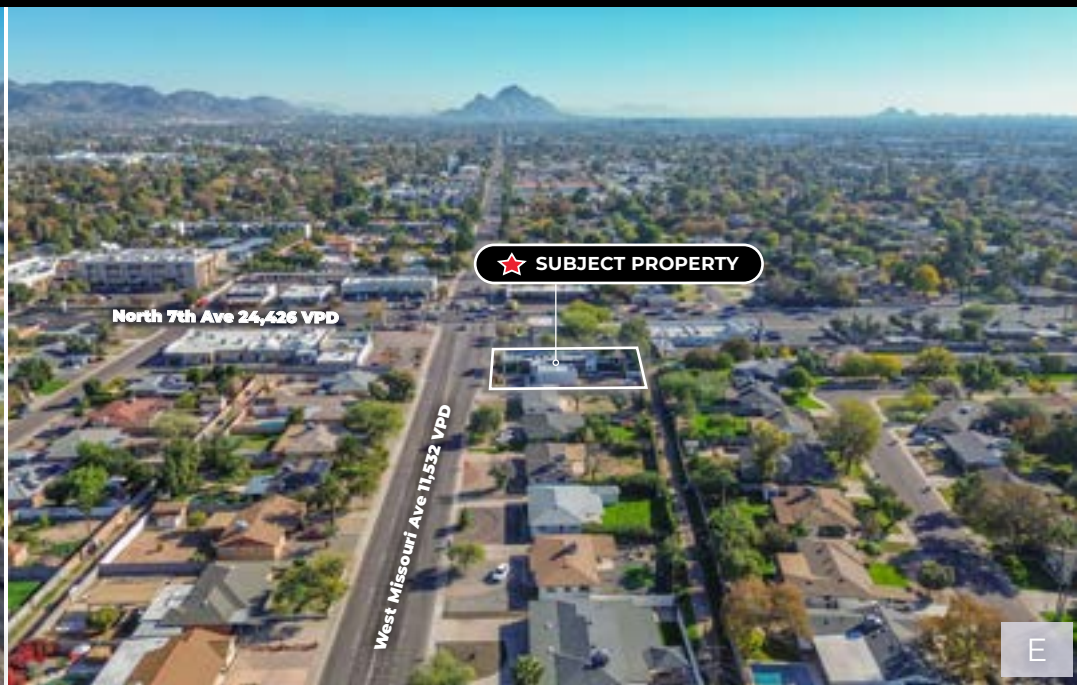
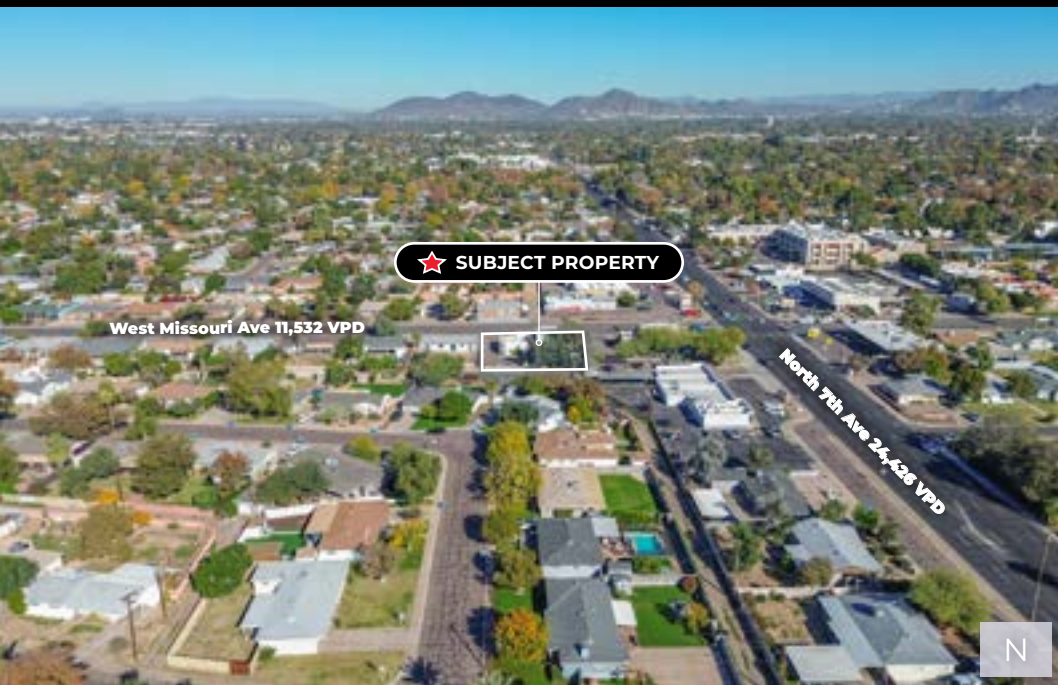



# AREA OVERVIEW

ONE OF PHOENIX'S MOST DESIRABLE AREAS

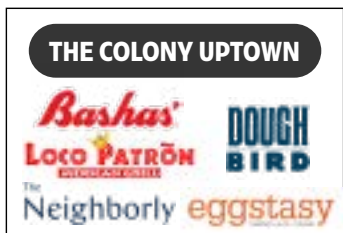
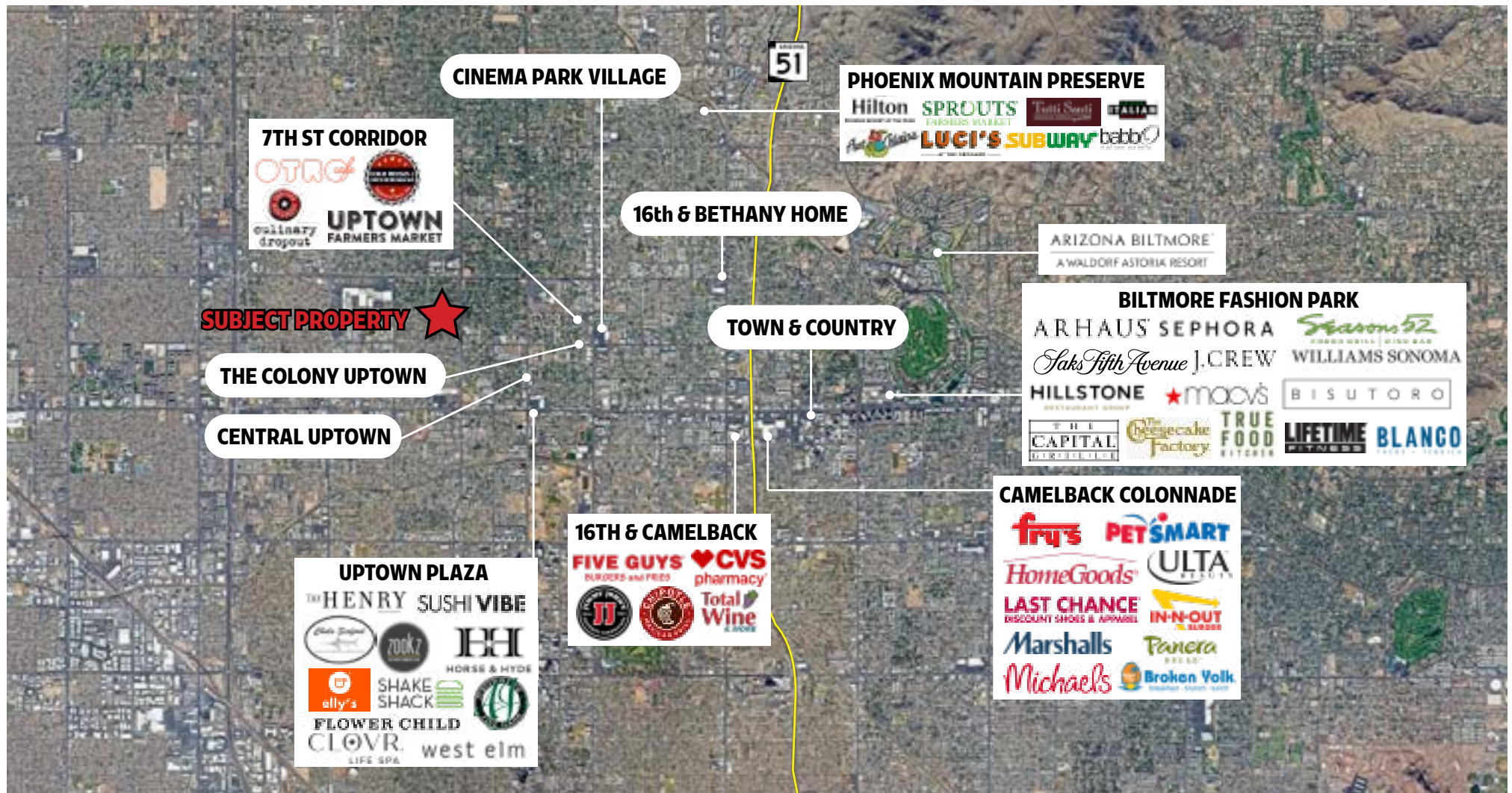



# PHOENIX, ARIZONA

Phoenix is one of the fastest-growing metropolitan areas in the country, driven by a strong labor market, diverse industries, and a steadily expanding population. The city offers an attractive business environment with affordable operating costs, a skilled workforce, and major transportation infrastructure connecting the region to national and international markets. Known for its year-round sunshine, quality of life, and broad mix of residential, retail, and employment centers, Phoenix continues to draw new residents and companies alike. Its balanced economic growth, rising consumer demand, and ongoing development activity position the city as a leading hub in the Southwest for business, innovation, and long-term investment.



5 MILE DAYTIME POPULATION

**730,816**



1 MILE AVG HOUSEHOLD INCOME

**\$115,166**

## 2025 DEMOGRAPHICS (Sites USA)

POPULATION:	1- MILE	3-MILE	5-MILE
Daytime:	<b>26,897</b>	<b>297,944</b>	<b>730,816</b>
Employees:	<b>7,532</b>	<b>103,694</b>	<b>271,111</b>
HOUSEHOLDS:	1-MILE	3-MILE	5-MILE
Total:	<b>9,158</b>	<b>82,898</b>	<b>188,921</b>
Average Size:	<b>2.1</b>	<b>2.2</b>	<b>2.3</b>
INCOME:	1-MILE	3-MILE	5-MILE
Average Household Income:	<b>\$115,166</b>	<b>\$110,145</b>	<b>\$105,657</b>
Annual Household Expenditure:	<b>\$926.11 M</b>	<b>\$8.22 B</b>	<b>\$18.52 B</b>







**ORION Investment Real Estate**

7150 East Camelback Road, Suite 425  
Scottsdale, Arizona 85251

ORION Investment Real Estate is an investment sales brokerage specializing in commercial real estate throughout the Southwestern United States. Since its founding in 2009, ORION has completed over \$1 billion in transactions by combining deep market expertise with a focused, execution-driven approach. The firm is known for thoughtful positioning, disciplined marketing, and advising clients through complex transactions with clarity and purpose — helping investors grow and optimize portfolios, build long-term wealth, and make informed decisions at the right points in the market.

FOR MORE INFORMATION:



**ETHAN ELLIOTT**

SENIOR ASSOCIATE

M: (949) 584-0316  
ethan.elliott@orionprop.com



**ZACK MISHKIN**

MANAGING DIRECTOR

M: (602) 363-6363  
zack.mishkin@orionprop.com

719 WEST MISSOURI AVENUE - PHOENIX, ARIZONA 85013

# 5 UNIT MULTIFAMILY PROPERTY FOR SALE

