



# 360 MERRICK ROAD | LYNBROOK, NEW YORK



## PROPERTY OVERVIEW

- Located on Merrick Road and Peninsula Boulevard, just off Sunrise Highway (NY State Route 27), in the heart of the village of Lynbrook, Nassau County, New York
- The property is 1.71 acres and has over 400' of frontage on Merrick Road
- The property can accommodate up to 120 parking spaces

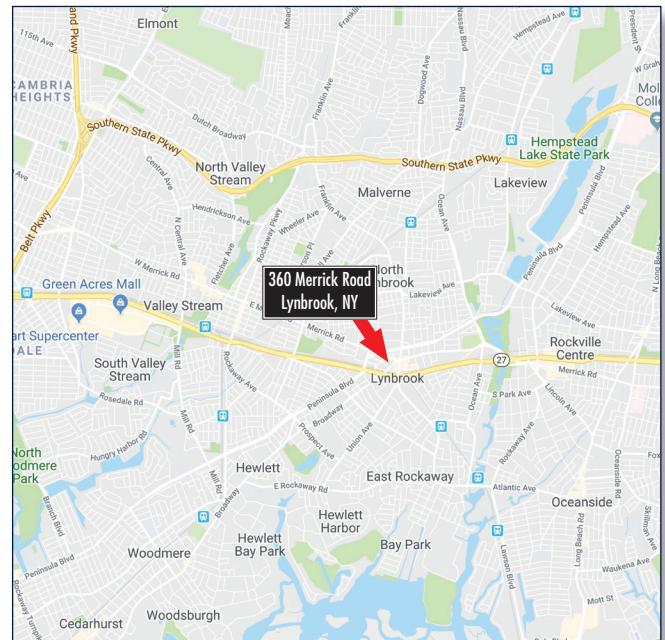

DEMOGRAPHICS	1 MILE	3 MILE	5 MILE
Population	29,899	214,350	615,498
Average HH Income	\$121,167	\$140,224	\$127,931
Total HH	11,393	74,059	199,952
Median Age	42.5	41.6	39.6

**CONTACT: Andrew Aberham** | T: 212-951-3833 | F: 212-545-1355 | [aaberham@pihc.com](mailto:aaberham@pihc.com)





# 360 MERRICK ROAD | LYNBROOK, NEW YORK

## GROUND FLOOR RETAIL

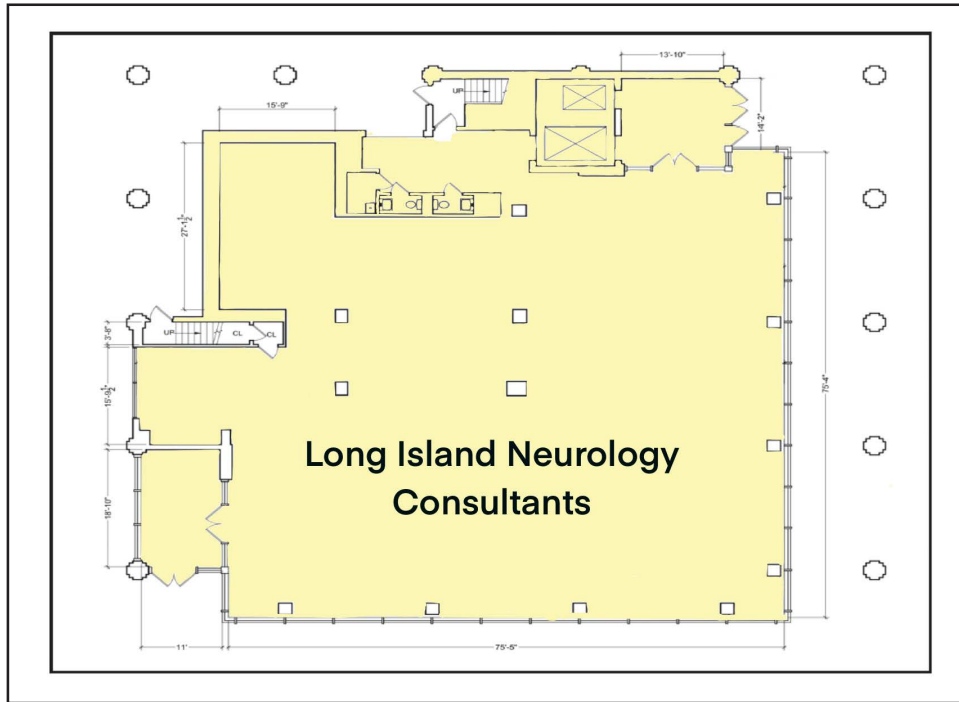

### 2nd Floor

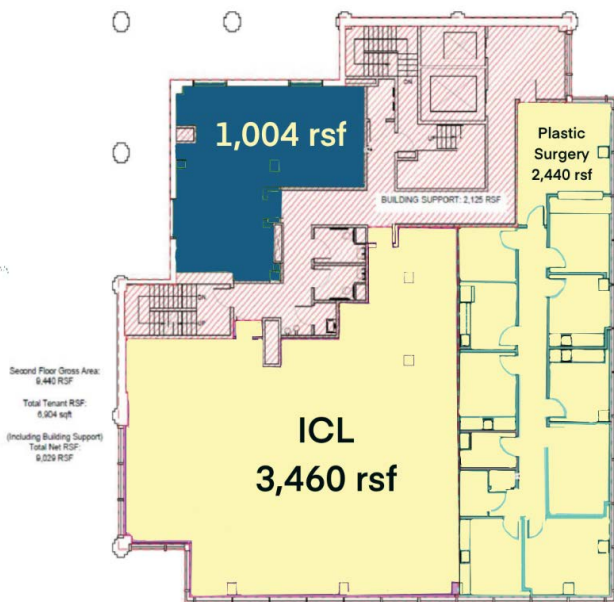

### 3rd Floor

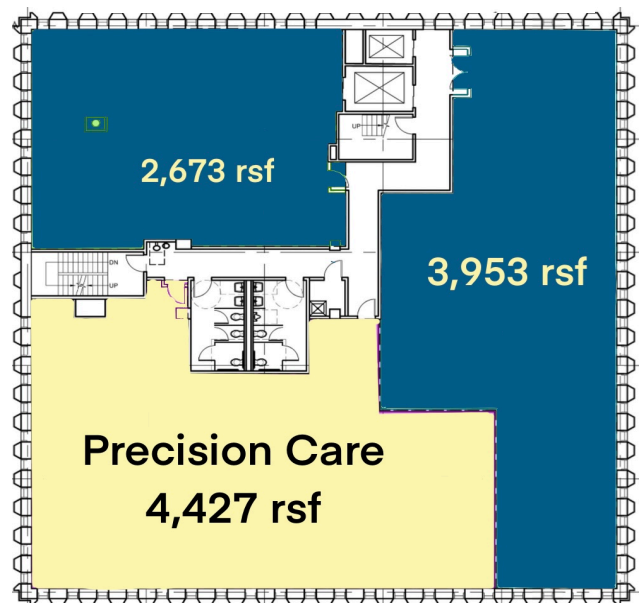

**CONTACT: Andrew Aberham** | T: 212-951-3833 | F: 212-545-1355 | aaberham@pihc.com

All areas and dimensions are approximate. This plan is intended for identification purposes only and is not to be deemed a representation by Landlord as to the accuracy or square footage.

