

# For Lease

**202 Commerce Drive, Suite 7-8  
Moorestown, NJ 08057**



**12,800 SF  
Industrial Space**



**The  
Flynn  
Company**

**DAVID M. RICCI  
DRICCI@FLYNNCO.COM  
215-561-6565 x 154**

**BRANDO CASALICCHIO  
BCASALICCHIO@FLYNNCO.COM  
215-561-6565 x 153**

*No warranty or representation, expressed or implied, is made as to the accuracy of the information contained herein, and same is submitted subject to error and omissions.*



# For Lease

**202 Commerce Drive, Suite 7-8  
Moorestown, NJ 08057**



## PROPERTY HIGHLIGHTS



**Total SF:** 12,800 SF



**Office SF:** 2,560 SF



**Loading:** 3 tailgate doors, 1 drive-in door



**Parking:** 59 Total Parking Spots  
(1.16 spots / 1,000 SF)



**Clear Height:** 21' clear



**Power:** Two services, 100 amps, 480v, 3 phase



## LOCATION

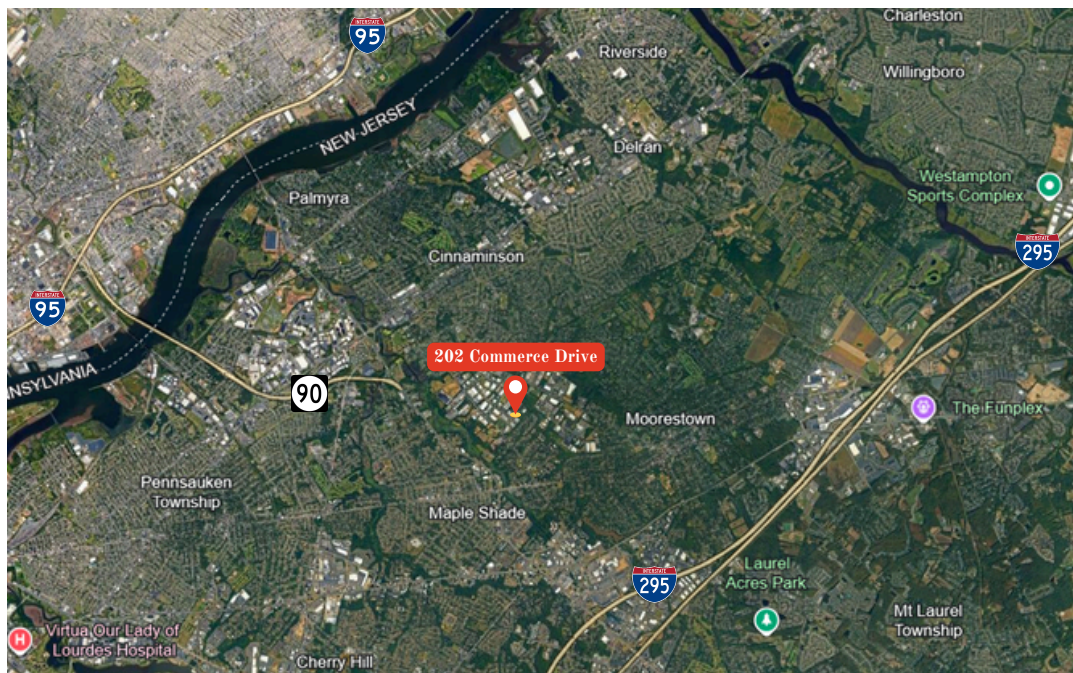

- Situated in Moorestown West Corporate Center, a 133 acre, 5,000,000 SF professional campus with over 100 buildings
- Located off North Church Street in Moorestown, NJ with easy access to I-295, the NJ Turnpike, the Betsy Ross and Tacony Bridge and Routes 38, 73, 90 and 130
- Minutes to Center City Philadelphia and its airports

*No warranty or representation, expressed or implied, is made as to the accuracy of the information contained herein, and same is submitted subject to error and omissions.*

# For Lease

202 Commerce Drive, Suite 7-8  
Moorestown, NJ 08057



## FLOOR PLAN

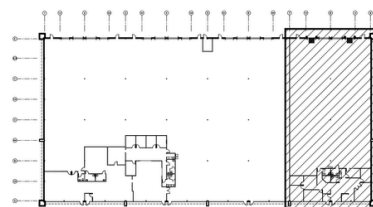
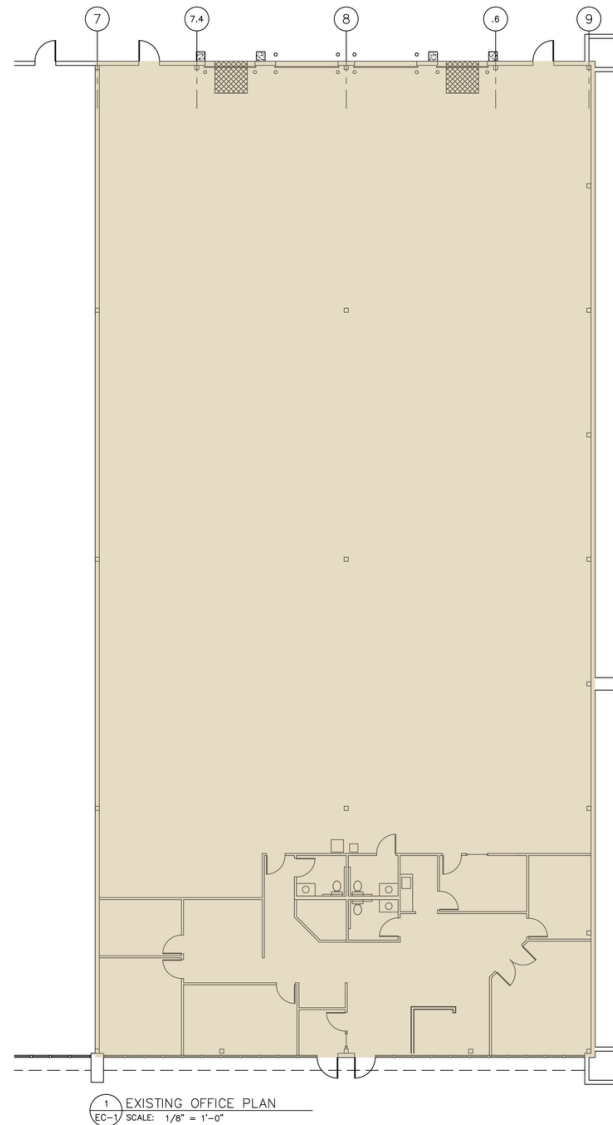

No warranty or representation, expressed or implied, is made as to the accuracy of the information contained herein, and same is submitted subject to error and omissions.