



PRICE REDUCTION

FOR SALE

WEST BERKELEY LIGHT INDUSTRIAL CONDO

Own your destiny!

PROPERTY HIGHLIGHTS

- Newly condo'ed, one of two units
- Currently divided in two spaces
- Concrete tilt-up construction
- ADA restroom
- Stainless steel sink
- ±15' Ceilings
- Two Level-in Roll ups
- 200amp/3-pole/240v
- Skylights
- Storage

LOCATION

1210 Tenth St.
At Gilman

OFFERED AT

~~\$2,050,000~~
\$1,950,00

SIZE

±5,000 sq. ft.

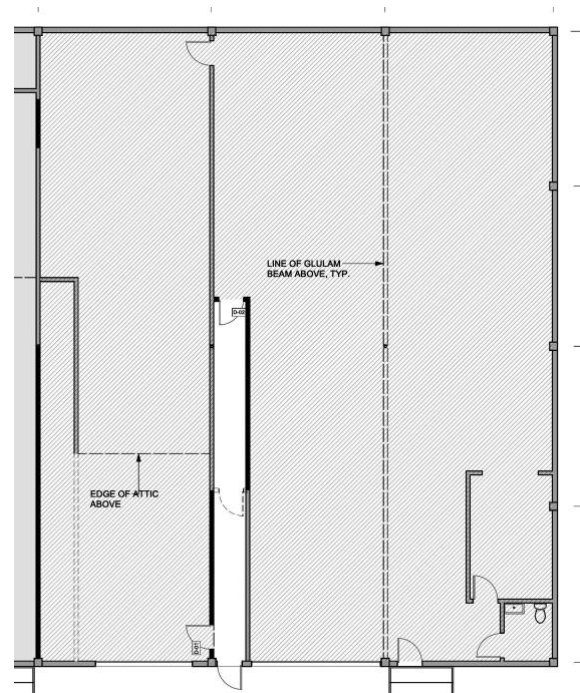

**NORHEIM
& YOST**

732 Addison Street
Suite "C"
Berkeley, CA 94710

Steve Smith

BRE# 01330154

ss@noryost.com

510-527-3400 x12

John Norheim

BRE # 00770171

jn@noryost.com

510-527-3400 x10

All information furnished herein was provided by sources deemed reliable, but no representation is made or implied as to the accuracy thereof.

PROPERTY HIGHLIGHTS

