

195 TAMAL VISTA
CORTE MADERA



LEASING : ANNIE PRUPAS - ANNIE@RETAILWESTINC.COM & JESSICA BIRMINGHAM - JESSICA@RETAILWESTINC.COM

retailwest

SMALL SPACE. BIG OPPORTUNITY.

TAMAL VISTA BLVD 4,707 ADT

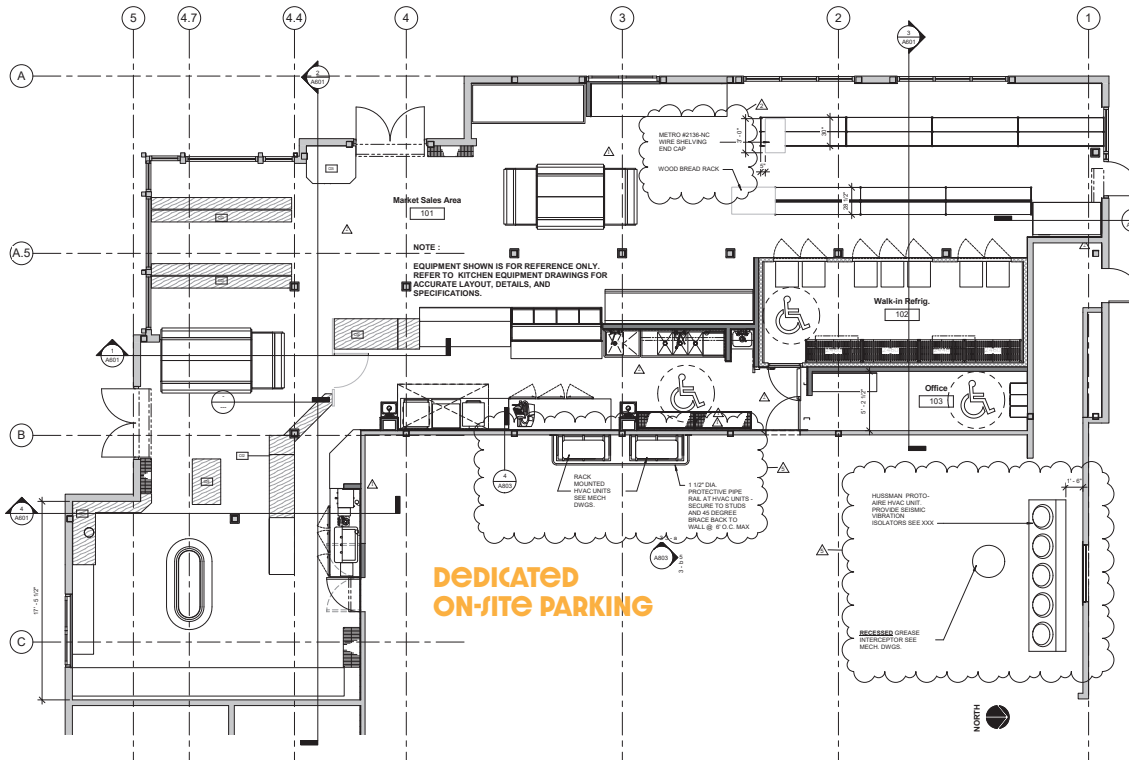

**DEDICATED
ON-SITE PARKING**

*former Andy's Market plan

WORNUM DR 3,797 ADT



2ND GEN FOOD
OPEN TO OTHER USES



DEDICATED ON-SITE
PARKING



3,134 SF



SAN FRANCISCO

BELVEDERE/TIBURON

MILL VALLEY

TOWN CENTER
CORTE MADERA

- SAFEWAY
- Crate&Barrel
- PAPER SOURCE
- REI COOP
- Bay Club
- SEPHORA
- ATHLETA

THE VILLAGE AT
CORTE MADERA

- RH
- macy's
- WILLIAMS SONOMA
- ANTHROPOLOGIE
- POTTERY BARN
- NORDSTROM

COST PLUS PLAZA

- TRADER JOE'S
- WORLD MARKET
- BevMo!

CORTE MADERA MARKETPLACE

- Total Wine
- GREEN MARKET
- BODYROCK
- NOW power yoga

CORTE MADERA

US 101

HWY 101 - 168,000 ADT

REDWOOD HIGH
1,857 ENROLLMENT

LEASING : ANNIE PRUPAS - ANNIE@RETAILWESTINC.COM & JESSICA BIRMINGHAM - JESSICA@RETAILWESTINC.COM

This information has been secured from sources we believe to be reliable, but we make no representations, or warranties, express or implied, as to the accuracy of the information. Listing broker has been given enough information to provide only preliminary due diligence on the property. The materials are not to be considered fact. The information contained herein is not a substitute for a thorough due diligence investigation. Information to be verified by an interested party, and their advisors and consultants. By receiving these materials you are agreeing to the disclaimers set forth herein. DRE# 01445169