



SUN RAY SHOPPING CENTER

Retail For SubLease | St. Paul, MN

JANET OLSON | 612-359-1681 | janet.olson@transwestern.com

SUN RAY SHOPPING CENTER

SUBLEASE OVERVIEW



TRANSWESTERN



SITE INFORMATION

Location: 2197 Old Hudson Road | St. Paul, MN
Description: Cub Foods anchored Shopping Center
Center GLA: 215,855 SF
Parking: Surface Lot



AVAILABILITY

Sublease: 14,242 SF Endcap
Can be demised to 3,000 SF



TRAFFIC COUNTS

Interstate 94: 81,516 VPD
N McKnight Road: 20,200 VPD



DEMOGRAPHICS

	1 Mile	3 Mile	5 Mile
Population	13,576	103,943	264,972
Daytime Population	17,133	94,530	284,509
Median HH Income	\$54,059	\$58,228	\$62,853
Average HH Income	\$67,003	\$73,945	\$82,408



CENTER TENANTS



FOR INFORMATION CONTACT:

JANET OLSON | 612-359-1681
janet.olson@transwestern.com

The information provided herein was obtained from sources believed reliable; however, Transwestern makes no guarantees, warranties or representations as to the completeness of accuracy thereof. The presentation of this property is submitted subject to errors, omissions, change of price or conditions, prior to sale or lease, or withdrawal without notice. Copyright © 2020 Transwestern.

AERIAL



FOR MORE INFO CONTACT: 
JANET OLSON | 612-359-1681 | janet.olson@transwestern.com

PLAN

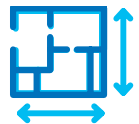

AVAILABILITY

Sublease: 14,242 SF

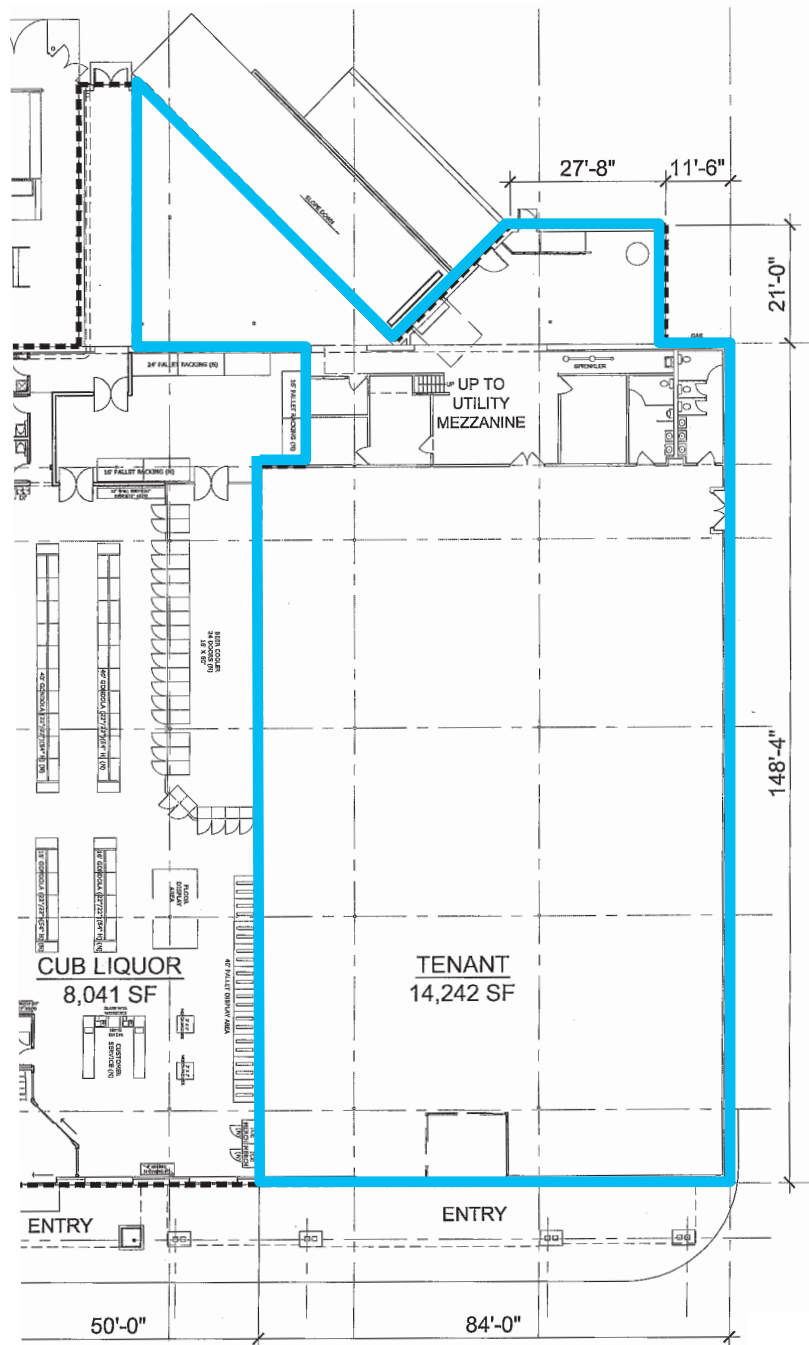

TRANSWESTERN

FOR MORE INFO CONTACT:

JANET OLSON | 612-359-1681 | janet.olson@transwestern.com



FOR MORE INFO CONTACT:

JANET OLSON | 612-359-1681 | janet.olson@transwestern.com