



FOR SALE

+/- 9.320 Acres

3602 Wesley Chapel Stouts Rd
Monroe, NC 28110

Dennis Moser, MAI
President



O: 704-882-1700 x 2

M: 704-201-6333

dmoser@themosergroupinc.com

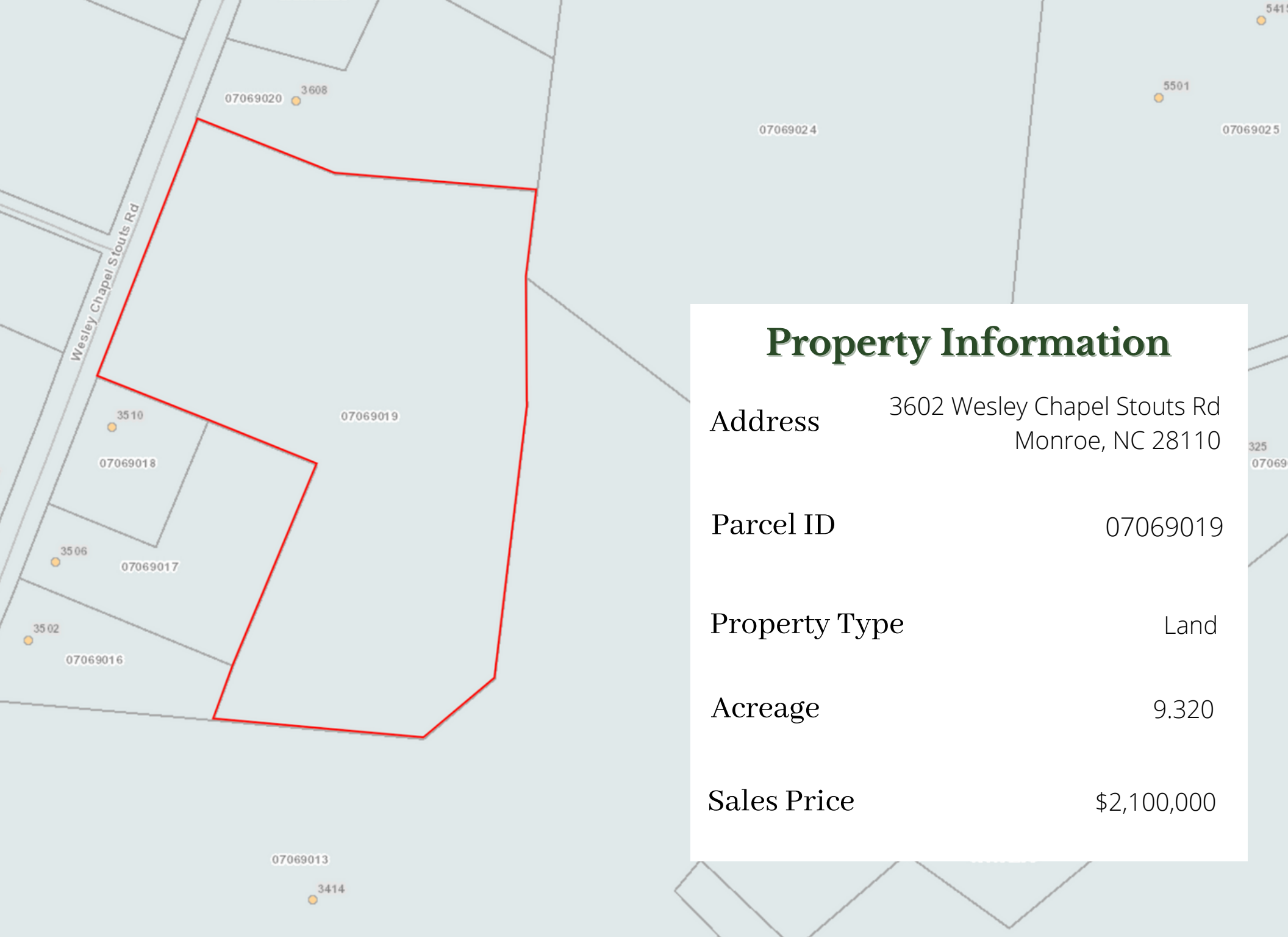

Property Information

Address	3602 Wesley Chapel Stouts Rd Monroe, NC 28110
Parcel ID	07069019
Property Type	Land
Acreage	9.320
Sales Price	\$2,100,000

Property Highlights

Excellent Location on US Highway 74 and Wesley Chapel-Stouts Road for Retail, Medical, Multi-Family, and Office Warehouse

Water & Sewer on Site- One Hookup

High Traffic Counts; Great Visibility in the Heart of Union County, NC

\$2,100,000

Asking Price

