

137 & 139 N Marina St

137 & 139 N Marina St, Prescott, AZ, 86301

Historic Building & Land

F O R S A L E



Matthew Fish

Direct Phone: (480) 309-1089

Email: matt@prescottcre.com



PRESCOTT COMMERCIAL
REAL ESTATE

List Price:	\$ 1,050,000
Subdivision Name	Prescott Original Townsite
County	Yavapai
Lot Size	0.50 AC
Total Size	3,644 SF
Submarket:	Downton Prescott
Flood Zone	X
Legal Description	PRESCOTT LESS N 7.22 OF LOT 6 AP6; ALL OF LOT 8 BLK 10
Zoning:	BG



HIGHLIGHTS

- **The church property is readily accessible to some of the highest density vehicle traffic in the Prescott area (25k-45k VPD).**
- **Buildings in this neighborhood might serve tenants or owners who desire to be close to the downtown Courthouse Square.**
- **Retail or mixed use might serve tenants desirous of synergy with downtown events and retail activities.**







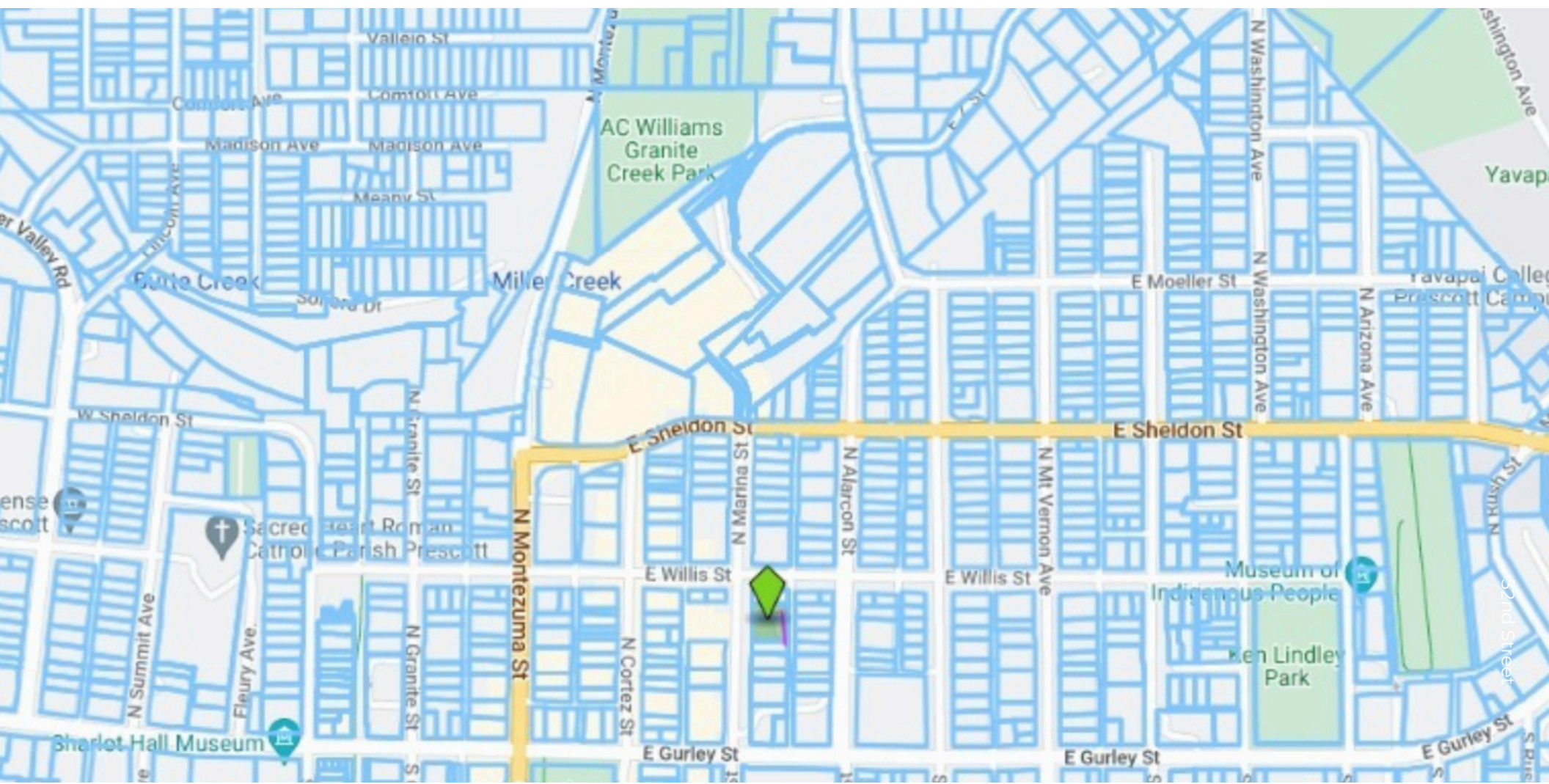

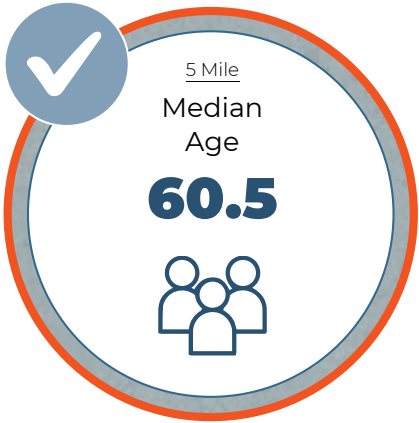

Age

60.5

Median age

about 10 percent higher than the figure in the Prescott Valley-Prescott, AZ Metro Area: 54.5

about 1.5 times the figure in Arizona: 38.4

Income

\$46,076 ±\$3,793

Per capita income

about 25 percent higher than the amount in the Prescott Valley-Prescott, AZ Metro Area: \$37,666 ±\$955

about 20 percent higher than the amount in Arizona: \$38,334 ±\$204

Households

21,803 ±656

Number of households

the Prescott Valley-Prescott, AZ Metro Area: 106,542 ±949

Arizona: 2,739,136 ±5,481

Transportation to work

15.7 minutes

Mean travel time to work

about two-thirds of the figure in the Prescott Valley-Prescott, AZ Metro Area: 23.7

about three-fifths of the figure in Arizona: 25.6

Population by age range

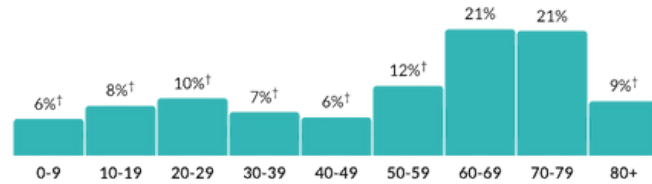

Show data / Embed

Population by age category

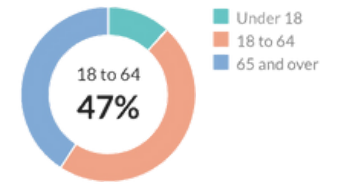

Show data / Embed

\$66,330

Median household income

a little higher than the amount in the Prescott Valley-Prescott, AZ Metro Area: \$62,430

about 90 percent of the amount in Arizona: \$72,581

Household income

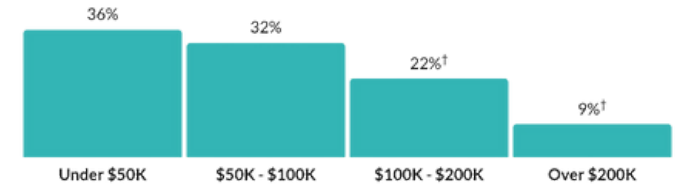

Show data / Embed

2

Persons per household

about 90 percent of the figure in the Prescott Valley-Prescott, AZ Metro Area: 2.2

about 80 percent of the figure in Arizona: 2.6

Population by household type

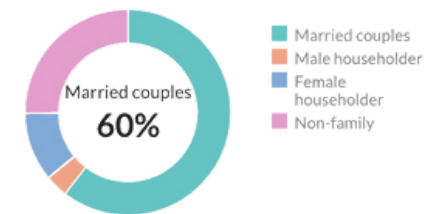

Show data / Embed

Means of transportation to work

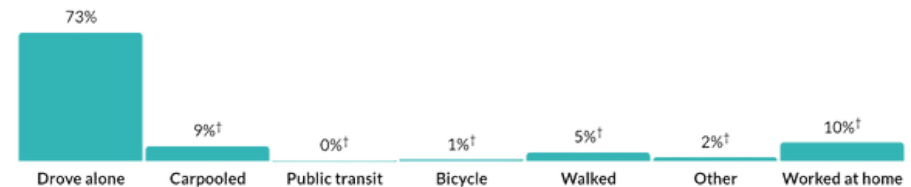

* Universe: Workers 16 years and over

Show data / Embed