

INDUSTRIAL BUILDING FOR LEASE



DAVID FRITCH

Broker

509.438.6260

david.fritch@kiemlehagood.com

**KIEMLE
HAGOOD**

KIEMLE HAGOOD
7025 W Grandridge Blvd
SUITE B-2
Kennewick, WA 99336



**PRICE REDUCED TO
\$9,000 / MONTH!**

**120 W RAILROAD DRIVE
KENNEWICK, WA 99336**

PROPERTY INFORMATION

INDUSTRIAL BUILDING FOR LEASE

120 W Railroad Drive
Kennewick, WA 99336

Industrial property located in the heart of Kennewick, Washington, featuring two industrial buildings perfect for a variety of business needs. This prime location offers easy access to major highways, ensuring optimal connectivity for logistics and operation. This property offers a fenced area for industrial outdoor storage & a truck height loading dock.

LEASE DETAILS

Lease Rate:	\$7.11 PSF/YR \$9,000 / Mo
Total Building Size:	±15,200 SF
Building 1:	±10,000 SF
Office:	±3,300 SF
Warehouse:	±6,700 SF
Building 2:	±5,200 SF
Lot Size:	±50,965 SF
Zoning:	Industrial
Property Configuration:	Single-Tenant
Year Built:	1955

TRAFFIC COUNTS

W Columbia Drive	±20,653 ADT
N Washington Street	±10,234 ADT



PROPERTY PHOTOS

INDUSTRIAL BUILDING FOR LEASE
120 W Railroad Drive | Kennewick, WA 99336

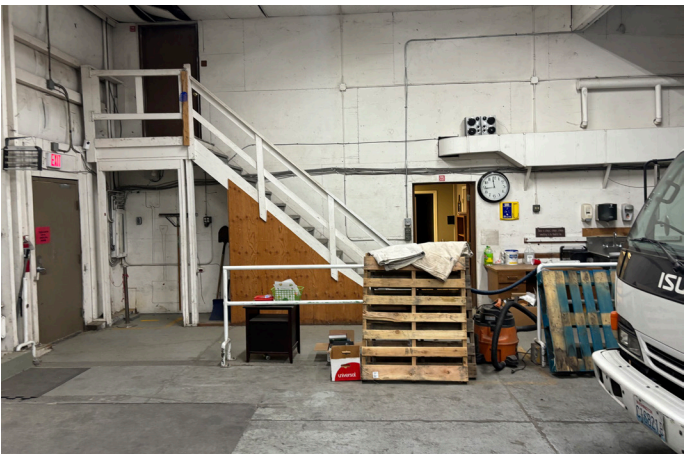
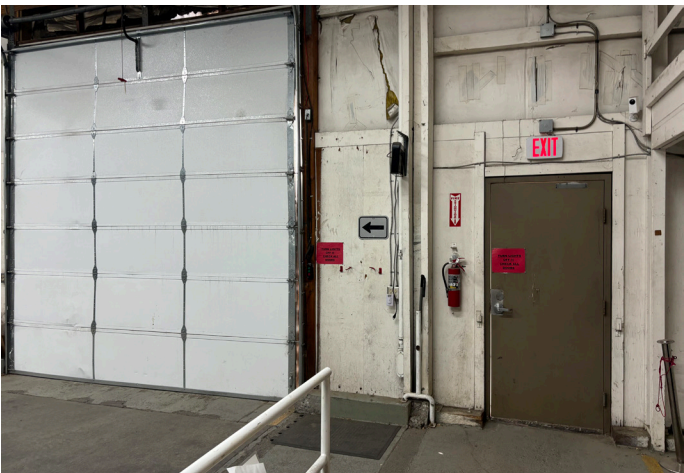
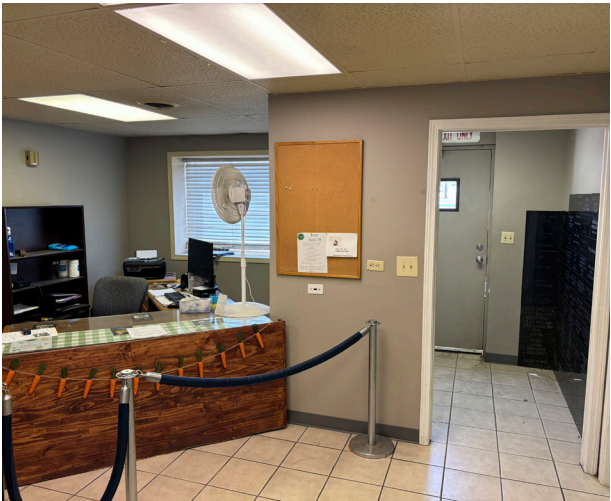

SURROUNDING AREA

INDUSTRIAL BUILDING FOR LEASE
 120 W Railroad Drive | Kennewick, WA 99336



SITE → ★

DEMOGRAPHICS	1 MILE	3 MILES	5 MILES
Est Population 2024	10,298	83,659	142,241
Proj Population 2029	10,497	86,434	147,168
Growth 2024-2029	0.4 %	0.7 %	0.7 %
Average HHI	\$62,109	\$86,727	\$101,962
Median HHI	\$51,081	\$68,174	\$80,364
Daytime Demos	8,646	51,794	87,790

INDUSTRIAL BUILDING FOR LEASE

120 W Railroad Drive
Kennewick, WA 99336

DAVID FRITCH

Broker

509.438.6260

david.fritch@kiemlehagood.com

KIEMLE HAGOOD

7025 W Grandridge Blvd, SUITE B-2
Kennewick, WA 99336

KIEMLEHAGOOD 
REALTOR

No warranty or representation, expressed or implied, is made by Kiemle Hagood, its agents or its employees as to the accuracy of the information contained herein. All information furnished is from sources deemed reliable and submitted subject to errors, omissions, change of terms and conditions, prior sale, lease or financing, or withdrawal without notice. No one should rely solely on the above information, but instead should conduct their own investigation to independently satisfy themselves.



Kiemle Hagood respects the intellectual property of others:

If you believe the copyright in your work has been violated through this Website, please contact our office for notice of claims of copyright infringement. For your complaint to be valid under the Digital Millennium Copyright Act of 1998 (DMCA), you must provide the following information when providing notice of the claimed copyright infringement: Identify the material on the Website that you believe infringes your work, with enough detail so that we may locate it on the Website; provide your address, telephone number and email address; provide a statement that you have a good faith belief that the disputed use is not authorized by the copyright owner, its agent, or the law; provide a statement that the information in the notification is accurate, and under penalty of perjury, that the complaining party is authorized to act on behalf of the owner of an exclusive right that is allegedly infringed; and provide your physical or electronic signature. Upon receiving your complaint, Kiemle Hagood will, upon review, remove content that you believe infringes your copyright if the complaint is found to be valid.