

# RELIGIOUS SPACE FOR LEASE

1516 EAST 1ST STREET | LOS ANGELES, CA



## PROPERTY HIGHLIGHTS

The property lies just .10 miles off of the 101 and only .5 miles to the west of I-10.

- Centrally located in the Aliso Village neighborhood of Los Angeles, to the east of the Arts District.
- Modern Facility
- Ample Space for Children’s Ministry

Tenant would have exclusive access to a portion of the building, while other spaces would be shared with the church based on hours of use. Owner is open to lease proposals from non-profits, educational users, and other religious organizations.

## PROPERTY DETAILS

ADDRESS	1516 East 1st Street Los Angeles, CA 90033
APPROX. SF FOR LEASE	5,500±
ROOMS	Sanctuary seats ±150, nursery, and large room for children
PARKING	On-site parking
COUNTY	Los Angeles
PARCEL ID	5172-004-021

Notes: Do not disturb owners, contact broker to discuss intended use before scheduling a tour. Owner is a non-profit 501 (c3) and exempt from property taxes. For-profit entities seeking to occupy may be assessed additional property taxes. Square footage is estimated, tenant to confirm at its own cost and discretion.

FOR MORE INFORMATION, PLEASE CONTACT:

**ETHAN REED | 949.525.6397**  
Associate Broker  
Ethan.Reed@foundrycommercial.com  
Licensed Real Estate Broker

**CHARLIE HOWARTH | 949.542.9484**  
Vice President  
Charlie.Howarth@foundrycommercial.com  
Licensed Real Estate Broker

**FOUNDRY**  
COMMERCIAL

MISSION  
PROPERTY  
GROUP

Although all information furnished regarding for sale, rental or financing is from sources we deem reliable, such information has not been verified and no express representation is made nor is any to be implied as to the accuracy thereof, and it is submitted subject to errors, omissions, changes of price, rental or other conditions, prior sale, lease or financing, or withdrawal without notice. All sizes are approximate and subject to survey.

[foundrycommercial.com](http://foundrycommercial.com)

PHOTOS



SANCTUARY FROM BACK



SANCTUARY FROM FRONT



LOBBY



YOUTH ROOM



NURSERY



PARKING

FOR MORE INFORMATION, PLEASE CONTACT:

**ETHAN REED | 949.525.6397**  
Associate Broker  
Ethan.Reed@foundrycommercial.com  
Licensed Real Estate Broker

**CHARLIE HOWARTH | 949.542.9484**  
Vice President  
Charlie.Howarth@foundrycommercial.com  
Licensed Real Estate Broker

**FOUNDRY**  
COMMERCIAL

MISSION  
PROPERTY  
GROUP

Although all information furnished regarding for sale, rental or financing is from sources we deem reliable, such information has not been verified and no express representation is made nor is any to be implied as to the accuracy thereof, and it is submitted subject to errors, omissions, changes of price, rental or other conditions, prior sale, lease or financing, or withdrawal without notice. All sizes are approximate and subject to survey.

[foundrycommercial.com](http://foundrycommercial.com)

## LAYOUT

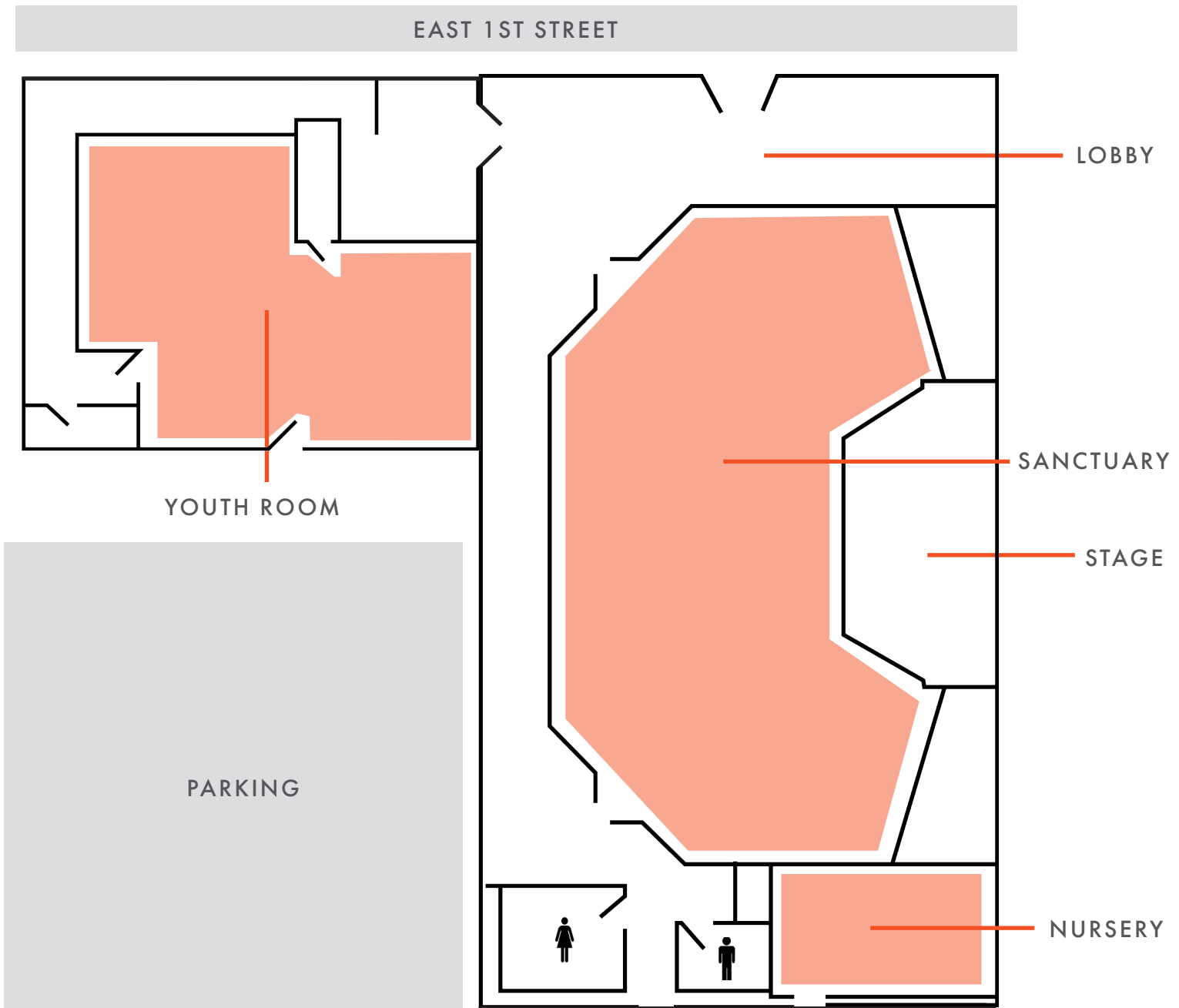

FOR MORE INFORMATION, PLEASE CONTACT:

**ETHAN REED | 949.525.6397**  
Associate Broker  
Ethan.Reed@foundrycommercial.com  
Licensed Real Estate Broker

**CHARLIE HOWARTH | 949.542.9484**  
Vice President  
Charlie.Howarth@foundrycommercial.com  
Licensed Real Estate Broker

**FOUNDRY**  
COMMERCIAL

MISSION  
PROPERTY  
GROUP

Although all information furnished regarding for sale, rental or financing is from sources we deem reliable, such information has not been verified and no express representation is made nor is any to be implied as to the accuracy thereof, and it is submitted subject to errors, omissions, changes of price, rental or other conditions, prior sale, lease or financing, or withdrawal without notice. All sizes are approximate and subject to survey.

[foundrycommercial.com](http://foundrycommercial.com)

AREA MAP



FOR MORE INFORMATION, PLEASE CONTACT:

**ETHAN REED | 949.525.6397**  
Associate Broker  
Ethan.Reed@foundrycommercial.com  
Licensed Real Estate Broker

**CHARLIE HOWARTH | 949.542.9484**  
Vice President  
Charlie.Howarth@foundrycommercial.com  
Licensed Real Estate Broker

**FOUNDRY**  
COMMERCIAL

MISSION  
PROPERTY  
GROUP

Although all information furnished regarding for sale, rental or financing is from sources we deem reliable, such information has not been verified and no express representation is made nor is any to be implied as to the accuracy thereof, and it is submitted subject to errors, omissions, changes of price, rental or other conditions, prior sale, lease or financing, or withdrawal without notice. All sizes are approximate and subject to survey.

[foundrycommercial.com](http://foundrycommercial.com)

## DEMOGRAPHICS

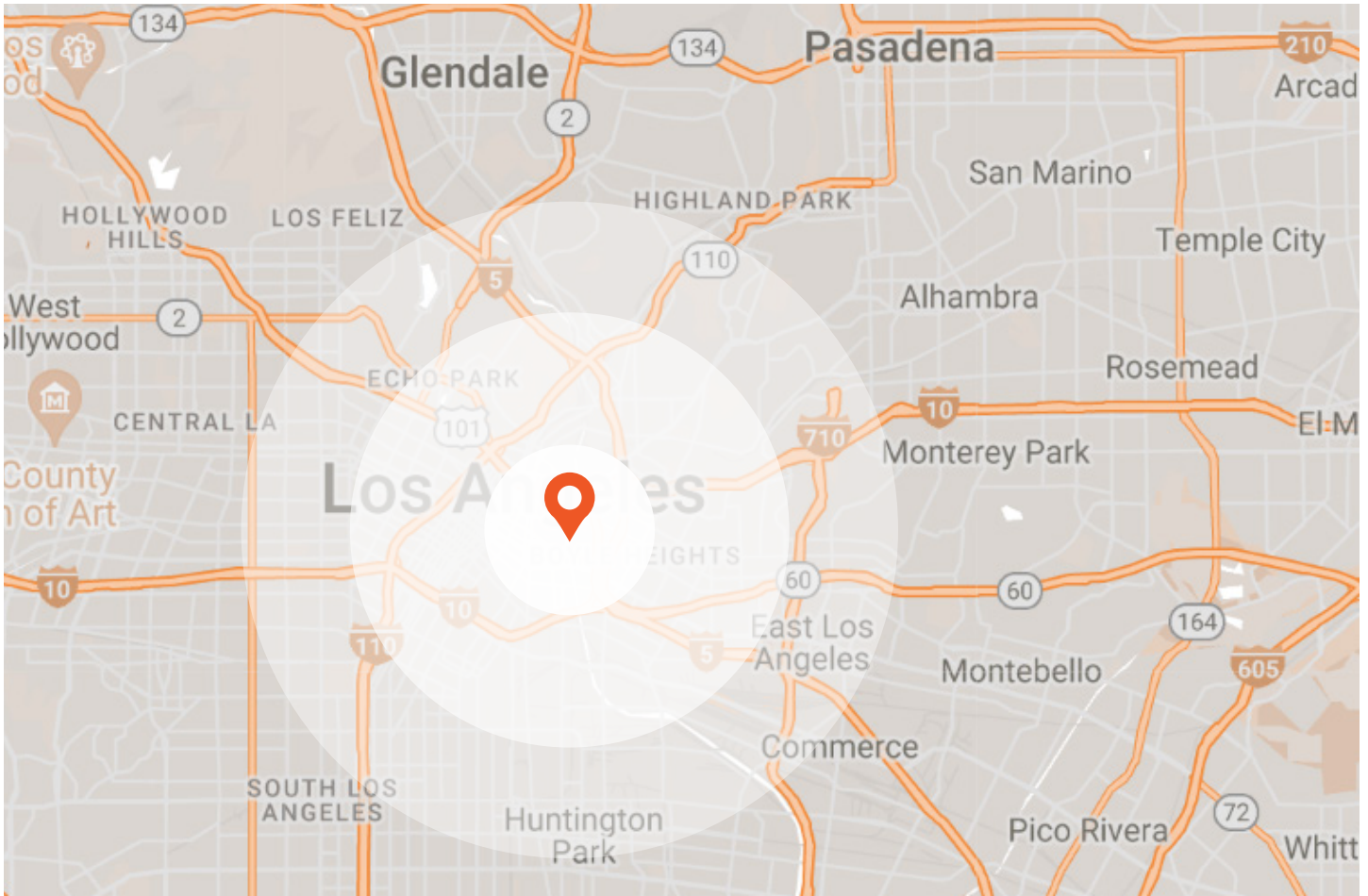

### 1 MILE RADIUS

	<b>38,536</b> ESTIMATED POPULATION 2024
	<b>33.8</b> MEDIAN AGE
	<b>\$762,235</b> MEDIAN HOME VALUE 2024
	<b>9,028</b> TOTAL EMPLOYEES
	<b>\$70,198</b> AVG HOUSEHOLD INCOME

### 3 MILE RADIUS

	<b>360,139</b> ESTIMATED POPULATION 2024
	<b>34.5</b> MEDIAN AGE
	<b>\$741,640</b> MEDIAN HOME VALUE 2024
	<b>25,560</b> TOTAL EMPLOYEES
	<b>\$67,056</b> AVG HOUSEHOLD INCOME

### 5 MILE RADIUS

	<b>1.07 M</b> ESTIMATED POPULATION 2024
	<b>34.4</b> MEDIAN AGE
	<b>\$817,871</b> MEDIAN HOME VALUE 2024
	<b>34,548</b> TOTAL EMPLOYEES
	<b>\$68,609</b> AVG HOUSEHOLD INCOME

FOR MORE INFORMATION, PLEASE CONTACT:

**ETHAN REED | 949.525.6397**  
Associate Broker  
Ethan.Reed@foundrycommercial.com  
Licensed Real Estate Broker

**CHARLIE HOWARTH | 949.542.9484**  
Vice President  
Charlie.Howarth@foundrycommercial.com  
Licensed Real Estate Broker

**FOUNDRY**  
COMMERCIAL

MISSION  
PROPERTY  
GROUP

Although all information furnished regarding for sale, rental or financing is from sources we deem reliable, such information has not been verified and no express representation is made nor is any to be implied as to the accuracy thereof, and it is submitted subject to errors, omissions, changes of price, rental or other conditions, prior sale, lease or financing, or withdrawal without notice. All sizes are approximate and subject to survey.

[foundrycommercial.com](https://foundrycommercial.com)