



VELOCITY VENTURES



STATION PARK

7,285 RSF FLEX/OFFICE SPACE
AVAILABLE FOR LEASE

330-339 S WARMINSTER RD

HATBORO, PA 19040

The
Flynn
Company



MICHAEL BORSKI JR., SIOR
MBORSKIJR@FLYNNCO.COM
215-561-6565 X 119



KEVIN FLYNN JR
KFLYNNJR@FLYNNCO.COM
215-561-6565 X 121



MARK PAWLOWSKI
MPAWLOWSKI@FLYNNCO.COM
215-561-6565 X 146

THE FLYNN COMPANY

WWW.FLYNNCO.COM | 1621 WOOD STREET, PHILADELPHIA, PA 19103 | 215.561.6565



PROPERTY HIGHLIGHTS



KINDERCARE ON SITE



HATBORO TRAIN STATION

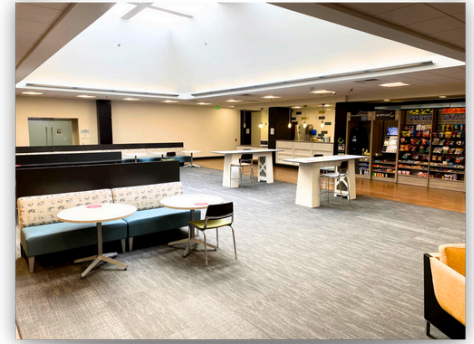

GRAB N' GO CAFE

- 412,454 SF multi-tenant complex on 29.47 acres
- Building Located catty corner to the SEPTA Hatboro Train Station
- Two on-site generators
- 7 mega watts of power to the site
- 1249 parking spaces (3 per 1,000 sf)
- Tax Parcel 08-00-05734-00-9
- Fully wet sprinklered system with new pump installed 2019
- On-Site KinderCare Daycare
- On-Site Common Grab N' Go Café
- Zoned LI: Limited flex/office District in Hatboro Borough

SUITE HIGHLIGHTS



- Private entrance from parking lot with ample spaces available
- Signage opportunity above entrance
- Versatile flex and office space
- Easy access to Grab N' Go Café



FLOOR PLAN

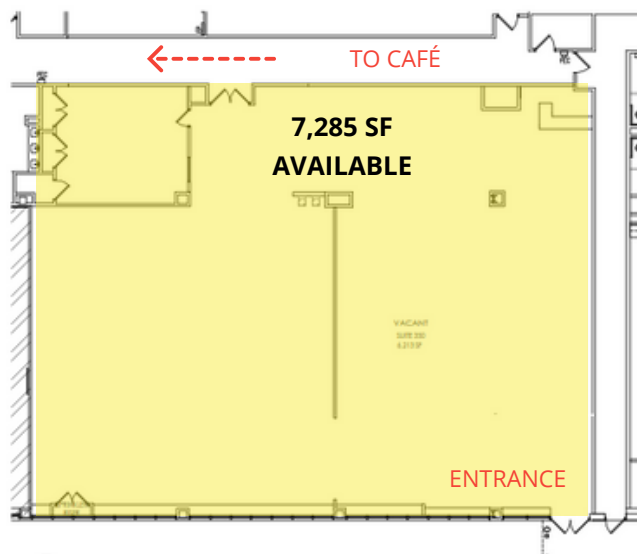
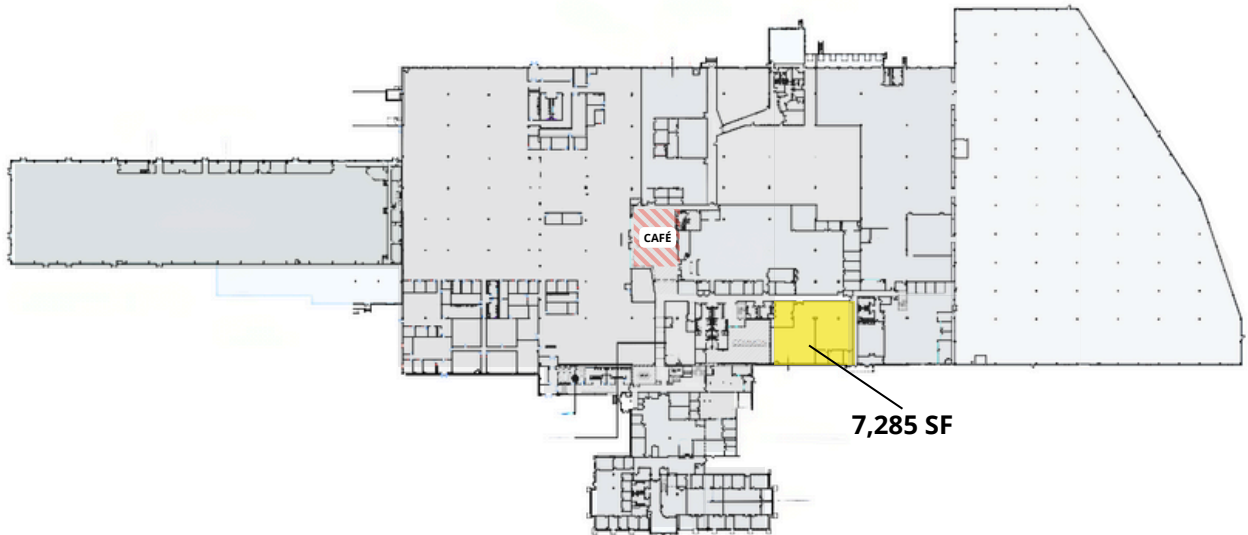



LOCATION

- The property is located at the intersection of Byberry and S Warminster Roads
- Approximately 1.75 miles from the Willow Grove exit of the Pennsylvania Turnpike.
- Additional access by Easton Rd (611), County Line Rd, Street Rd and York Rd.
- Located in close proximity to ample restaurants, shops and local amenities
- Trenton Mercer Airport 22.6 mi | Philadelphia International Airport 28.1 mi

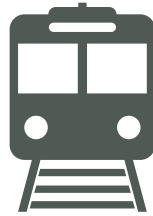

HATBORO TRAIN STATION
LOCATED CATTY CORNER
TO THE REAR OF THE SITE

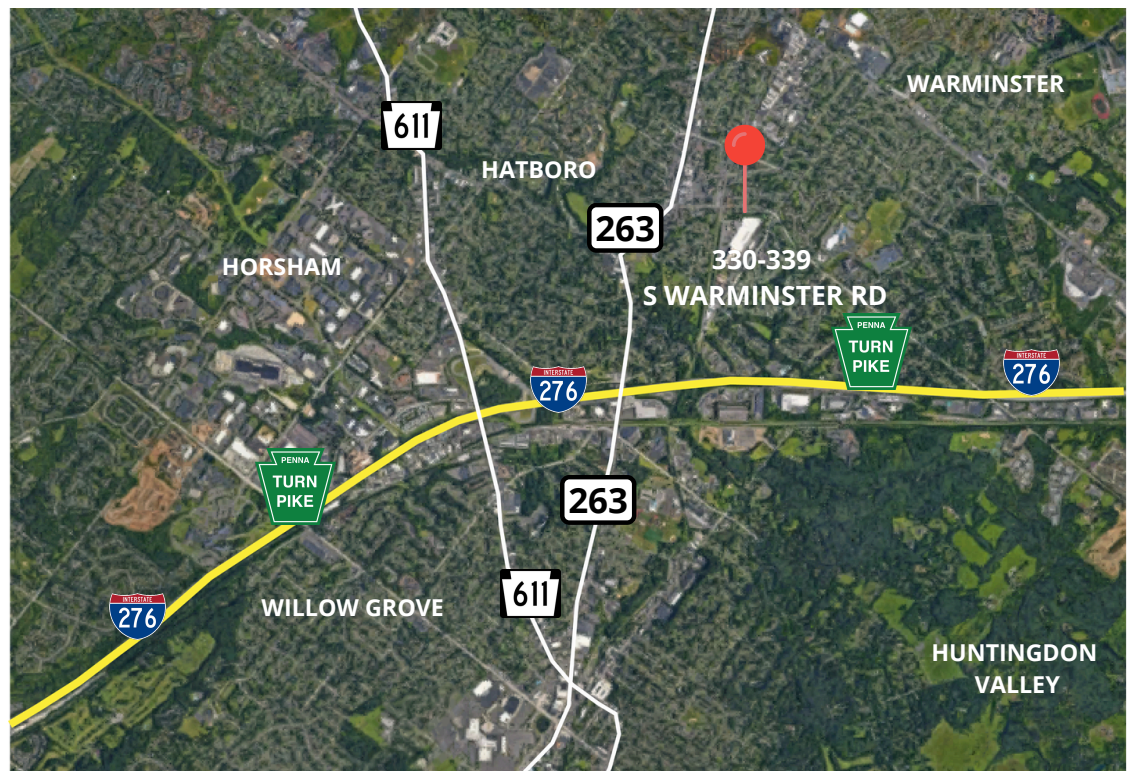



NEARBY AMENITIES

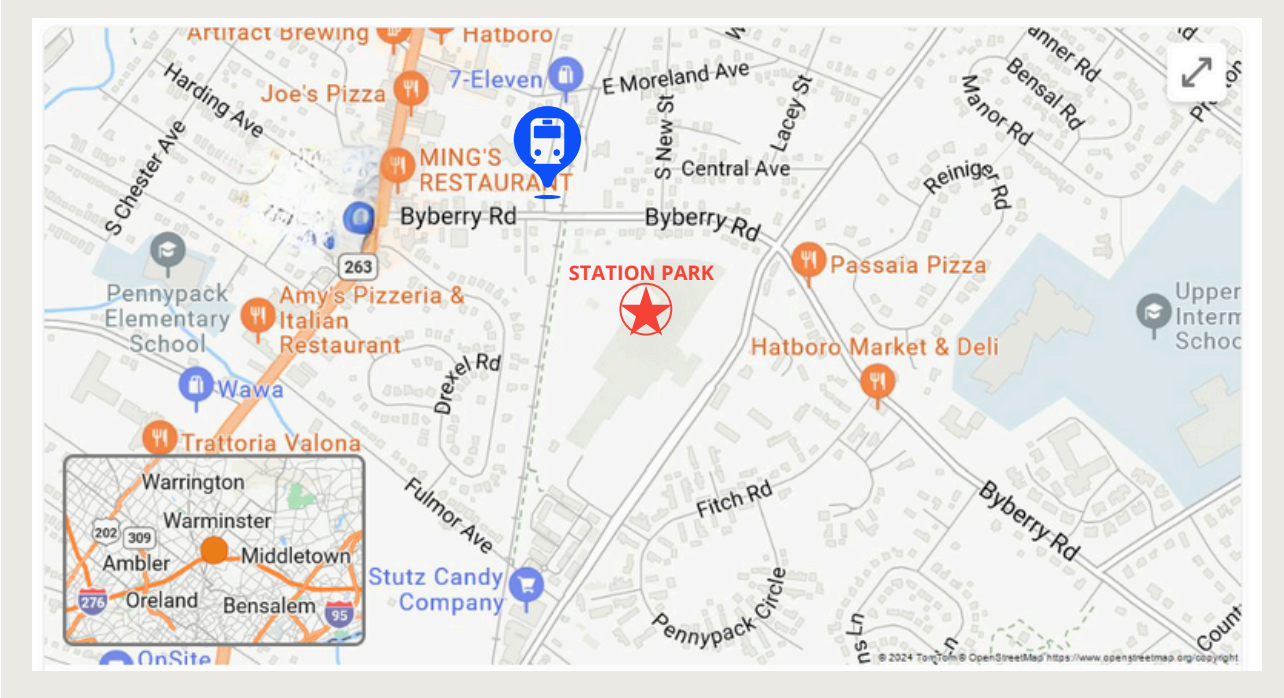

SUITE PHOTOS

