

NEWLY RENOVATED

WEIGAND
COMMERCIAL



WAREHOUSE/MANUFACTURING

FOR LEASE 700 E. 37TH ST. NORTH, WICHITA, KS 67219

ict37
INDUSTRIAL DISTRICT

LEASE RATE
CONTACT BROKER

SITE SIZE
296,644 SF (6.81± A)

BUILDING SIZE
165,158± SF

TOTAL AVAILABLE SPACE
*165,158± SF
(See Building Plan)

CEILING HEIGHT
15'6" - 23'

YEAR BUILT
1950
IMPROVEMENTS: 1960, 2025

CONSTRUCTION
CAVITY BRICK/METAL
ON STEEL, BRICK/BLOCK

DOCK DOORS
10

OVERHEAD DOORS
1

SPRINKLED
WET & DRY

ZONING
GENERAL COMMERCIAL

2025 TAXES (\$0.68/SF, ESTIMATED)
GENERAL: \$111,962.22
SPECIALS: \$60.00

PARKING
AMPLE

PROPERTY HIGHLIGHTS

- Warehouse available for lease.
- Heavy power.
- Excellent access to all major arterials via Broadway at I-235.

*Square footage referenced is per floor plan - excludes office and mezzanine.



Grant Tidemann, SIOR
316-292-3908
tidemann@weigand.com

Bradley Tidemann, SIOR
316-650-8853
bradley@tidemannre.com



BUILDING PLAN

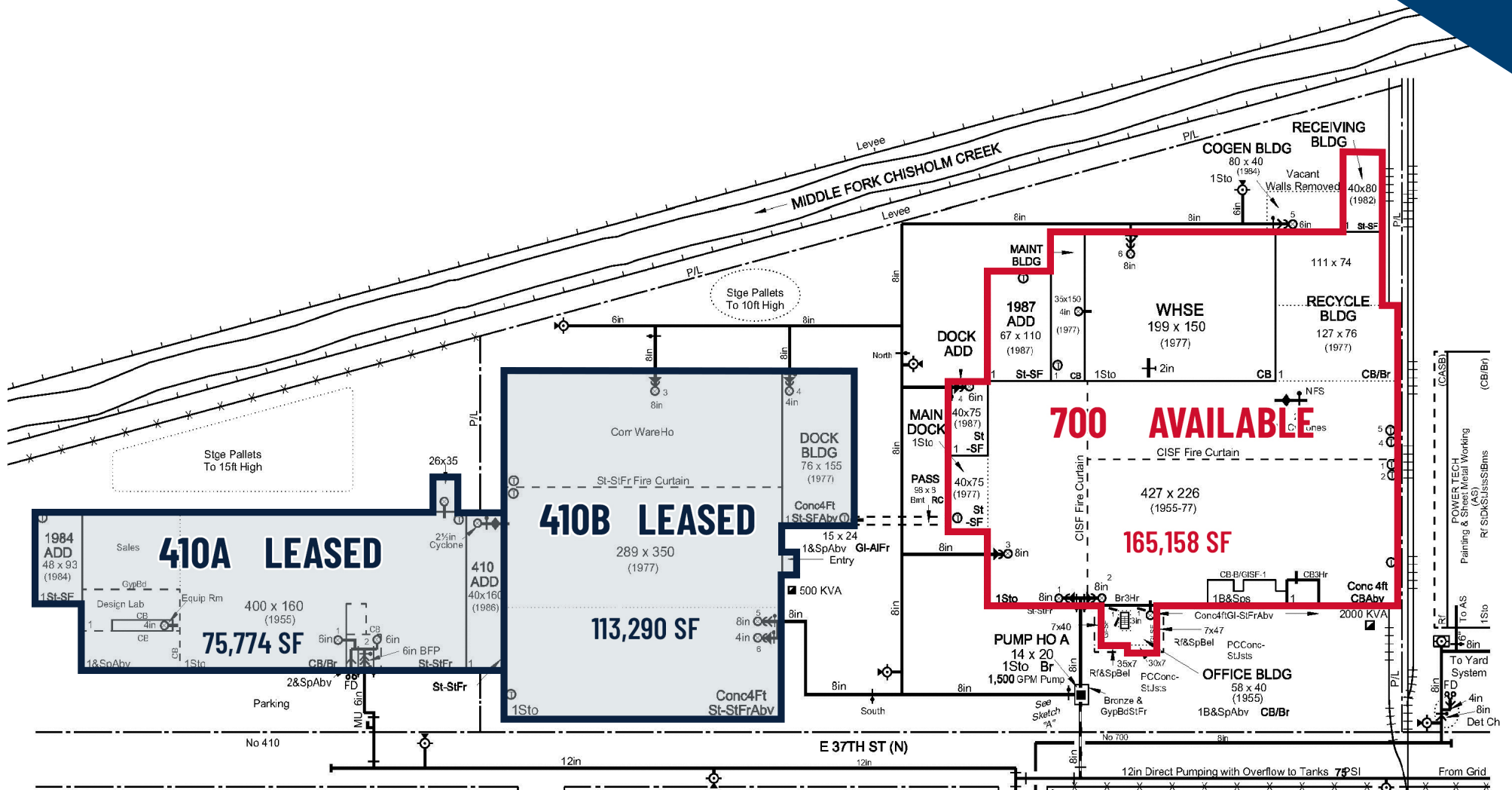

All information furnished regarding property for sale, lease, exchange or financing is from sources deemed reliable but no guarantee is made or responsibility assumed as to its accuracy or completeness and you are advised to make your own analysis and verification. Agent hereby notifies prospective buyer/lessee that (a) Agent will be acting as a designated agent of seller/lessor with the duty to represent seller/lessor's interest; and (b) Information given to Agent will be disclosed to seller/lessor.



Grant Tidemann, SIOR
316-292-3908
tidemann@weigand.com

Bradley Tidemann, SIOR
316-650-8853
bradley@tidemannre.com



WAREHOUSE/MANUFACTURING FOR LEASE 700 E. 37TH ST. NORTH, WICHITA, KS 67219

WEIGAND
COMMERCIAL

NEIGHBORHOOD AERIAL



All information furnished regarding property for sale, lease, exchange or financing is from sources deemed reliable but no guarantee is made or responsibility assumed as to its accuracy or completeness and you are advised to make your own analysis and verification. Agent hereby notifies prospective buyer/lessee that (a) Agent will be acting as a designated agent of seller/lessor with the duty to represent seller/lessor's interest; and (b) Information given to Agent will be disclosed to seller/lessor.



Grant Tidemann, SIOR
316-292-3908
tidemann@weigand.com

Bradley Tidemann, SIOR
316-650-8853
bradley@tidemannre.com



WAREHOUSE/MANUFACTURING FOR LEASE 700 E. 37TH ST. NORTH, WICHITA, KS 67219

WEIGAND

COMMERCIAL

AERIAL VIEW



All information furnished regarding property for sale, lease, exchange or financing is from sources deemed reliable but no guarantee is made or responsibility assumed as to its accuracy or completeness and you are advised to make your own analysis and verification. Agent hereby notifies prospective buyer/lessee that (a) Agent will be acting as a designated agent of seller/lessor with the duty to represent seller/lessor's interest; and (b) Information given to Agent will be disclosed to seller/lessor.



Grant Tidemann, SIOR
316-292-3908
tidemann@weigand.com

Bradley Tidemann, SIOR
316-650-8853
bradley@tidemannre.com

