



**FOR LEASE**

# Warehouse & Showroom

495 Highway 99  
Eugene OR 97402

## DETAILS

- 4,200 square feet
- Warehouse area with two 12'x14' loading doors
- Retail showroom with office and breakroom
- Two restrooms
- Zoned C-2 (Community Commercial)
- \$3,570 per month, modified gross rent

**Evans  
Elder  
Brown &  
Seubert**

COMMERCIAL REAL ESTATE

**Jeff Elder**  
jeff@eebcre.com

**541.345.4860**

Licensed in the State of Oregon.

# Overview

495 Highway 99 | Eugene OR 97402

Evans  
Elder  
Brown &  
Seubert

COMMERCIAL REAL ESTATE

## CONTACT

Jeff  
Elder

jeff@eebcre.com

541.345.4860

Licensed in the  
State of Oregon.

## Description

**4,200 SQUARE FEET**

- Warehouse area with two 12'x14' loading doors
- Retail showroom with office and breakroom
- Two restrooms
- Zoned C-2 (Community Commercial)
- \$3,570 per month, modified gross rent

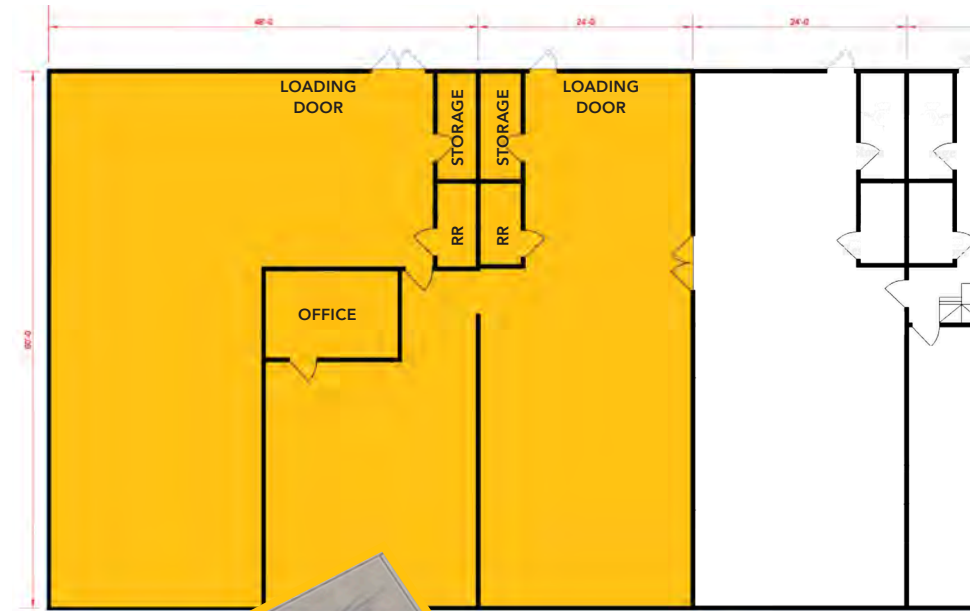

The information in this package was gathered from sources deemed reliable, however Evans Elder Brown & Seubert makes no representation or warranty of the accuracy of the information. Any buyer or tenant considering a purchase or lease of this property should confirm any and all information relied upon in making the decision to purchase or lease prior to finalizing the transaction and bears the risk of all inaccuracies.



# Photographs

495 Highway 99 | Eugene OR 97402

Evans  
Elder  
Brown &  
Seubert

COMMERCIAL REAL ESTATE

## CONTACT

Jeff  
Elder

jeff@eebcre.com

541.345.4860

Licensed in the  
State of Oregon.



The information in this package was gathered from sources deemed reliable, however Evans Elder Brown & Seubert makes no representation or warranty of the accuracy of the information. Any buyer or tenant considering a purchase or lease of this property should confirm any and all information relied upon in making the decision to purchase or lease prior to finalizing the transaction and bears the risk of all inaccuracies.



# Location

495 Highway 99 | Eugene OR 97402



HIGHWAY 99 VISIBILITY & FRONTAGE

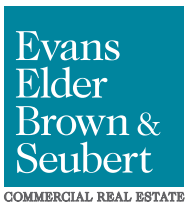
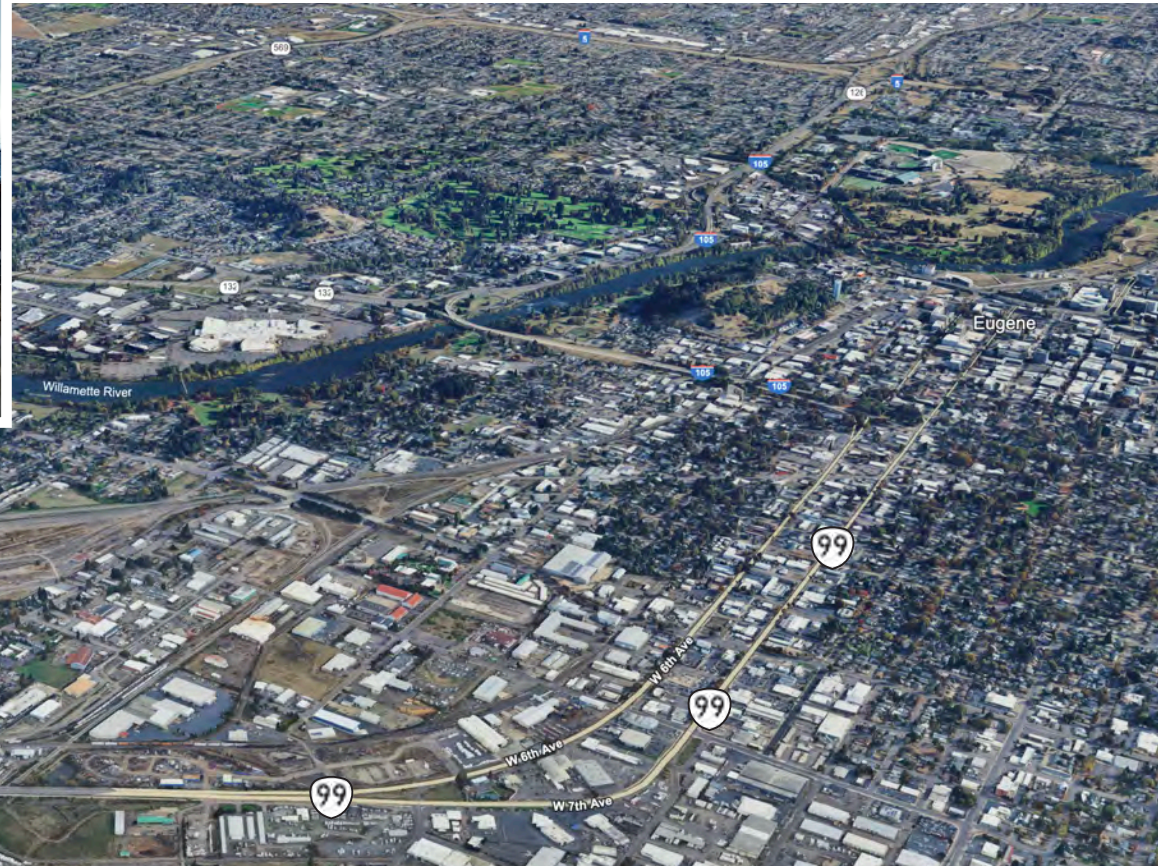

## CONTACT

541.345.4860

Jeff Elder

jeff@eebcre.com