

70701 Powell Road

Romeo, MI

- 101,297 SF with 6,942 SF of Office
- Seller Would Consider a Land Contract
- 10,000 Amps of 480 Volt Power
- Double Exterior Truckwells
- Excellent Manufacturing Infrastructure
- Located Directly off M-53 with Close Proximity to I-69 & M-59

INDUSTRIAL BUILDING FOR SALE OR LEASE



94,355 SF of Factory



6,942 SF of Office



Two Truckwells

FOR MORE INFORMATION:

Joe DePonio III, SIOR
Senior Vice President
248.637.3513
jdeponio@LMCap.com

Jason Capitani, SIOR, CCIM
Managing Partner
248.637.7684
jcapitani@LMCap.com

248.637.9700 | LMCap.com



L. MASON CAPITANI

CORFAC INTERNATIONAL

CELEBRATING 60 YEARS

70701 Powell Road

Romeo, MI



L. MASON CAPITANI

CORFAC INTERNATIONAL

CELEBRATING 60 YEARS

Industrial Property Details:

Details:

Site Description:	N of 32 Mile Road, on the W side of Powell Road.
Year Built:	1994
Frontage:	216'
Depth:	760'
Parking:	170 Spaces
Total SF:	101,297 SF
Available SF:	101,297 SF
Office SF:	6,942 SF
Factory SF:	94,355 SF
X-Way Distance:	Minutes to M-53
Zoning:	IND
Acres:	6.21

Interior:

Ceiling Height:	17.5'
Bay Size:	50'
Restrooms:	6
Crane(s):	(1) 5-Ton
Underhook:	14'
Power:	440/480 10,000 Amps
Lighting:	LED
Grade Door:	(4) 12'x14' (1) 14'x14'
Heating:	Radiant
A/C:	Office Only
Airlines:	Yes
Notes:	Seller would consider selling on Land Contract.

Economic

Sale Price:	\$8,950,000
Price/SF:	\$88.35
Lease/SF:	\$7.25
Lease/Month:	\$61,200.27
Lease Terms:	NNN
Taxes:	\$103,196.58

70701 Powell Road

Romeo, MI



248.637.9700 | LMCap.com

70701 Powell Road

Romeo, MI



70701 Powell Road

Romeo, MI

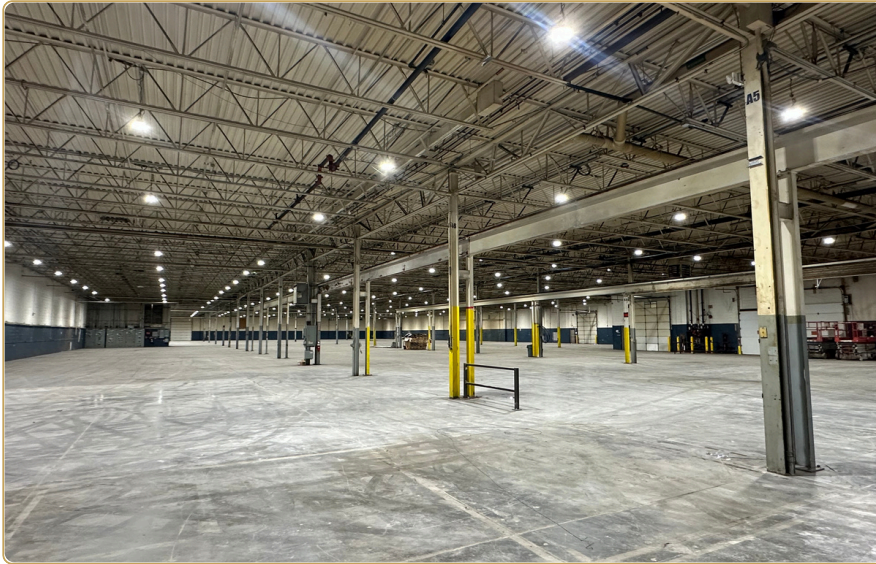

70701 Powell Road

Romeo, MI



L. MASON CAPITANI

CORFAC INTERNATIONAL

CELEBRATING 60 YEARS

Floor Plan:

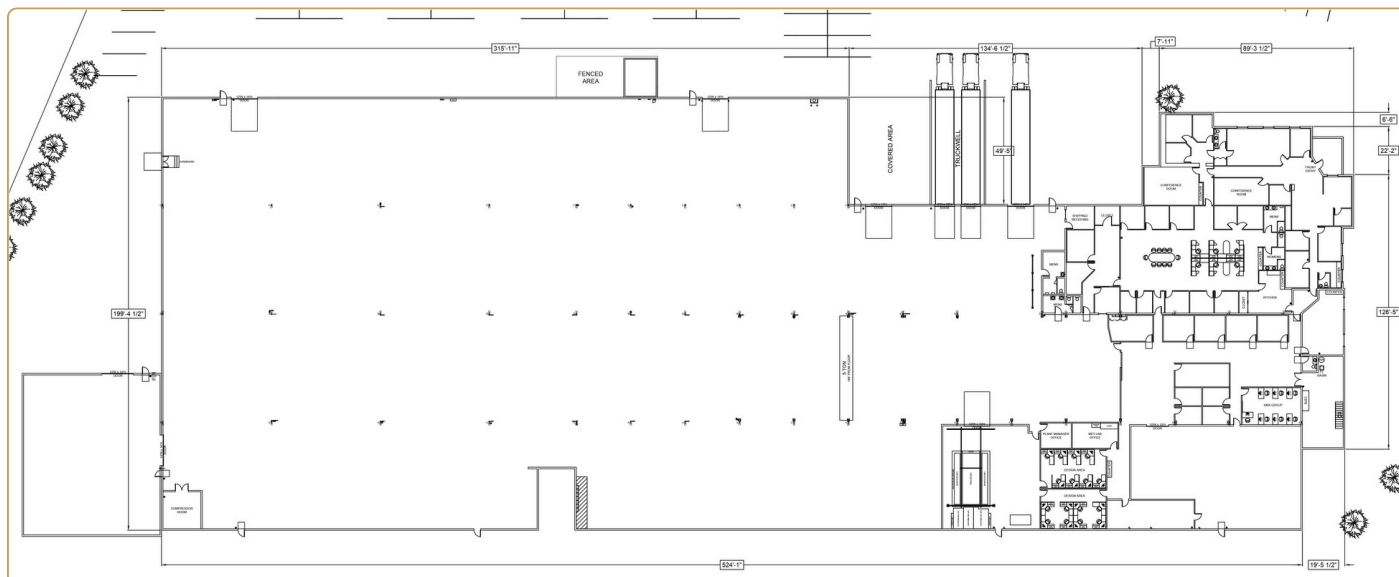

Site Plan:

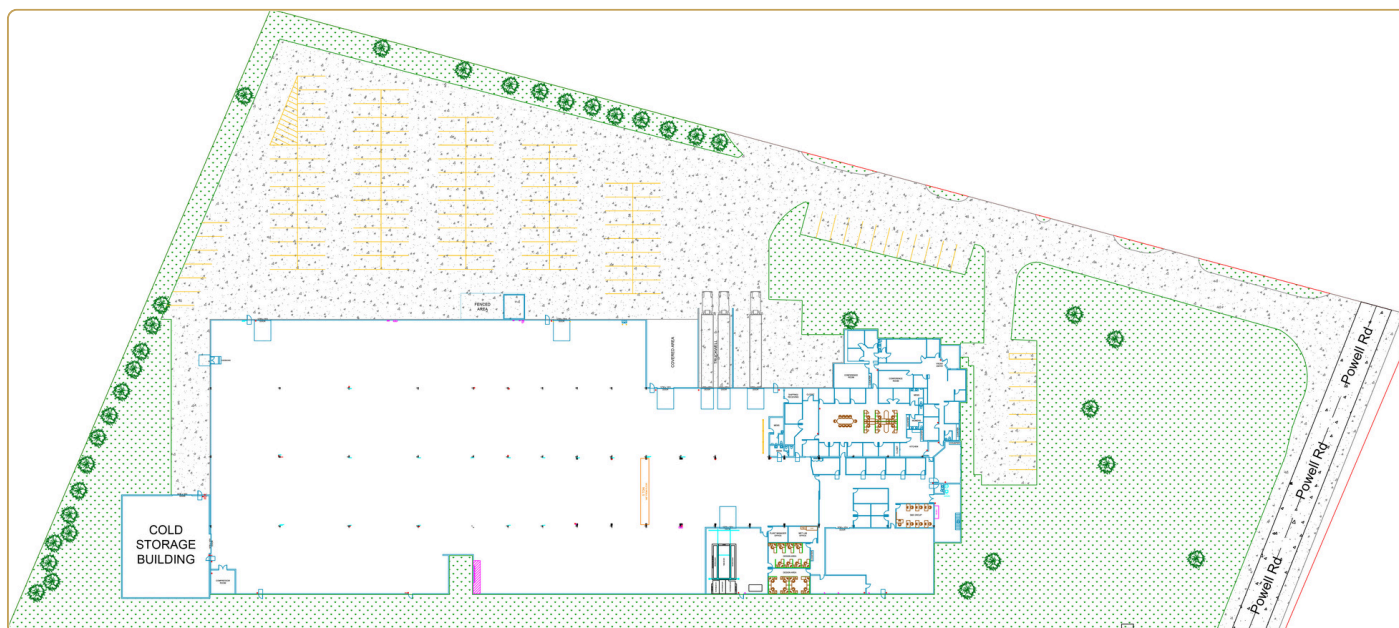

70701 Powell Road

Romeo, MI



L. MASON CAPITANI

CORFAC INTERNATIONAL

CELEBRATING 60 YEARS

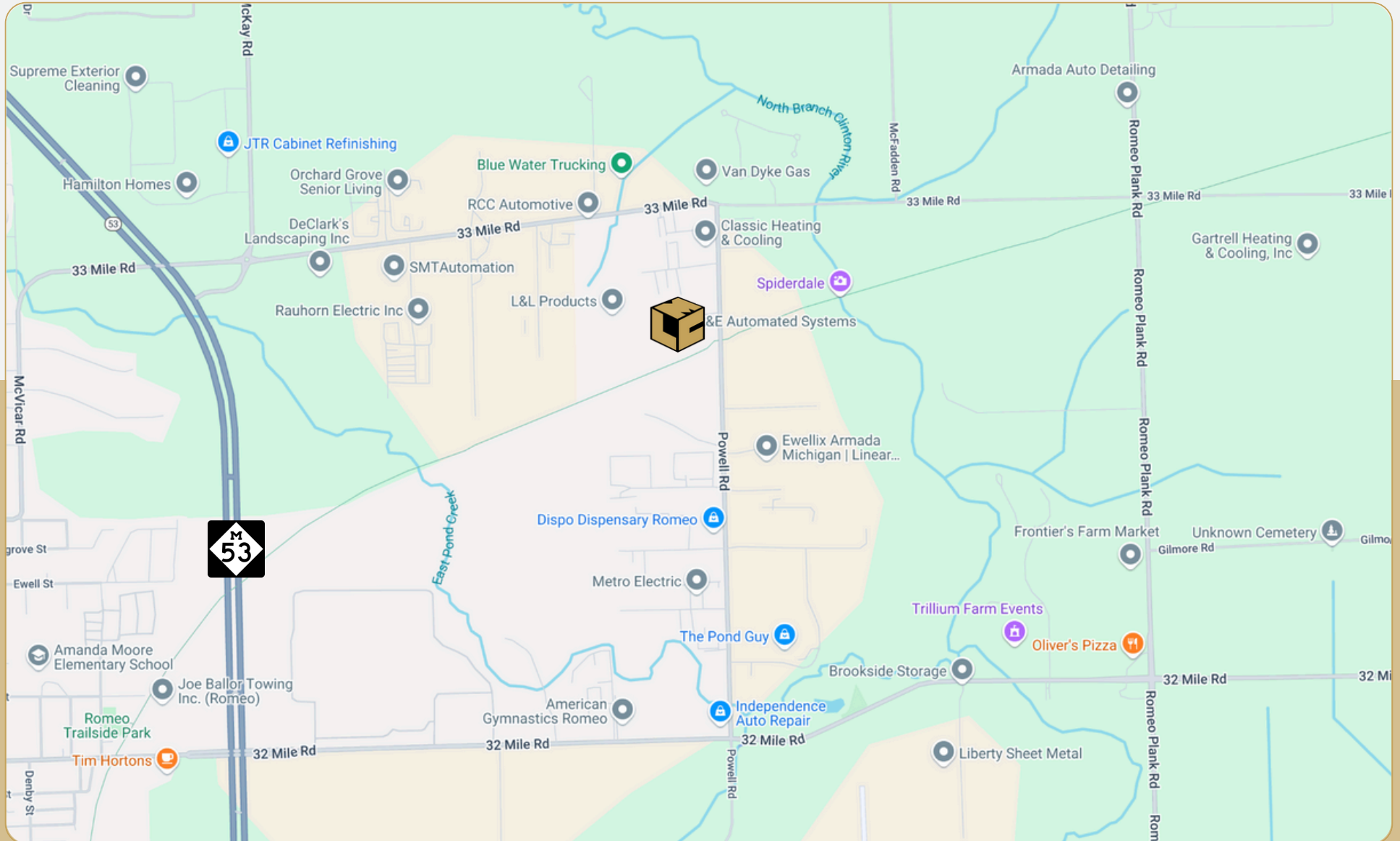

248.637.9700 | LMCap.com