

# OFFICE AVAILABLE FOR LEASE

16,854 SF



*400 Race Street, San Jose, CA*

**GLOBAL**  
COMMERCIAL

[www.GlobalCommercialProp.com](http://www.GlobalCommercialProp.com)

RALPH LONGO  
408-529-1362

DRE #01202211  
[RLONGO@GLOBALCOMMERCIALPROP.COM](mailto:RLONGO@GLOBALCOMMERCIALPROP.COM)



# OFFICE AVAILABLE FOR LEASE

16,854 SF

- Professional Setting
- Close to DTSJ & Willow Glen Amenities
- 280/87 Access
- Walk to Light Rail
- 1.26 Miles to Diridon Caltrain
- Free On-Site Parking
- Great Image Building
- Kitchen/Breakroom
- 15 Private/Conference Rooms
- Google Village Nearby



*400 Race Street, San Jose, CA*

**GLOBAL**  
COMMERCIAL

[www.GlobalCommercialProp.com](http://www.GlobalCommercialProp.com)

RALPH LONGO  
408-529-1362

DRE #01202211  
[RLONGO@GLOBALCOMMERCIALPROP.COM](mailto:RLONGO@GLOBALCOMMERCIALPROP.COM)

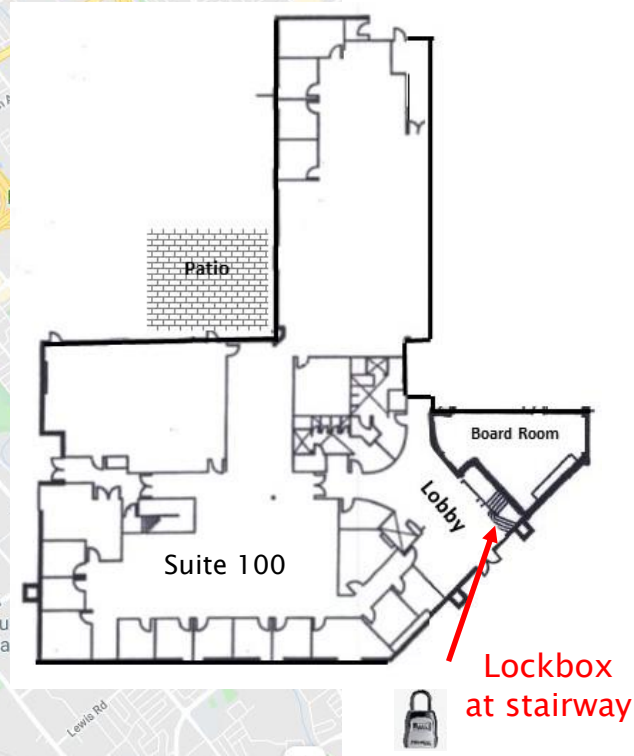
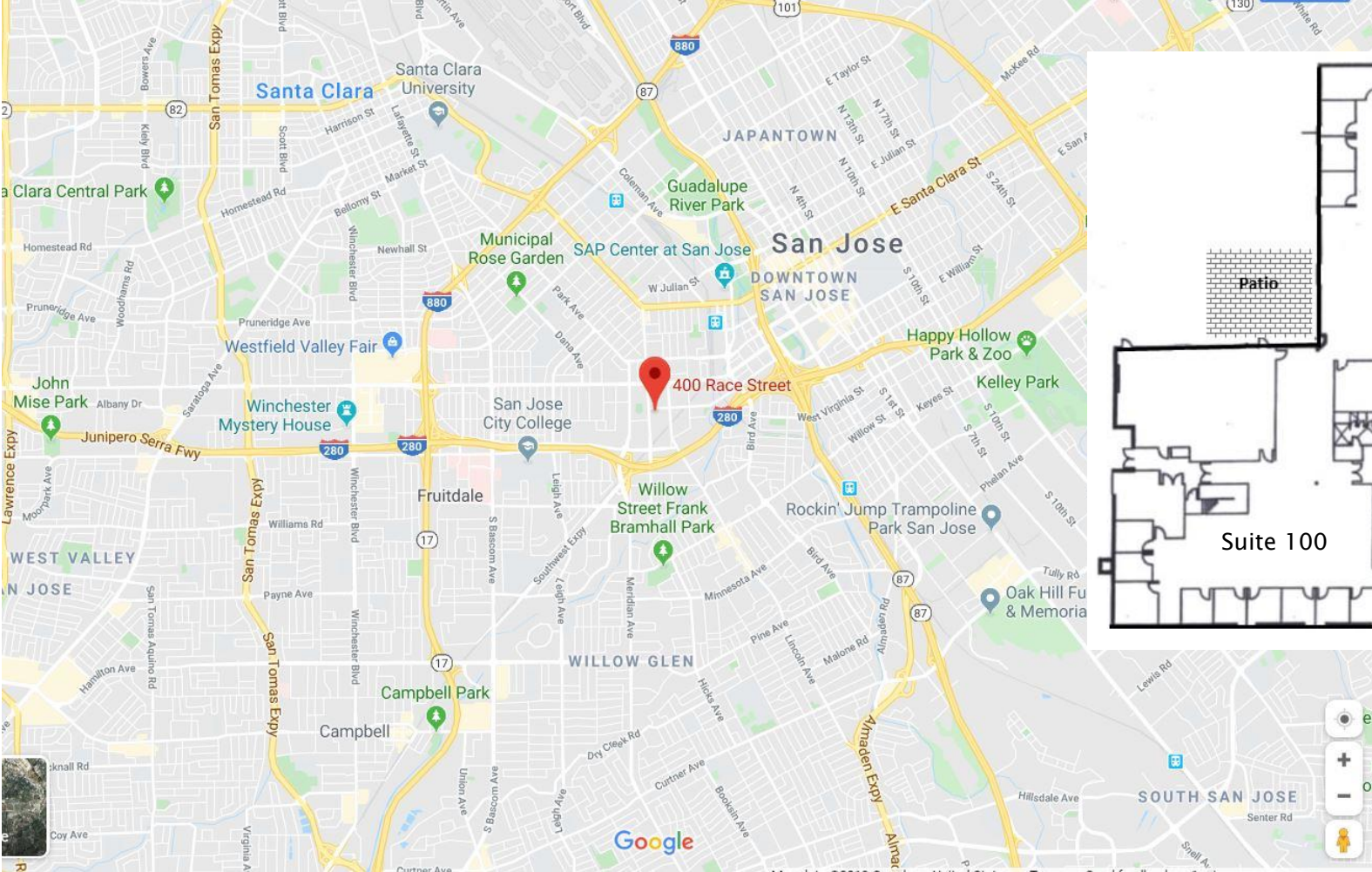

*400 Race Street, San Jose, CA*

**GLOBAL**  
COMMERCIAL

[www.GlobalCommercialProp.com](http://www.GlobalCommercialProp.com)

RALPH LONGO  
408-529-1362  
DRE #01202211  
RLONGO@GLOBALCOMMERCIALPROP.COM