

93



**BRICK
KILN**

CHELMSFORD, MA

**BUILT TO SUIT, WAREHOUSE
INDUSTRIAL SPACE FOR LEASE**

48,910 SF

NEWMARK

FLOOR PLANS

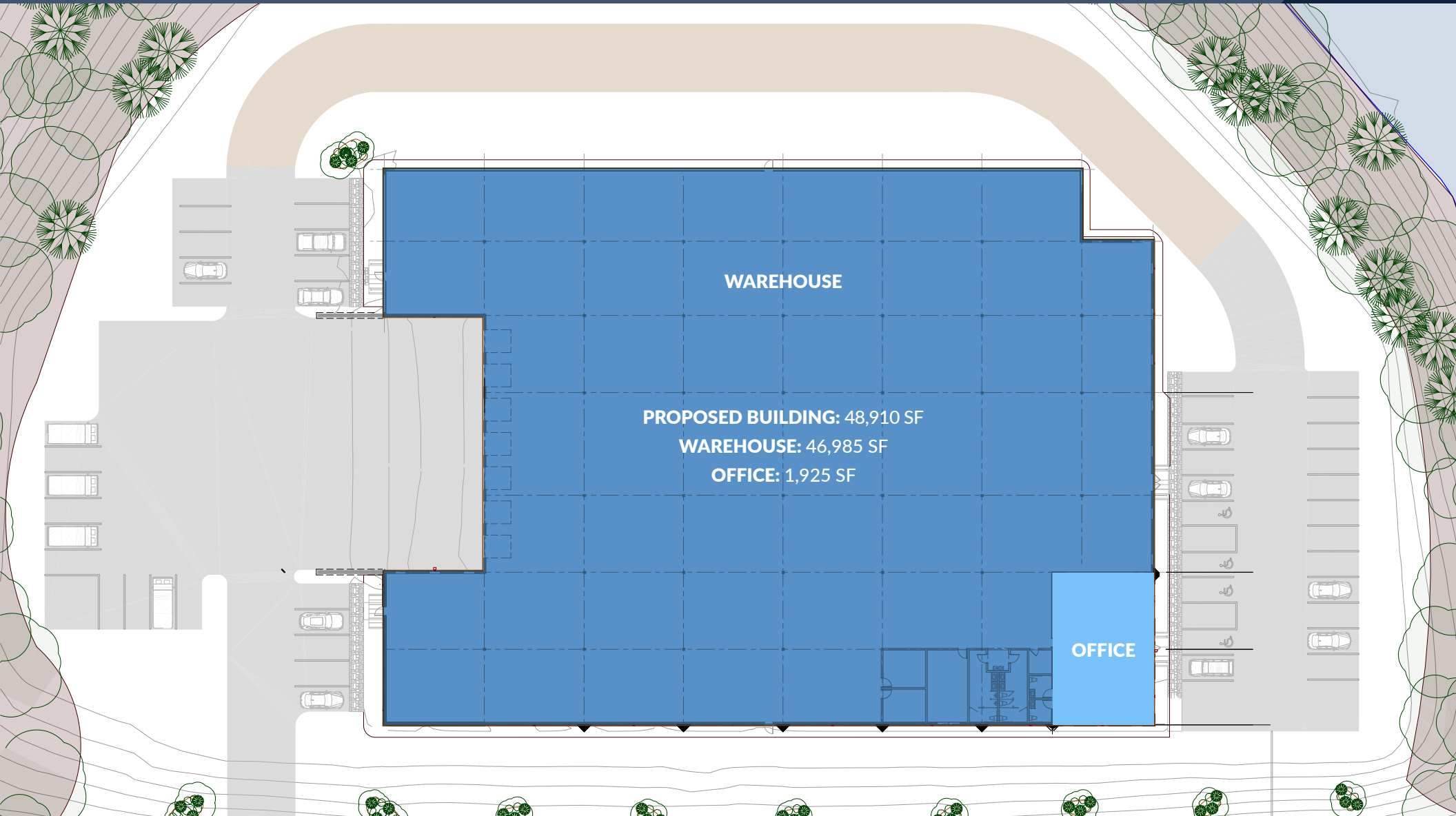

BUILDING SPECS

AVAILABLE SF: APPROXIMATELY 48,910 SF

LOADING: 7 TAILBOARD DOCKS

CLEAR HEIGHT: 30'-0"

COLUMN BAY SPACING: 27' X 35'

FLOOR THICKNESS: 6" CONCRETE SLAB

SPRINKLER: ESFR

PARKING: 50 SPACES

UTILITIES: WATER, ELECTRIC, GAS, SEWER

DELIVERY DATE TBD



EAST ELEVATION - SCALE: 1/16" = 1'-0"



NORTH ELEVATION - SCALE: 1/16" = 1'-0"



SOUTH ELEVATION - SCALE: 1/16" = 1'-0"



WEST ELEVATION - SCALE: 1/16" = 1'-0"

SITE PLAN



SUPERIOR ACCESS & LOCATION





10 MIN DRIVE
TO NH



3 MIN DRIVE
TO I-495



10 MIN DRIVE
TO I-95



BOSTON



FOR MORE INFORMATION, CONTACT:

TORIN TAYLOR
torin.taylor@nmrk.com
617.863.8587

RICH RUGGIERO
richard.ruggiero@nmrk.com
617.863.8550

MATT ADAMS
matt.adams@nmrk.com
617.863.8563

RORY WALSH
rory.walsh@nmrk.com
617.863.8584

INVESTMENT SALES

CASEY VALENTE
casey.valente@nmrk.com
617.863.8603

NEWMARK