

# COAST GUARD BOULEVARD

Portsmouth, VA

## FOR LEASE

// TRAILER DROP LOT - BTS

// TRANSLOAD - BTS

// WAREHOUSE - BTS (DRY OR COLD)

INDUSTRIAL OPTIONS  
AVAILABLE

Developed by:

**INLIGHT**  
REAL ESTATE PARTNERS

**CUSHMAN &  
WAKEFIELD**

**THALHIMER**

**NEWMARK**



## PROPERTY DETAILS

### SITE

**Total Acreage:** ± 32.86 acres

**Projected Uplands:** ± 30 acres

**Zoning:** IN, Industrial District (Heavy Industrial Land Use)

**Utility Providers/Service To Site:**

- City water (16" line) and City sewer available along Coast Guard Boulevard
- Columbia Gas of Virginia (6" line)
- Verizon (fiber-optics) or Cox Communications
- Dominion Energy – 1.3 miles from substation

**Incentives:** Foreign Trade Zone 20 eligible; Local, state and port-sponsored grants

### TRAILER DROP CONCEPT

**Trailer Parking:** 310 Trailer stalls

### TRANSLOAD BTS CONCEPT

**Building Size:** 46,800 SF (100' x 468')

**Loading:** 76 Positions

**Trailer Parking:** 114 Trailer stalls | **Employee Parking:** 95 Spaces

### WAREHOUSE BTS (DRY OR COLD) CONCEPT

**Building Size:** ± 165,000 SF (286' x 580') to ± 252,720 SF (260' x 972')

**Power:** 3-Phase, 300 amps

**Sprinkler:** ESFR

**Clear Height:** 32' or BTS

**Loading Depth:** 130' to 145'

**Loading:** BTS

**Trailer Parking:** 53 Trailer stalls | **Employee Parking:** 95 Spaces

*Click [here](#) for more information on cold concept*

### ZONING | PERMITTED USES

**IN, Industrial District - Heavy Industrial Land Use.**

Established and intended to accommodate heavy manufacturing, assembly, fabrication, processing, distribution, storage, research and development, cold storage, and other industrial uses that may be large-scale or otherwise have extensive exterior movement of vehicle, materials, and goods

# SITE PLAN

## TRAILER DROP CONCEPT



# SITE PLAN

## TRANSLOAD BTS CONCEPT



# SITE PLAN

165,000 SF WAREHOUSE BTS (DRY OR COLD) CONCEPT

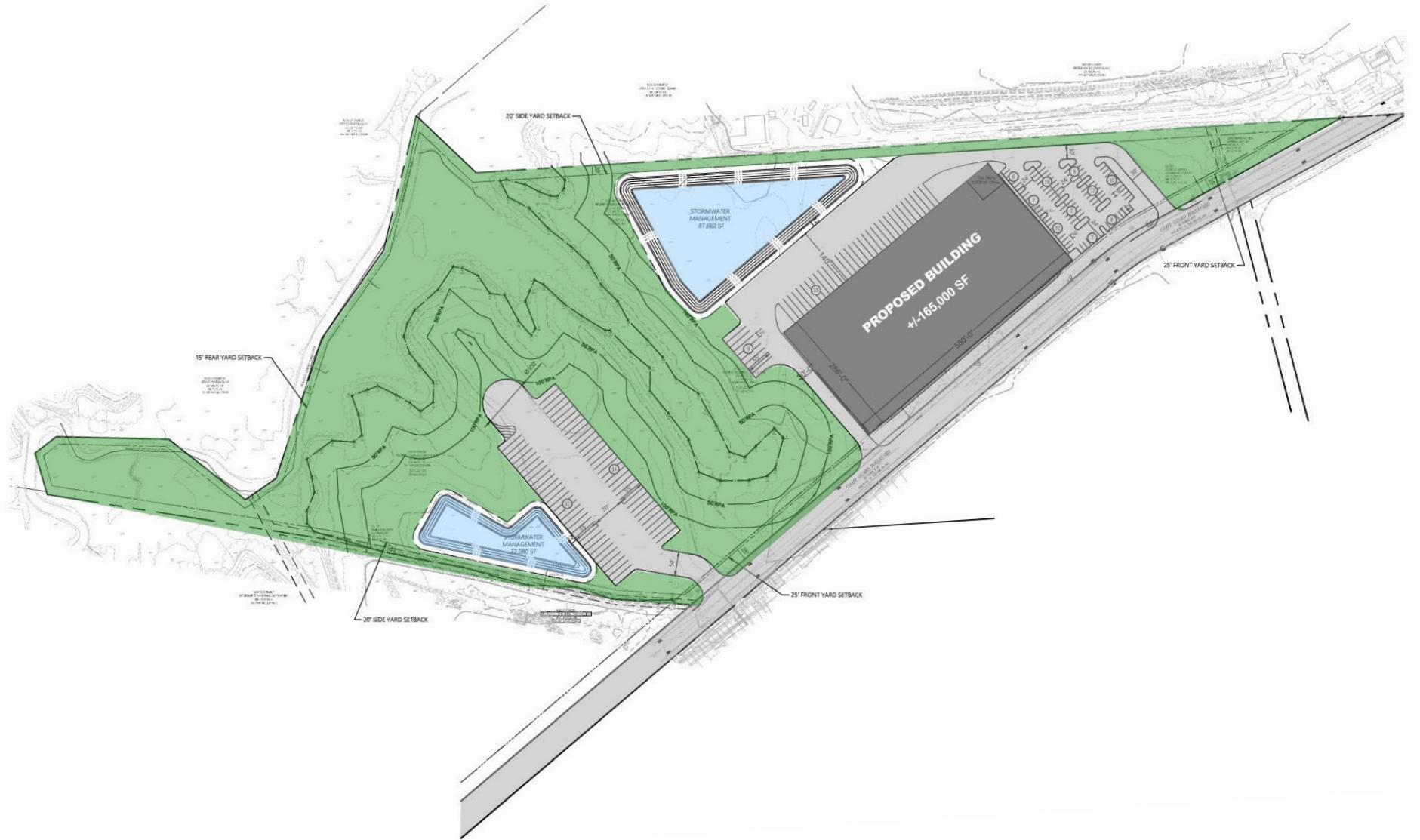

# SITE PLAN

## 252,720 SF WAREHOUSE BTS (DRY OR COLD) CONCEPT

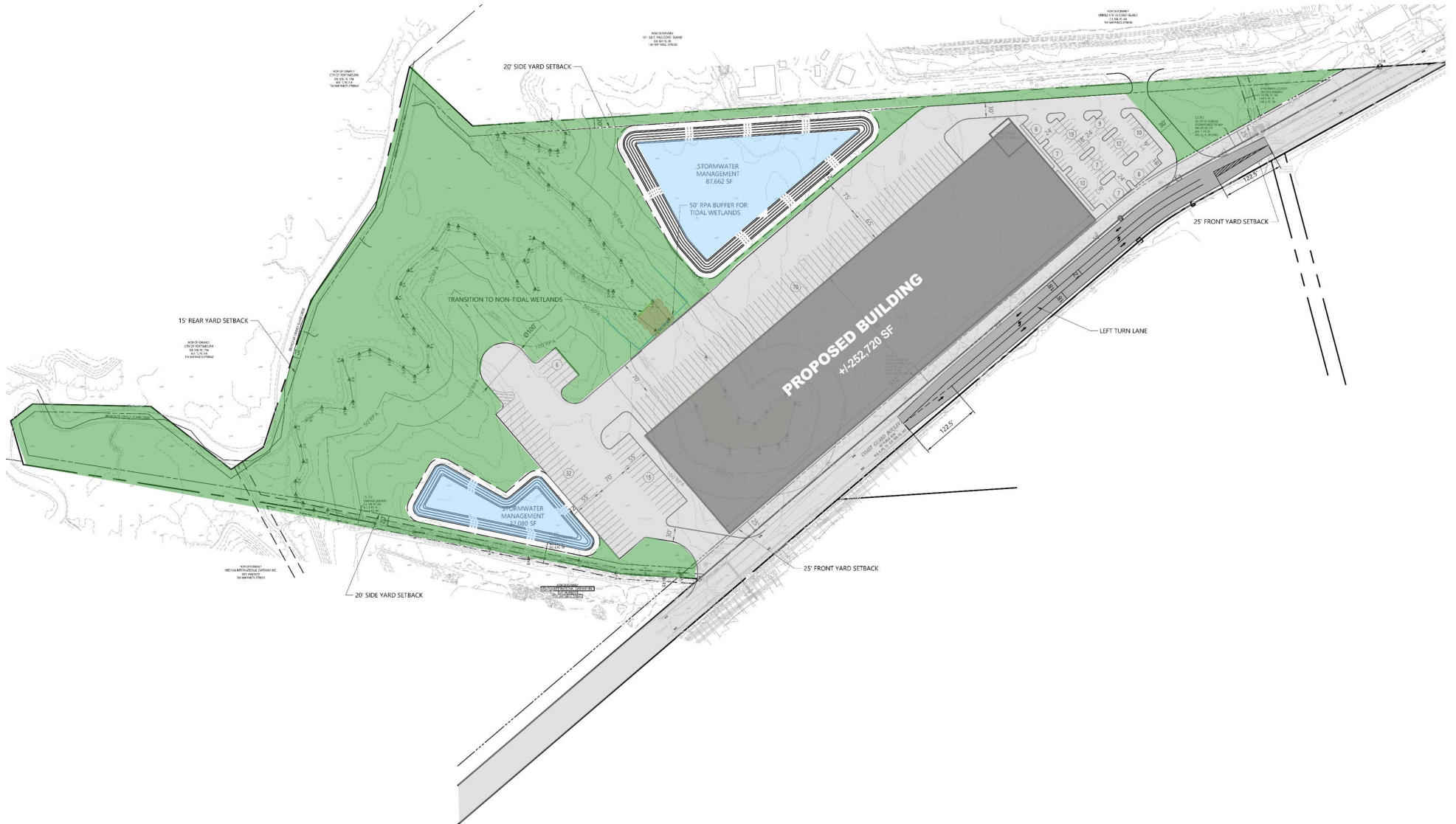

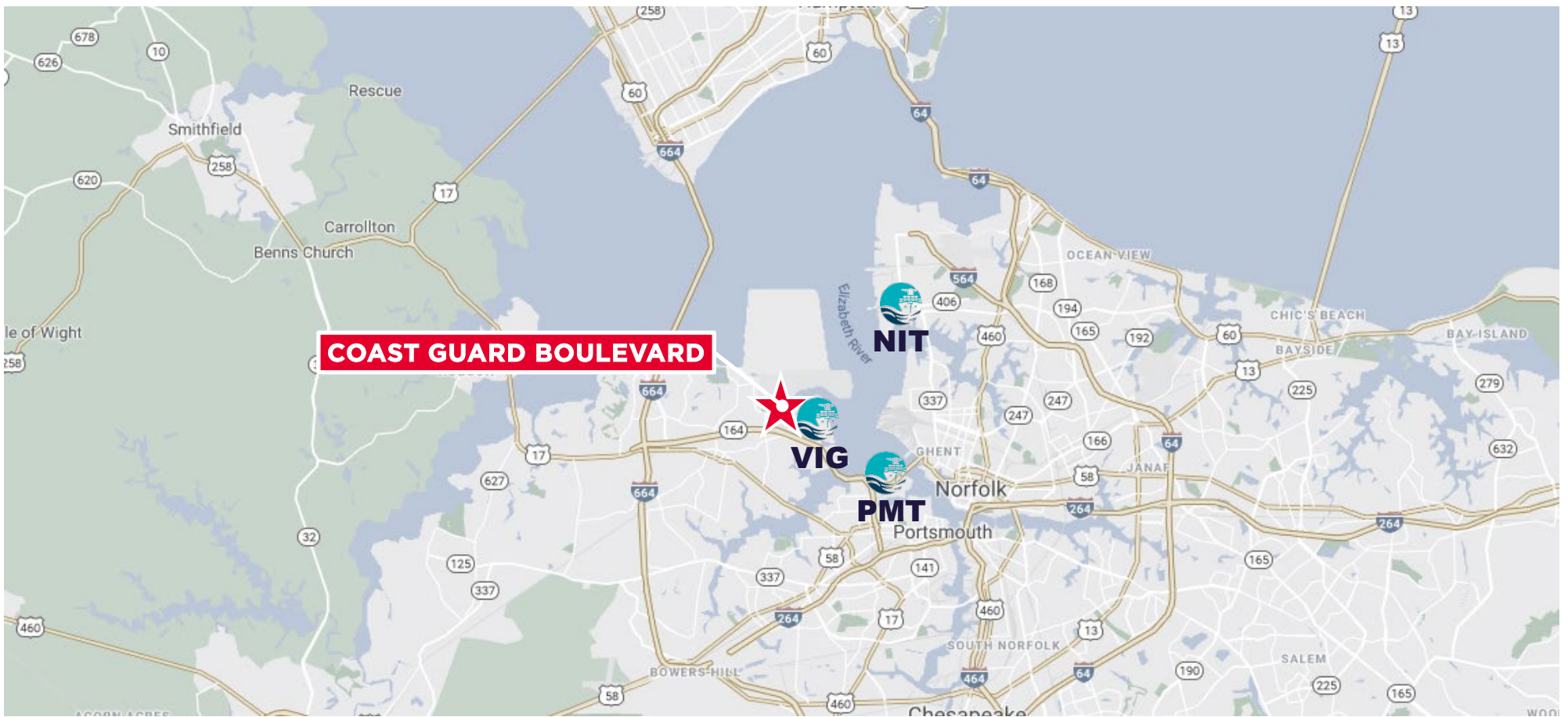

## LOCATION ATTRIBUTES



0.9 Miles  
2 Minutes



4.1 Miles  
5 Minutes



6.2 Miles  
8 Minutes



16.8 Miles  
18 Minutes



0.1 Miles  
< 1 Minute



4.8 Miles  
6 Minutes



10.9 Miles  
17 Minutes



**Immediate  
Access**

To Virginia International  
Gateway Port Terminal



**Unencumbered  
Transit**

No Stoplights From Site  
To Interstate Access



**2/3rds  
Of U.S. Population**

Within One Day's Drive



**Cold Storage  
Development**

Includes Recent  
Completions By  
Lineage And Freezpak



**Foreign Trade  
Zone #20**

Eligible For Additional  
Tax Incentives



**Third Highest  
Concentration Per Capita**

Employed In Coffee / Tea  
Processing In The US



**4,000+  
Military Retirees**

Join Civilian Labor  
Force Each Year



Developed by:



 CUSHMAN &  
WAKEFIELD

THALHIMER

NEWMARK

/// **FOR DRY WAREHOUSE, TRANSLOAD  
AND YARD OPTIONS, CONTACT:**

**GEOFF POSTON, SIOR**

Senior Vice President  
757 650 8437

[geoff.poston@thalhimer.com](mailto:geoff.poston@thalhimer.com)

/// **FOR COLD STORAGE OPTIONS, CONTACT:**

**DAVE ASCHENBRAND**

Executive Managing Director  
973 803 2074

[dave.aschenbrand@nmrk.com](mailto:dave.aschenbrand@nmrk.com)

**ADAM PETRILLO**

Executive Managing Director  
201 315 8569

[adam.petrillo@nmrk.com](mailto:adam.petrillo@nmrk.com)

**GRANT BATES**

Executive Managing Director  
434 882 1176

[grant.bates@nmrk.com](mailto:grant.bates@nmrk.com)

Independently Owned and Operated / A Member of the Cushman & Wakefield Alliance

Cushman & Wakefield | Thalhimer © 2026. No warranty or representation, express or implied, is made to the accuracy or completeness of the information contained herein, and same is submitted subject to errors, omissions, change of price, rental or other conditions, withdrawal without notice, and to any special listing conditions imposed by the property owner(s). As applicable, we make no representation as to the condition of the property (or properties) in question.