

100 NORCROSS STREET

ROSWELL, GA 30075

FOR LEASE



LOCATION DESCRIPTION

New development located within popular Downtown Roswell's booming restaurant/retail district

PROPERTY HIGHLIGHTS

- Please call for availability
- Seeking unique restaurants and entertainment concepts
- Open patio areas and outdoor seating available
- Downtown Roswell's unique blend of pedestrian friendly areas draws patrons from well beyond the Atlanta MSA
- Ample parking onsite and adjacent to the property
- Average Household Incomes exceed \$176,000 within a 1-mile radius



 DEMOGRAPHICS	1 MILE	3 MILES	5 MILES
Population Density	6,661	71,795	191,576
Average HH Income	\$176,305	\$140,949	\$166,056
Daytime Population	11,757	98,440	230,069



ALAN SHAW

alan.shaw@tscg.com
770.955.2434

DREW LEWIS

drew.lewis@tscg.com
770.955.2434

100 NORCROSS STREET

FOR LEASE

100 NORCROSS STREET, ROSWELL, GA 30075

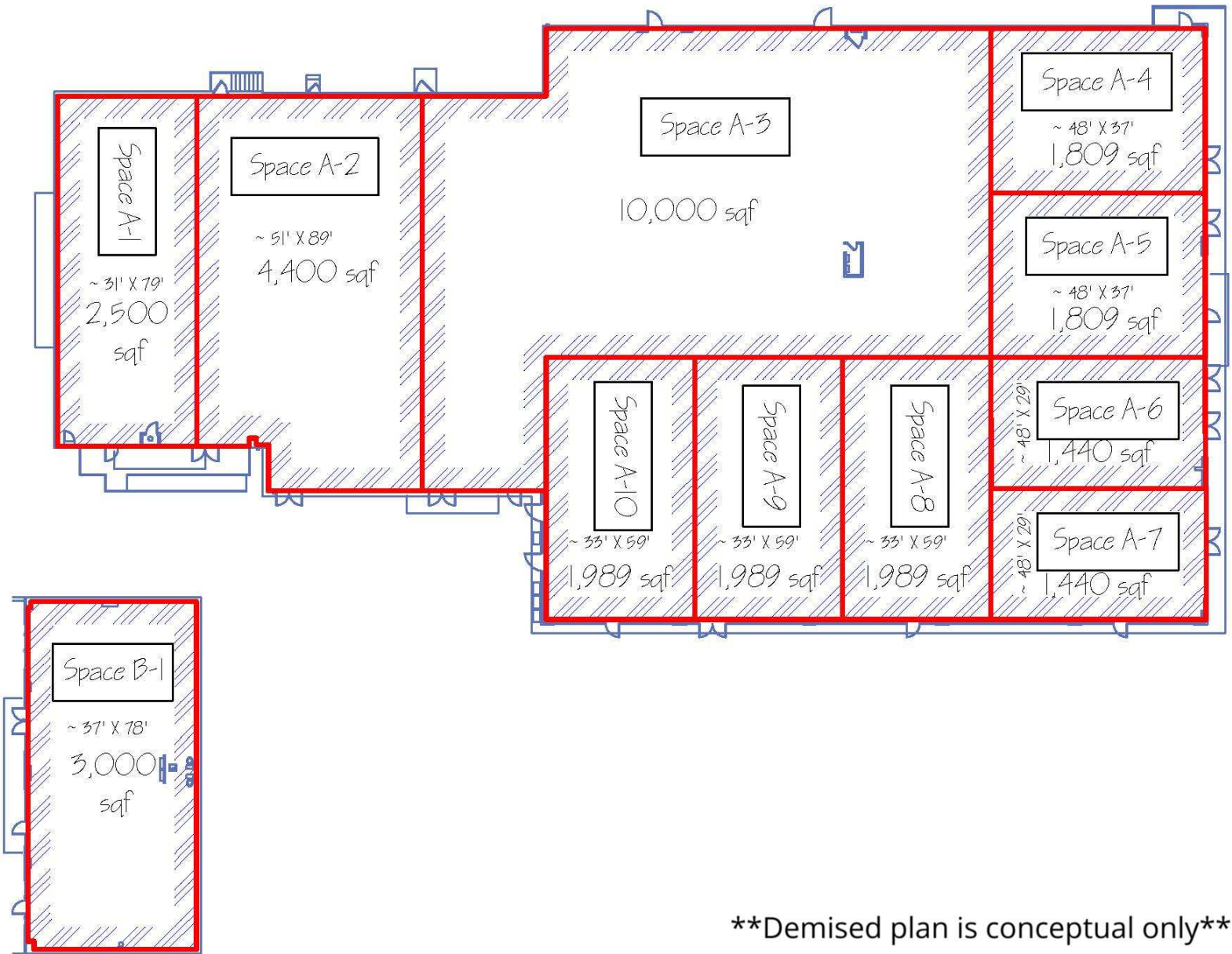

****Demised plan is conceptual only****



ALAN SHAW

alan.shaw@tscg.com
770.955.2434

DREW LEWIS

drew.lewis@tscg.com
770.955.2434

100 Norcross Street

Site Aerial

February 2024

TSCG



A \$30 million boutique hotel is set to rise near Canton Street, a walkable cluster of restaurants and shops in historic downtown Roswell. The 125-room Chambray Hotel could start construction in May, according to the project's general contractor in Swinerton. The five-story hotel would stand at the intersection of Alpharetta Highway and Fraser Street, just north of the Southern Port mixed-use project.



104,000sf Planned Mixed-Use
32,000+sf Restaurants & Fitness Retail
95,000+sf Loft Office Space
with combined 140 MF Units & 12 Townhomes



30,000 SF



0 175 350 Feet Norcross St

© 2024 TSCG. All Rights Reserved. This map was produced using data from private and government sources deemed to be reliable. The information herein is provided without representation or warranty. Logos are for identification purposes and may be trademarks of their respective companies.



Alpharetta St

Norcross St

Frazier St

Downtown Roswell

Restaurant Aerial

July 2023

TSCG



104,000sf Planned Mixed-Use
32,000+sf Restaurants & Fitness Retail
95,000+sf Loft Office Space
with combined 140 MF Units & 12 Townhomes

30,000sf

SITE

Overflow Parking

© 2023 TSCG. All Rights Reserved. This map was produced using data from private and government sources deemed to be reliable. The information herein is provided without representation or warranty. Logos are for identification purposes and may be trademarks of their respective companies.