

FOR LEASE OR SALE
4875 Baldwin Street
The Bronx, New York



21,000 SF BUILDING ON 33,750 SF PLOT

ENTIRE 1 STORY BUILDING
ZONED M1-1



PROPERTY FEATURES



21,500 SF

TOTAL BUILDING SIZE

5

LOADING DRIVE-INS

33,750 SF

PLOT SIZE

3,400 Amps

ELECTRIC

1,000 SF

OFFICE

16'

CEILING HEIGHT

M1-1

ZONING

PROPERTY SITE PLAN

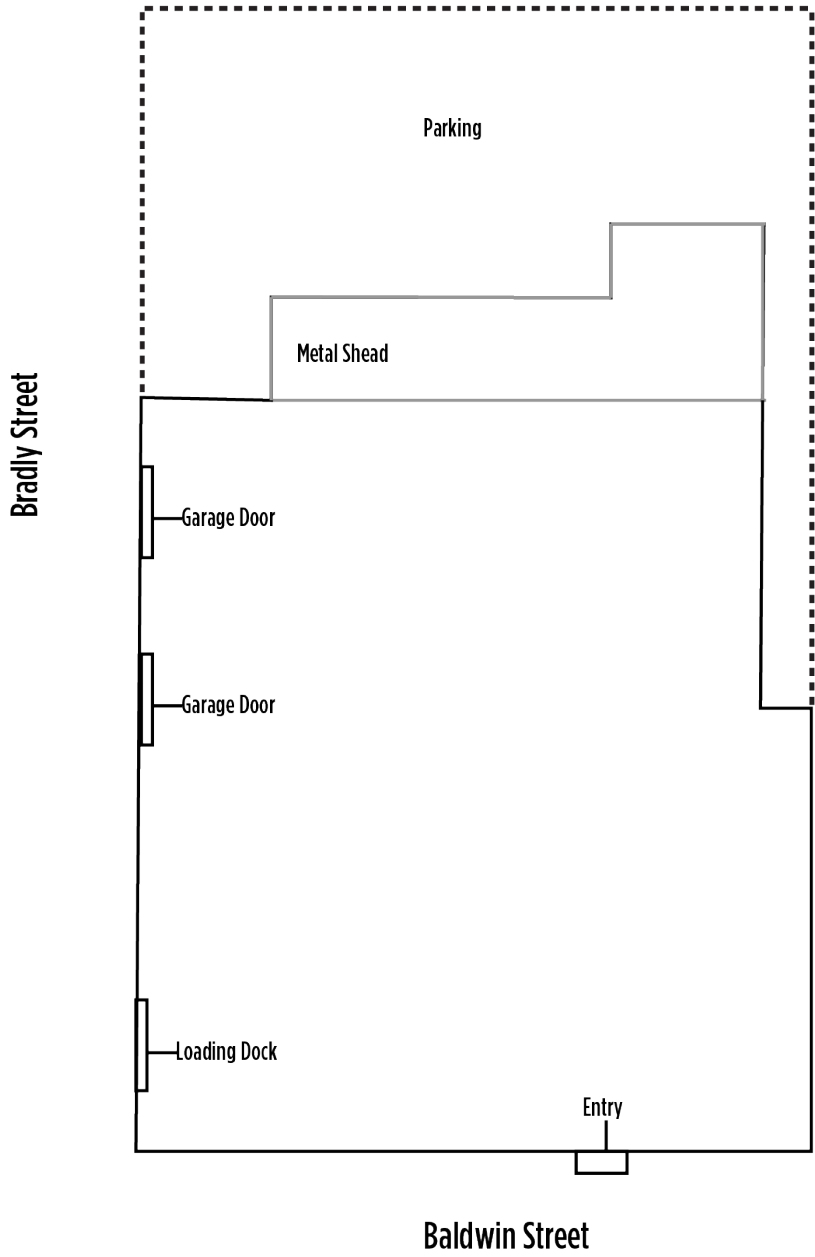

PROPERTY AERIAL MAP

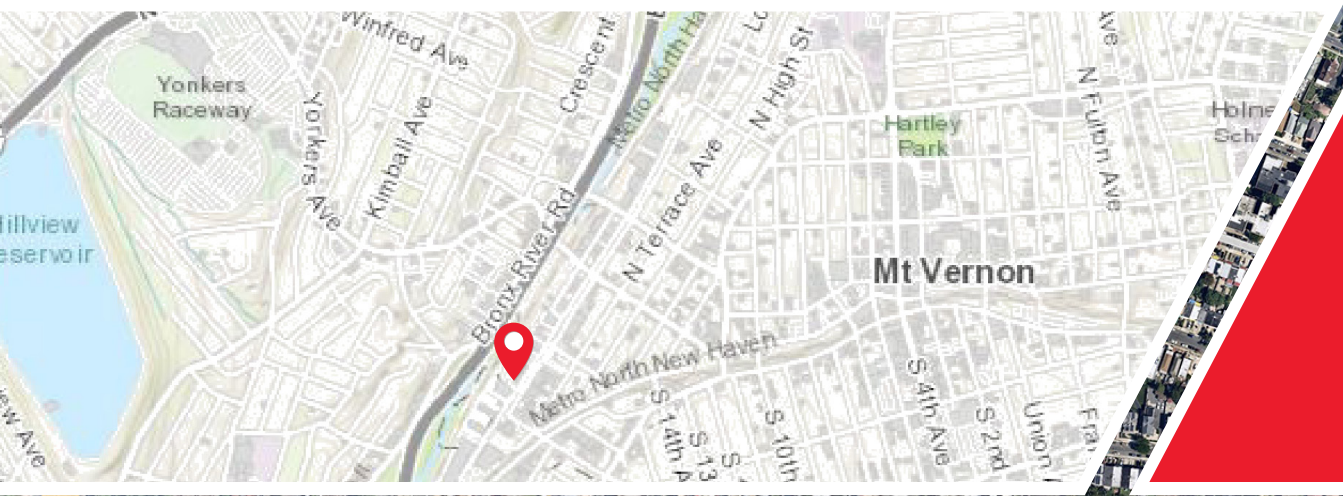
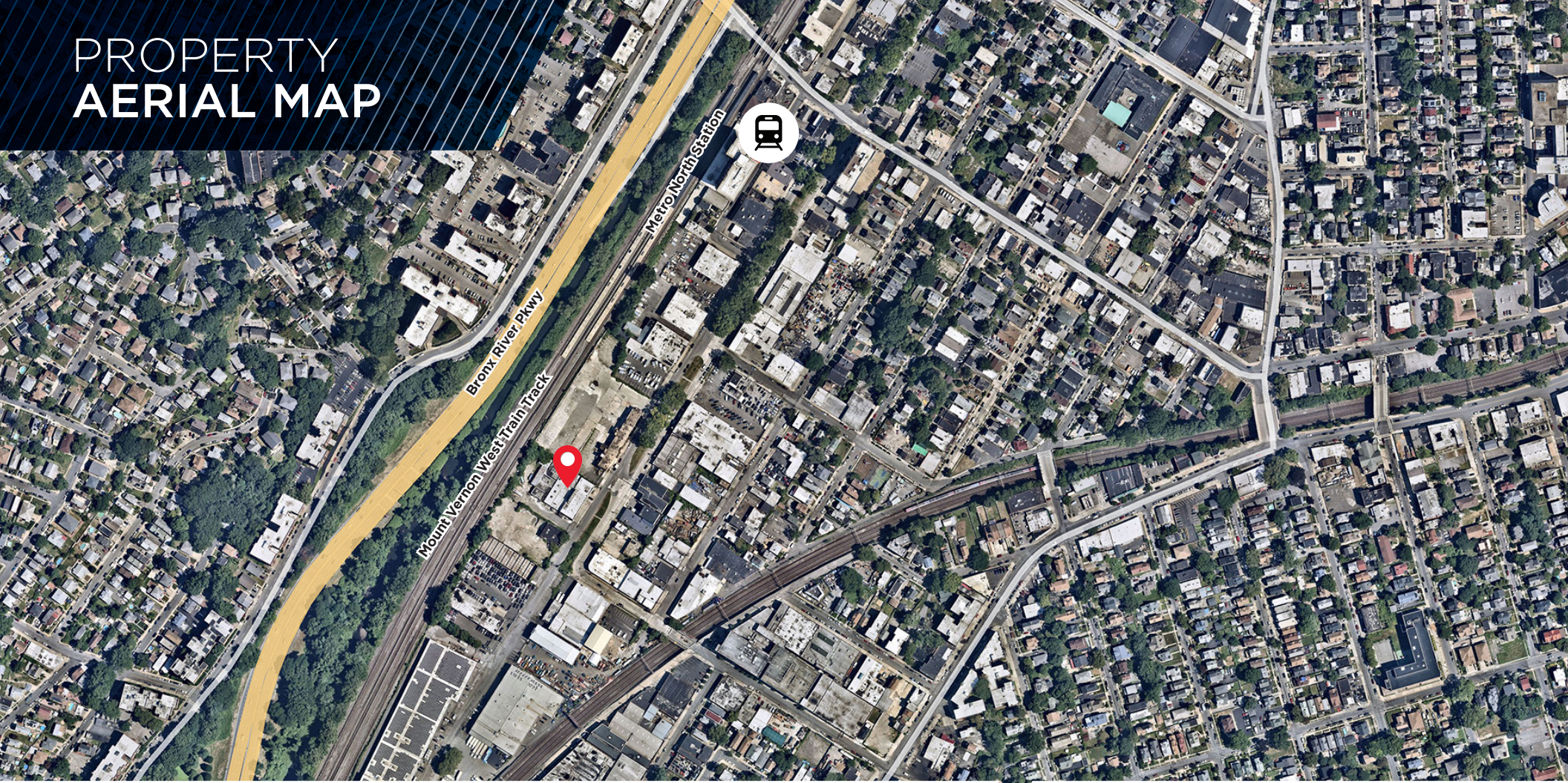

Ideally located near many major roadways and public transportation

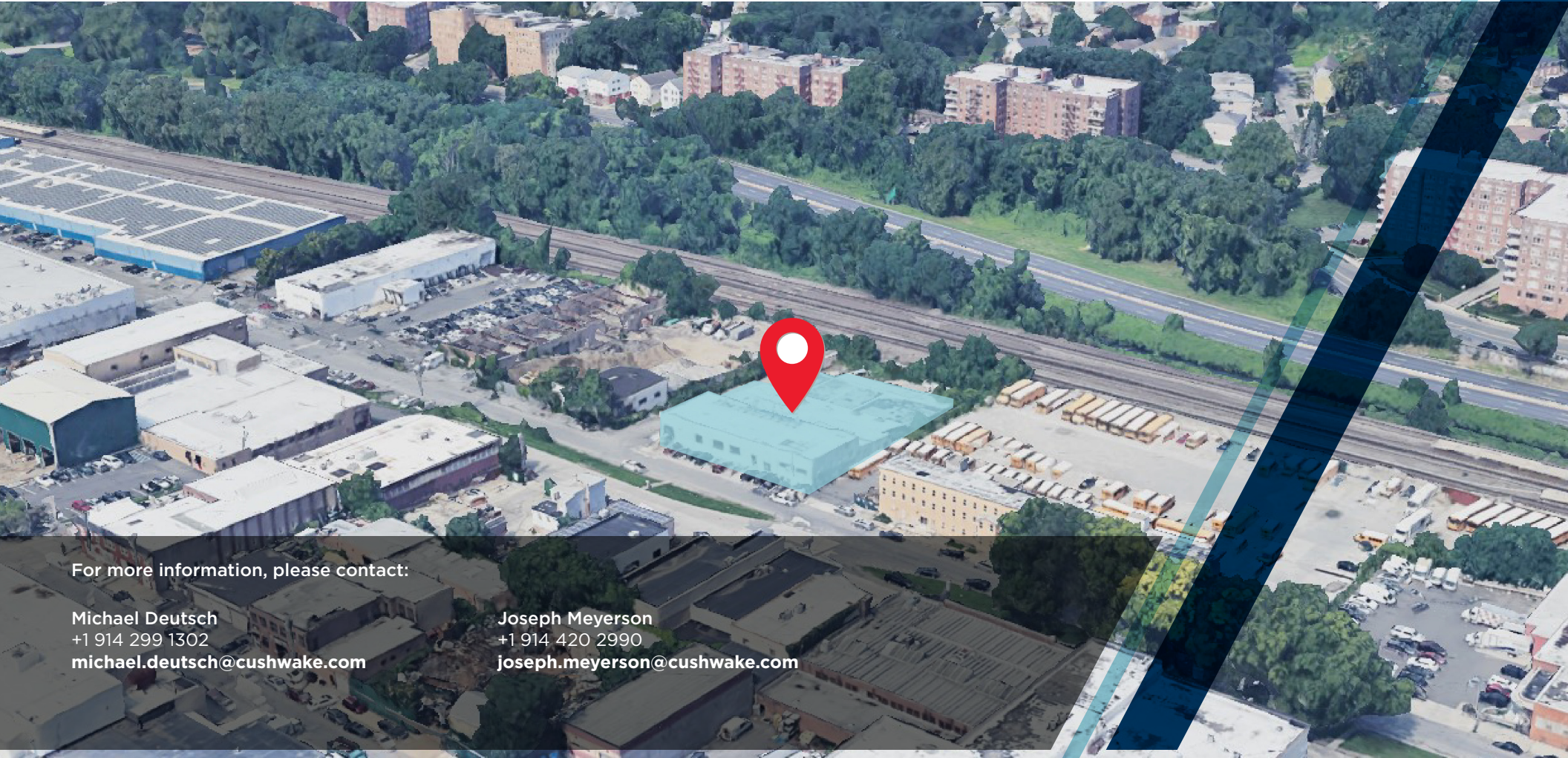

For more information, please contact:

Michael Deutsch
+1 914 299 1302
michael.deutsch@cushwake.com

Joseph Meyerson
+1 914 420 2990
joseph.meyerson@cushwake.com