



FOR LEASE – 15,226 SF Free Standing Warehouse

7818 Depot Lane, Tampa, FL 33637

Dock High and Grade Level – Near I4 Corridor – East Tampa

Robbie Lober, SIOR
Managing Member
727 999 1806

Robbie@Loberrealestate.com

Devin Beeler, CPA
Senior Associate
727 709 2179

Devin@Loberrealestate.com

LOBER
REAL ESTATE INVESTMENTS AND LEASING

Property Overview

Google Maps Link: [Click Link Here!](#)

Address: 7818 Depot Ln, Tampa, FL 33637

Size Available: 15,226 SF (2,123 SF of newly renovated office)

Year Built 1985

Availability: NOW!

Loading: 2 (14'x12') grade level doors
2 (14'x12') dock high doors

Power: 600 amps 480 volts 3 phase

Clear Height: 22 feet

Zoning: "M" – Manufacturing

County / Submarket: Hillsborough / East Tampa

Lot Size: 0.85 acres

Location: 301 Industrial Park - 2 miles from I-4

Construction: Metal with steel frame

Outdoor Storage: Fenced and secured outdoor storage in the rear of property with one (1) 14'x14' roll up door offering direct access into the warehouse



Quick Access to Hwy 301, I-4, I-275, I-75, Port of Tampa Bay, and Tampa International Airport

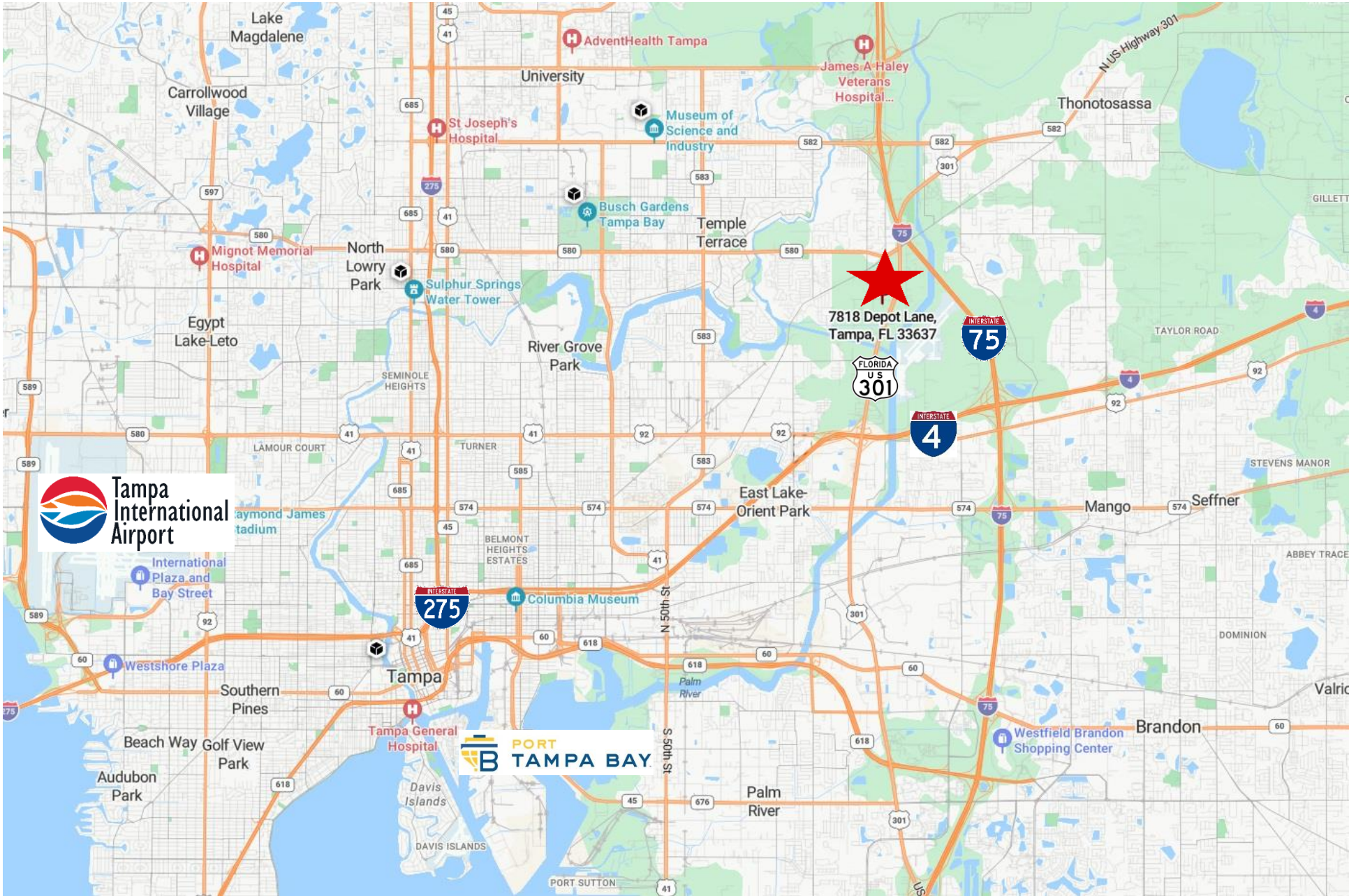

Floor Plan

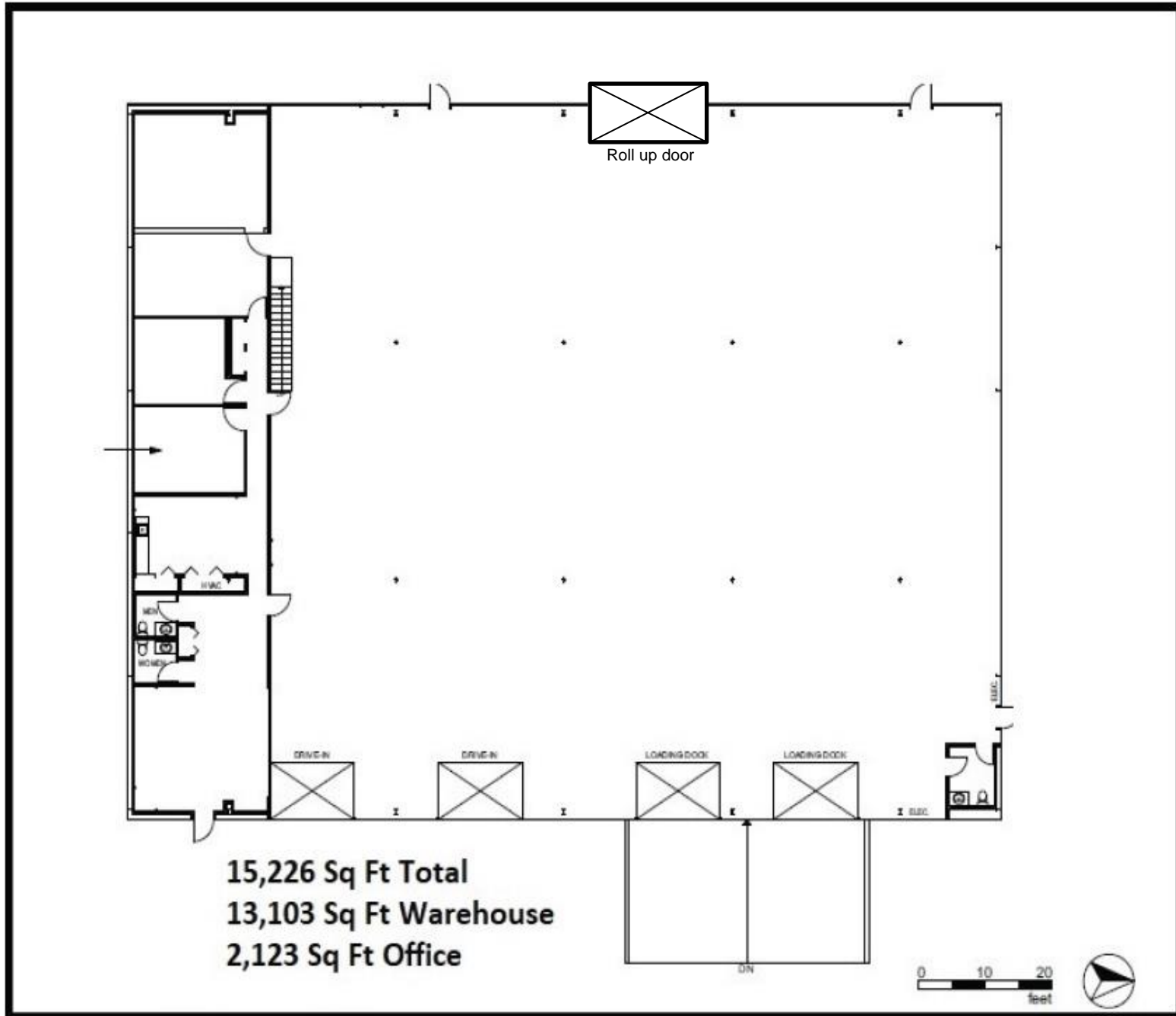

Property Photos





Contact for pricing and more info:

Robbie Lober, SIOR
Managing Member
727 999 1806
Robbie@Loberrealestate.com

Devin Beeler, CPA
Senior Associate
727 709 2179
Devin@Loberrealestate.com

LOBER
REAL ESTATE INVESTMENTS AND LEASING

The information contained in this document has been obtained from sources believed reliable. While Lober Real Estate LLC does not doubt its accuracy, Lober Real Estate LLC has not verified it and makes no guarantee, warranty, or representation about it. It is your responsibility to independently confirm its accuracy and completeness. Any projections, opinions, assumptions, or estimates used are for example only and do not represent the current or future performance of the property. The value of this transaction to you depends on tax and other factors which should be evaluated by your tax, financial, and legal advisors. You and your advisors should conduct a careful, independent investigation of the property to determine to your satisfaction the suitability of the property for your needs.