

Apex Center of New England

Boston Post Rd. West, Marlborough, MA

5,000 SF Available



Overview

Featuring impressive architecture and unmatched functionality, the 500,000 SF Apex Center of New England stands as the premier destination for retailers and professional service providers in the **I-495/Mass Pike/I-290 corridor**. As a world-class interactive entertainment hub, it drives **substantial foot traffic**, provides **ample parking**, and offers **high visibility frontage**. This vibrant retail environment is complemented by premium accommodations, including **Hyatt Place** and **Fairfield Inn**, as well as a diverse range of dining options, such as **110 Grill**, **Evviva Trattoria**, **Chick-fil-A**, and **Starbucks**.

Now Available: A prime retail space of 5,000 SF at 43A Apex Drive, Space 10A is now available. This attractive location is opposite Chick-fil-A and Apex Entertainment Center, offering an ideal setting for your business in this thriving hub.

Apex Center of New England

Boston Post Road West | Marlborough, MA

Space 10A - 5,000 SF Available

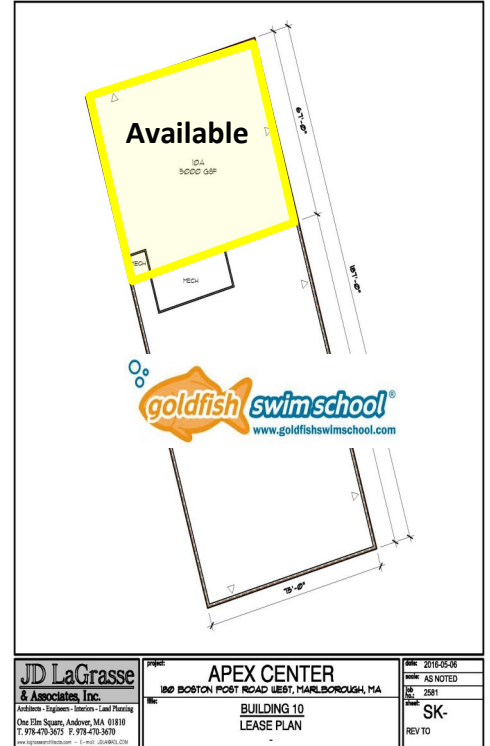

Features

- Former Title Boxing
- Adjacent to Goldfish Swim School
- Great visibility on Route 20
- Endcap
- 5,000 SF
- Ample Parking

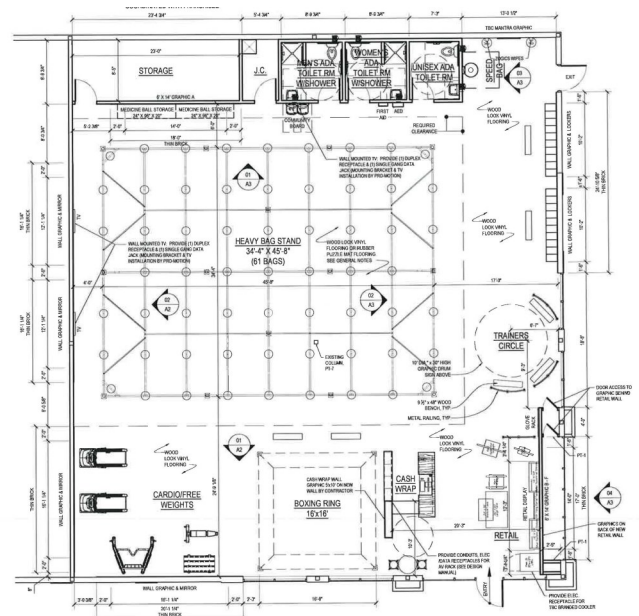

Apex Center of New England

Boston Post Road West | Marlborough, MA

Retail Market



| 2024 Demographics | 1 Mile | 3 Miles | 5 Miles | 10 Miles |
|------------------------------------|-----------|-----------|-----------|-----------|
| Estimated Population | 3,714 | 36,138 | 92,472 | 338,120 |
| Estimated Daytime Population | 11,527 | 33,106 | 69,755 | 181,996 |
| Estimated Households | 1,528 | 14,059 | 36,276 | 128,934 |
| Estimated Average Household Income | \$129,346 | \$125,180 | \$130,368 | \$143,420 |

