

# ***2300 S Michigan***

***4,500 SF | Divisible to 2,250 SF***

LOCATED STEPS FROM  
MCCORMICK PLACE, THE CERMAK  
GREEN LINE, WINTRUST ARENA,  
MULTIPLE HOTELS &  
RESTAURANTS

FIRST-FLOOR RETAIL SPACE PERFECT FOR  
MEDICAL OFFICES, FOOD SERVICE, OR  
COFFEE SHOPS

***No Motor Row***  ***Like Chicago's***

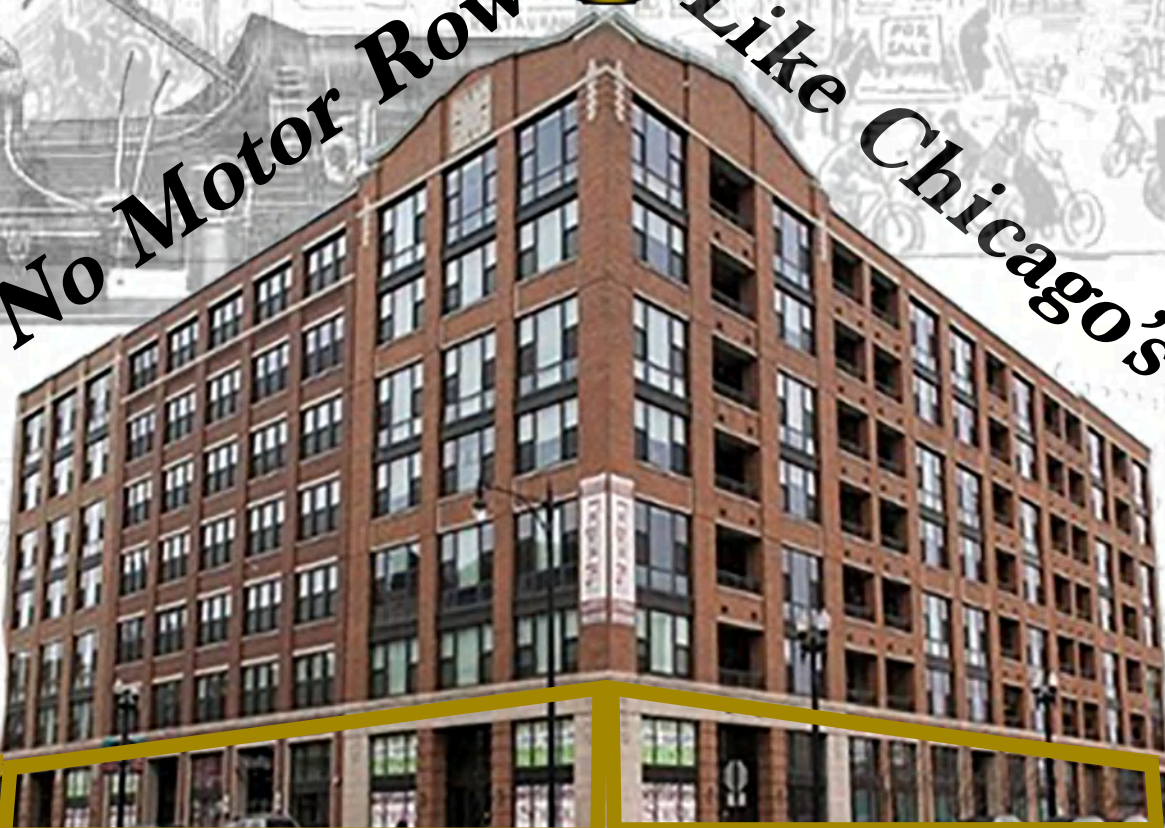



# DEMOGRAPHIC INFORMATION

Population (1 mile): 46, 172

Average household size: 2

Average age: 39

Med. household income: \$68,255

Population by Age:

<20: 21%

20-34: 23%

35-49: 24%

50-64: 18%

65+: 14%

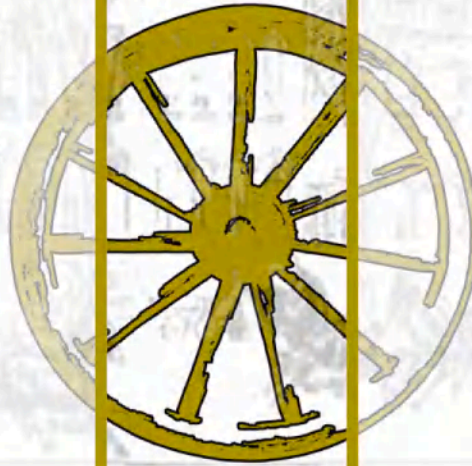

# NEARBY

- Starbucks Coffee
- Chess Records
- Fatpour Tap Works
- Bank of America
- Pizano's
- Reggie's Chicago

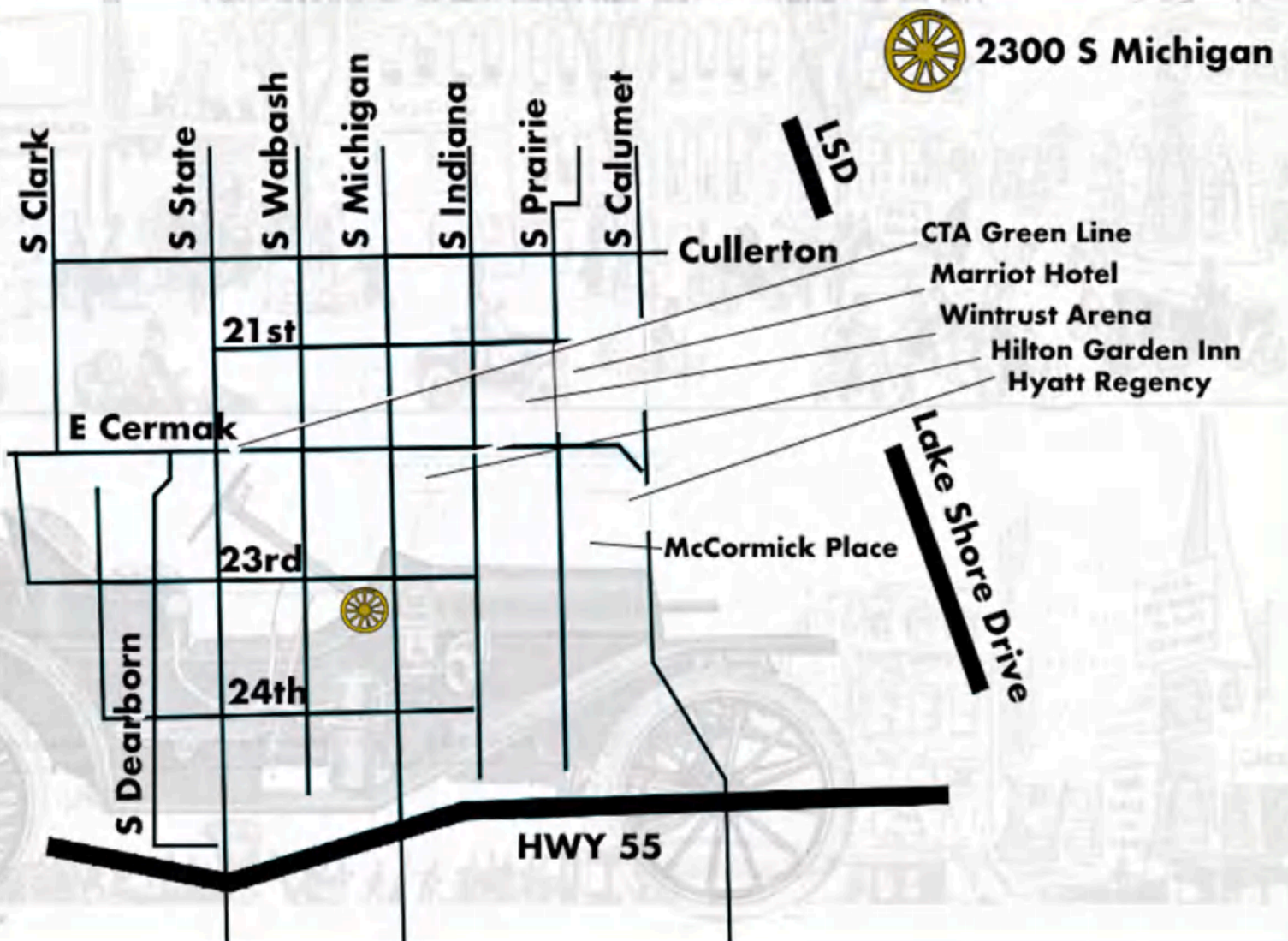



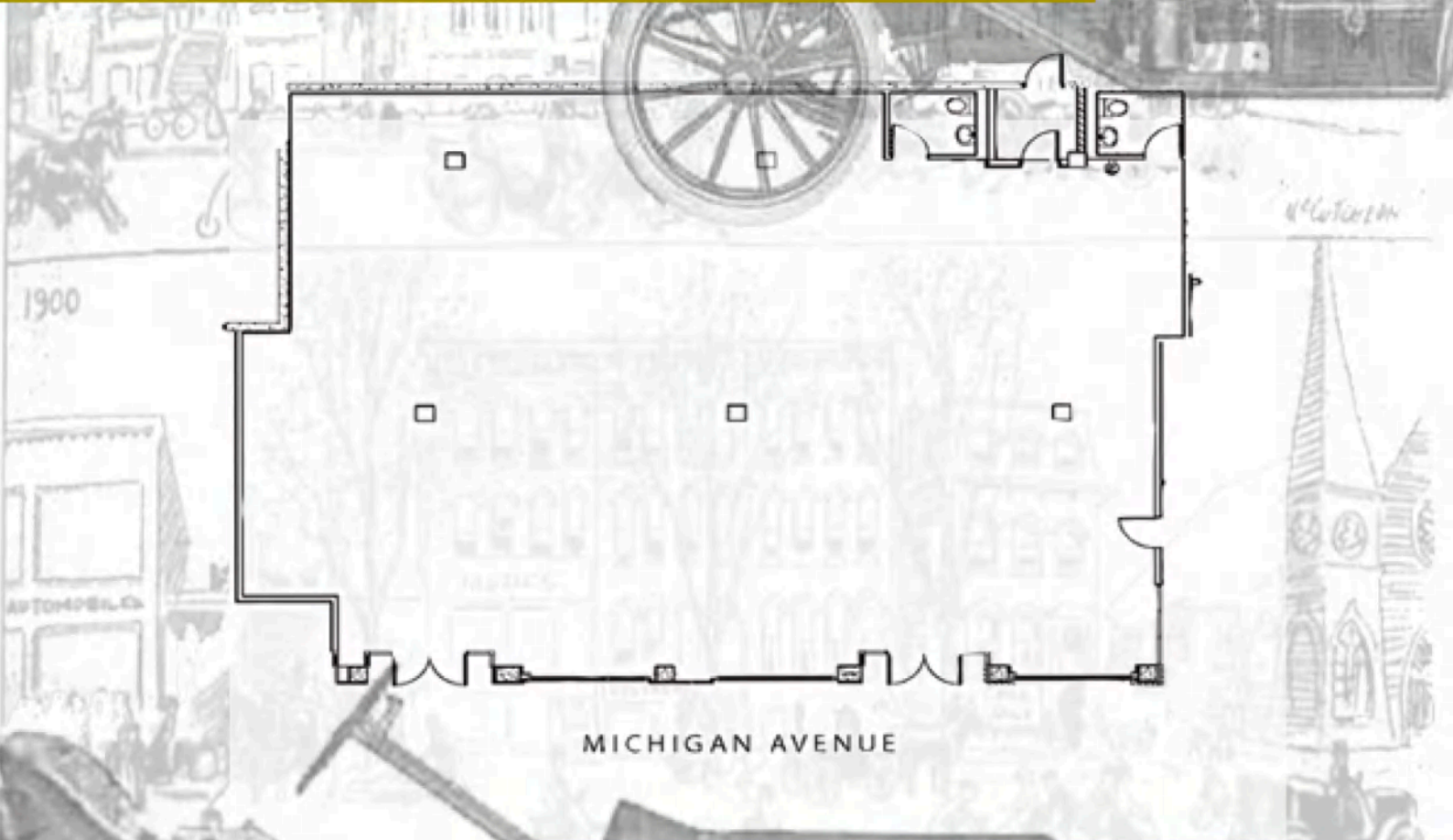

JONATHAN ZIMMERMAN | [JZIMMERMAN@WILLARDJONES.COM](mailto:JZIMMERMAN@WILLARDJONES.COM) | 312.263.8787 | [WILLARDJONES.COM](http://WILLARDJONES.COM)

