

# CAFÉ SPACE

1333 14TH ST, NW  
Washington, DC  
14<sup>th</sup> Street/Logan Circle



## FOR LEASE

Relet Café Space  
in the heart of 14<sup>th</sup> Street

AVAILABILITY | **VACANT/IMMEDIATE**

SPACE | **2,968 SF**

RENT | **\$80.00 per SF, NNN**

### LOCATION

- Highly visible location near the intersection of 14th Street and Rhode Island Avenue
- Proximity the Logan circle and Thomas Circle; residential, hotel and office population
- Busy retail block with Jinya, Amelie DC, Takara 14, Joybird and Churchkey

### SPACE

- Beautifully renovated historic building
- Large open 25ft wide space with tall exposed ceilings and brick walls
- Two large skylight add natural light to the back portions of the space
- Former café space (non-vented) in excellent condition with the improvements in place
- Operable storefront
- Streatery available as well
- Fathom Gallery, a corporate event and wedding venue, located on the upper floors



**J STREET**  
COMMERCIAL

CONTACT  
**Anastasia Kharchenko**  
703.587.6290  
ak@jstcommercial.com

# CAFÉ SPACE

1333 14TH ST, NW  
Washington, DC  
14<sup>th</sup> Street/Logan Circle

## EXTERIOR PHOTOS



# CAFÉ SPACE

1333 14TH ST, NW  
Washington, DC  
14<sup>th</sup> Street/Logan Circle

## FLOOR PLAN

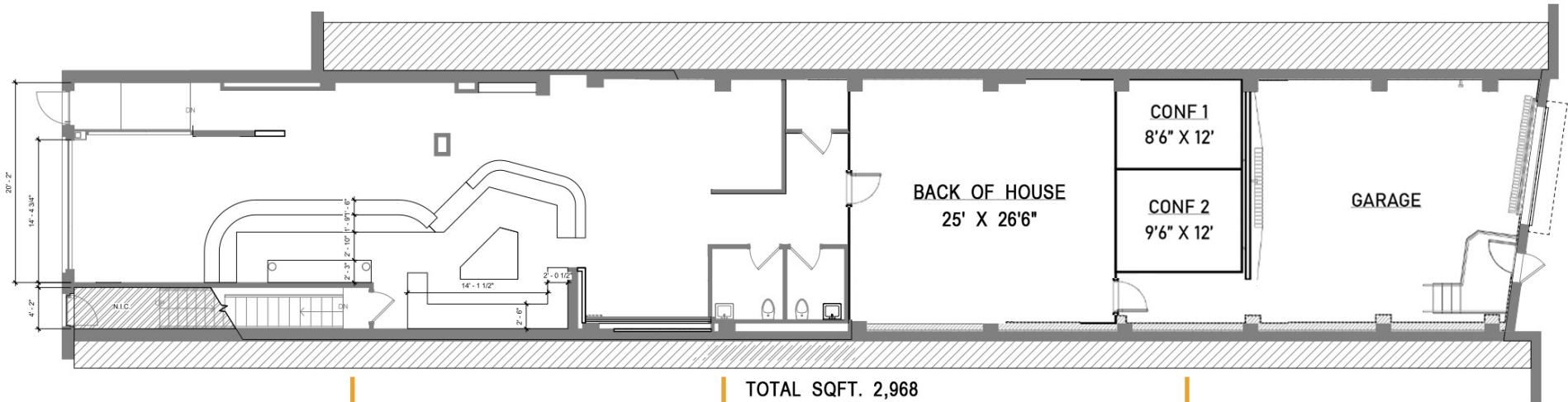

TOTAL SQFT. 2,968



The information above was furnished to us by sources we believe to be reliable but no warranty or representation is made to its accuracy. It is your responsibility to independently confirm its accuracy and completeness as this offering is subject to correction or errors and omissions, change of pricing, prior to sale, lease or withdrawal from the market, without notice.



CONTACT  
**Anastasia Kharchenko**  
703.587.6290  
ak@jstcommercial.com

# CAFÉ SPACE

1333 14TH ST, NW  
Washington, DC  
14<sup>th</sup> Street/Logan Circle

## INTERIOR PHOTOS



The information above was furnished to us by sources we believe to be reliable but no warranty or representation is made to its accuracy. It is your responsibility to independently confirm its accuracy and completeness as this offering is subject to correction or errors and omissions, change of pricing, prior to sale, lease or withdrawal from the market, without notice.



**J STREET**  
COMMERCIAL

**CONTACT**  
**Anastasia Kharchenko**  
703.587.6290  
[ak@jstcommercial.com](mailto:ak@jstcommercial.com)

# CAFÉ SPACE

1333 14TH ST, NW  
Washington, DC  
14<sup>th</sup> Street/Logan Circle

## INTERIOR PHOTOS

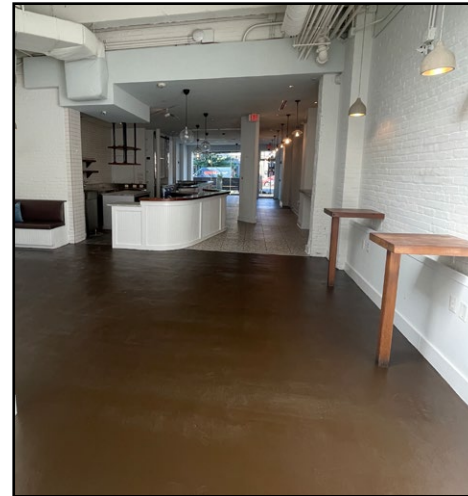

The information above was furnished to us by sources we believe to be reliable but no warranty or representation is made to its accuracy. It is your responsibility to independently confirm its accuracy and completeness as this offering is subject to correction or errors and omissions, change of pricing, prior to sale, lease or withdrawal from the market, without notice.



CONTACT  
**Anastasia Kharchenko**  
703.587.6290  
[ak@jstcommercial.com](mailto:ak@jstcommercial.com)

# CAFÉ SPACE

**1333 14TH ST, NW**  
Washington, DC  
14<sup>th</sup> Street/Logan Circle

## LOCATION MAP

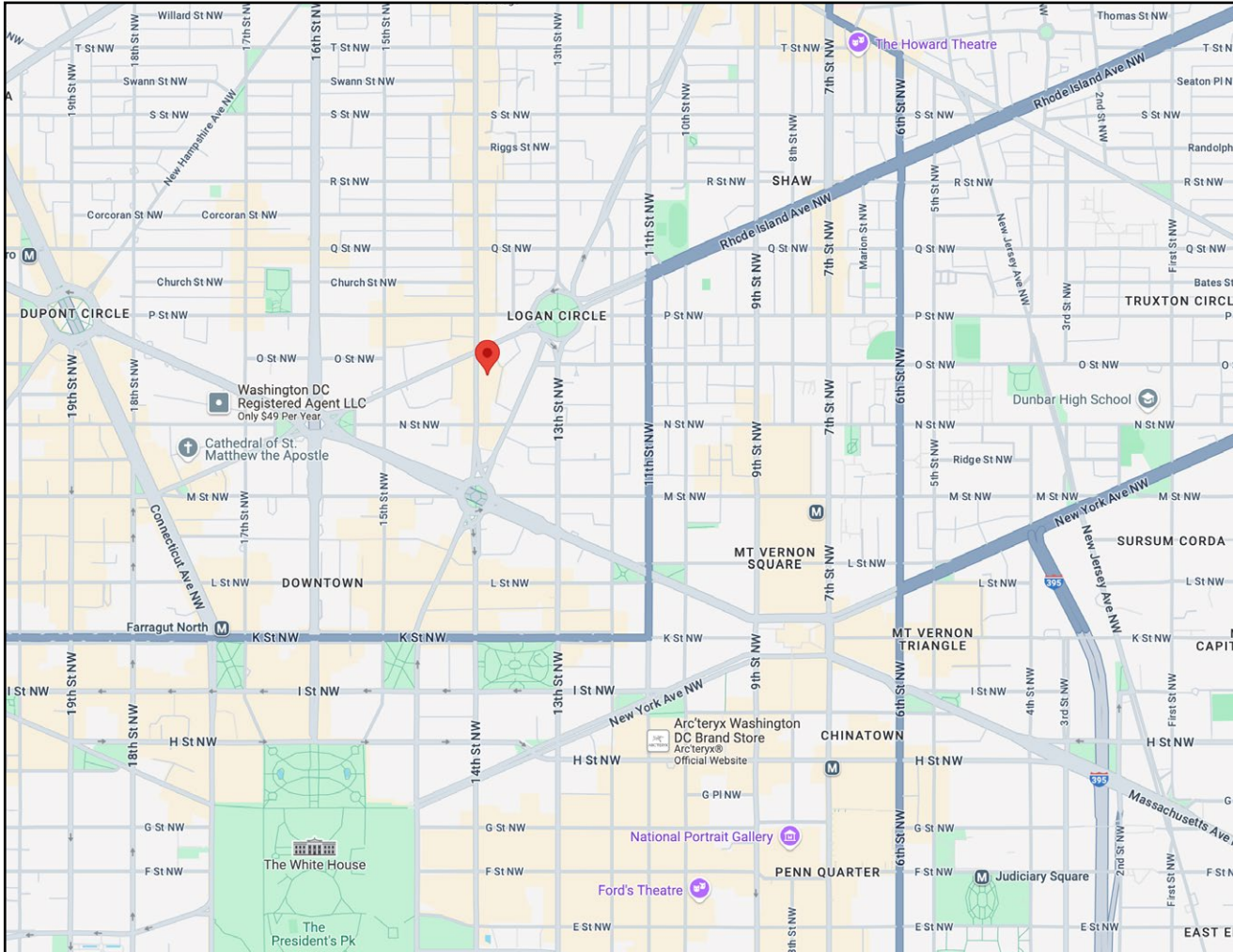

The information above was furnished to us by sources we believe to be reliable but no warranty or representation is made to its accuracy. It is your responsibility to independently confirm its accuracy and completeness as this offering is subject to correction or errors and omissions, change of pricing, prior to sale, lease or withdrawal from the market, without notice.



**CONTACT**  
**Anastasia Kharchenko**  
703.587.6290  
ak@jstcommercial.com