

1500 N. LOCUST GROVE RD MERIDIAN | IDAHO

FOR SUB-LEASE



Space Available	Suite 103 - 3,204 SF
Building Size	8,180 SF
Sublease Rate	\$15.92 PSF + NNN
Lease Expiration	December 31, 2027
Availability	Negotiable
Zoning	Meridian C-G
Parking	Agreement in place
Agent Showing	Contact agent

Property Highlights

- Retail/Flex Opportunity at the signalized corner of Locust Grove Rd and Fairview Ave
- Located close to residential and commercial
- Building offers excellent visibility and signage opportunities
- Suite consists of one private office, two restrooms, open space, and roll up door on the back of space
- Established boxing academy as current tenant

1500 N. LOCUST GROVE RD MERIDIAN | IDAHO

FOR SUB-LEASE



1500 N. LOCUST GROVE RD MERIDIAN | IDAHO

FOR SUB-LEASE

Floor Plan

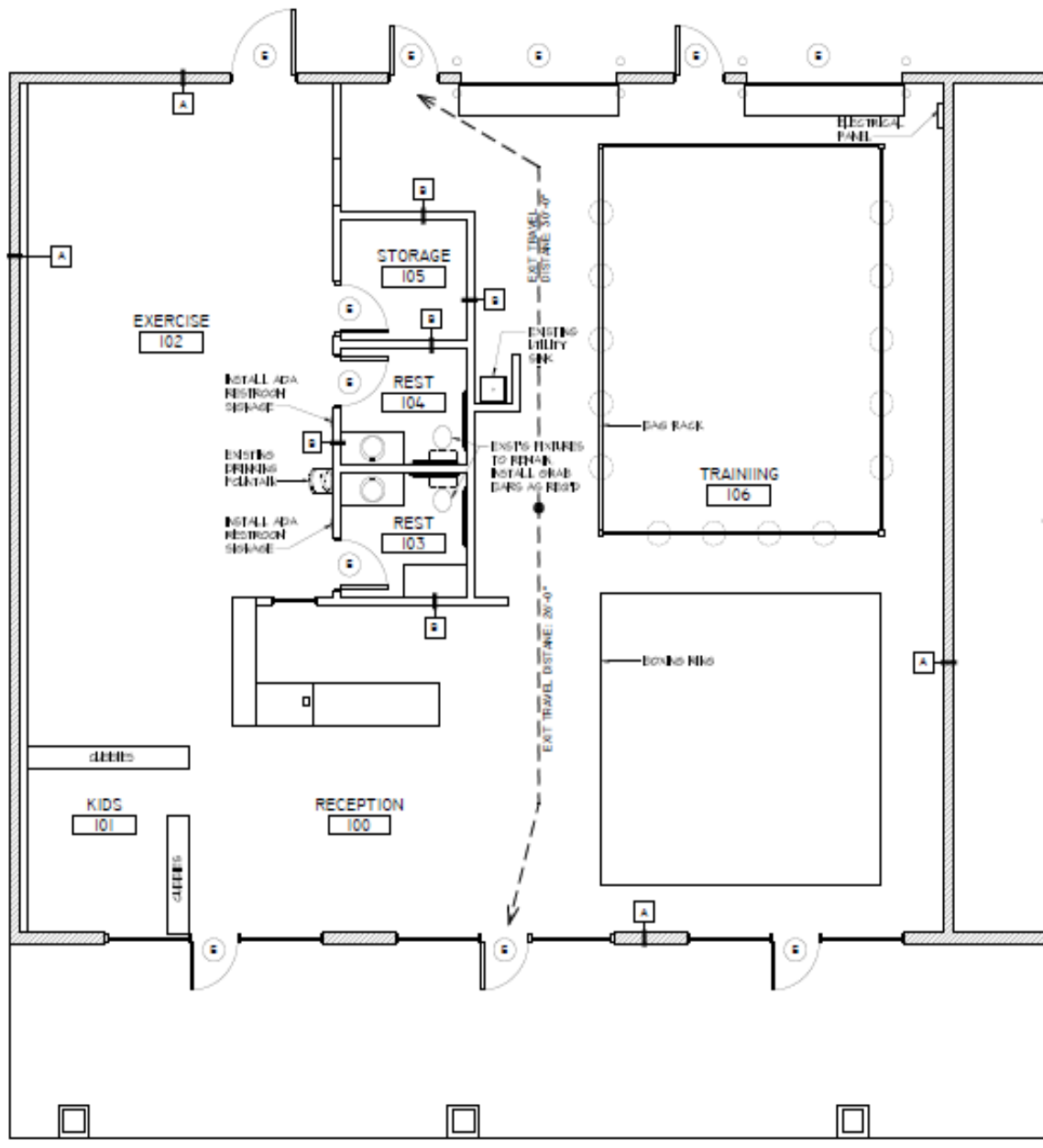

1500 N. LOCUST GROVE RD MERIDIAN, IDAHO

FOR SUB-LEASE

