

2304 Eastwood Drive (Route 47)

Woodstock, IL 60098

For Lease

MLS #12205987

INDUSTRIAL



INDUSTRIAL SPACE 2,100 SF

\$1,925/MO. \$11. PSF (GROSS)

INDUSTRIAL SPACE

2,100 SF

2,100 SF clean warehouse space with heavy 800 amp, 3 phase power, one bath, one 10'x12' DID, small mezzanine storage area and 16' ceilings.

Located in this 18,532 SF multi-tenant building on busy Route 47 across from Harley Davidson.

\$1,925/mo. gross lease with CAM and taxes included. Tenant responsible for utilities.

Specifications

Building Size:	18,532 SF
Year Built:	2003
Office Size:	None
HVAC System:	Ceiling Hung GFA
Electrical:	800 amp, 3 phase
Sprinklers:	Yes
Washrooms:	1 ADA
Ceiling Height:	16 ft
Parking:	23 (common)
DID's:	1 (10'x12')
Sewer/Water:	City
Zoning:	M1
Utilities:	Tenant Responsible
CAM & Taxes	Included
PIN #:	13-17-427-003

[CLICK HERE TO VIEW OUR WEBSITE](#)

No warranty or representation is made as to the accuracy of the foregoing information. Terms of sale or lease and availability are subject to change or withdrawal without notice. This document is for information purposes only. No offer of sub-agency is being made.



www.PremierCommercialRealty.com | 847.854.2300 | 9225 S. Route 31, Lake in the Hills, IL 60156

VP / Designated Managing Broker

Heather Schweitzer

HeatherS@PremierCommercialRealty.com

O: 847.854.2300 x15 C: 815.236.9816

2304 Eastwood Drive (Route 47)
Woodstock, IL 60098

For Lease

INDUSTRIAL

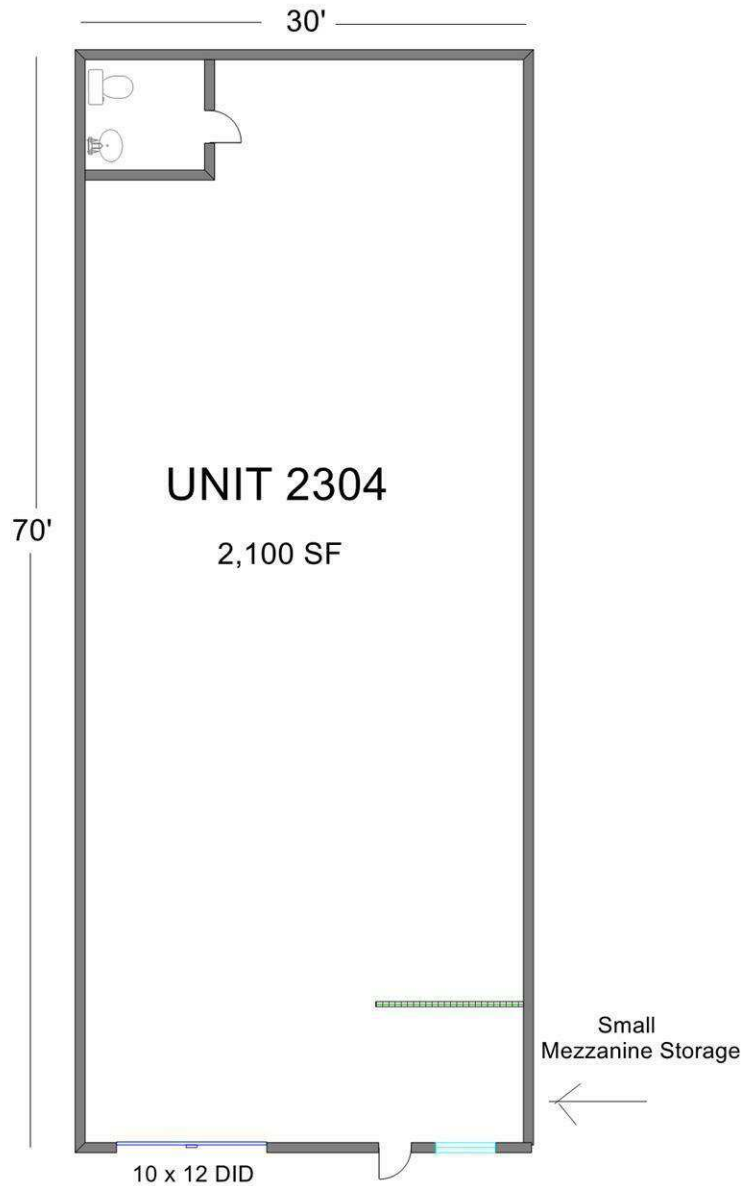

[CLICK HERE TO VIEW OUR WEBSITE](#)

No warranty or representation is made as to the accuracy of the foregoing information. Terms of sale or lease and availability are subject to change or withdrawal without notice. This document is for information purposes only. No offer of sub-agency is being made.



www.PremierCommercialRealty.com | 847.854.2300 | 9225 S. Route 31, Lake in the Hills, IL 60156

VP / Designated Managing Broker
Heather Schweitzer
HeatherS@PremierCommercialRealty.com
O: 847.854.2300 x15 C: 815.236.9816