

INDUSTRIAL FOR SUBLEASE 10800 HANNA ST

Beltsville, MD 20705

Available: 2,500 SF



LISTING DATA

AVAILABLE SF: 2,500 SF
TERM: 11/1/2024 - 3/3/2026

ECONOMIC DATA

LEASE RATE: Call For Info

PROPERTY INFORMATION

COUNTY: Prince George's

BUILDING DATA

TOTAL BUILDING SF: 148,434 SF
YEAR BUILT: 1987
ZONING: IH

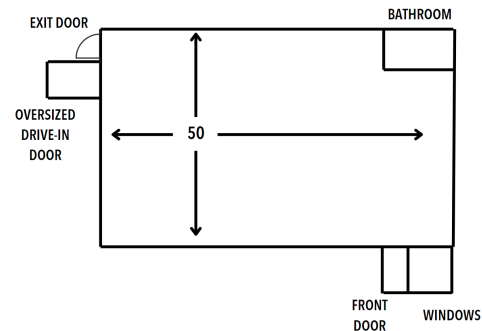

PROPERTY OVERVIEW

Discover a prime subleasing opportunity at 10800 Hanna St, Beltsville, MD. This modern property offers customizable spaces, ample parking, and high visibility. With contemporary design and sustainable features, it's the ideal foundation for business success.

Kate Jordan, SIOR
Principal
410.336.5314
kjordan@lee-associates.com

Samantha Eckels
Associate
443.741.4047
seckels@lee-associates.com

All information furnished regarding property for sale, rental or financing is from sources deemed reliable, but no warranty or representation is made to the accuracy thereof and same is submitted to errors, omissions, change of price, rental or other conditions prior to sale, lease or financing or withdrawal without notice. No liability of any kind is to be imposed on the broker herein.