

# WINDOLPH PLAZA

1020 NW 6th St, Deerfield Beach, FL 33442



COMMERCIAL BROKERAGE AND PROPERTY MANAGEMENT

For Lease



## BULLETS HEADLINE

- 7,415 +/- SF of Flex/Industrial Space available for lease
- Approx. 40% Warehouse & 60% Office
- Base Rent at \$16.00 NNN
- CAM \$9.45
- 1 dock high door
- 1 grade level door
- 100% HVAC
- PID (Planned Industrial District)
- Strategically located on the west side of I-95 and 0.5 miles north of W Hillsboro Blvd.
- Frontage on I-95
- Available February 1, 2025.
- 3Ph power w/ 225 amps.
- 20' clear height.

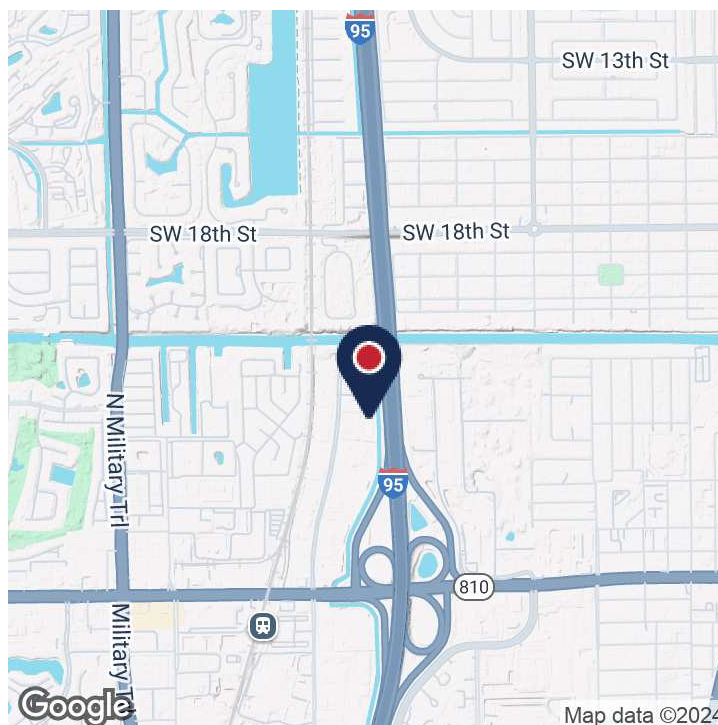

**Keith R. Graves, CCIM, SIOR**  
Senior Vice President  
954.652.2031  
kgraves@bergercommercial.com

**Daniel Forman**  
Sales Associate  
954.652.2004  
dforman@bergercommercial.com

**Jonathan Thiel**  
Senior Vice President  
954.652.2020  
jthiel@bergercommercial.com

# WINDOLPH PLAZA

1020 NW 6th St, Deerfield Beach, FL 33442



COMMERCIAL BROKERAGE AND PROPERTY MANAGEMENT

For Lease



COMMERCIAL BROKERAGE AND PROPERTY MANAGEMENT

**Keith R. Graves, CCIM, SIOR**  
Senior Vice President  
954.652.2031  
kgraves@bergercommercial.com

**Daniel Forman**  
Sales Associate  
954.652.2004  
dforman@bergercommercial.com

**Jonathan Thiel**  
Senior Vice President  
954.652.2020  
jthiel@bergercommercial.com

Berger Commercial Realty Corp. | [bergercommercial.com](http://bergercommercial.com)

550 S. Andrews Avenue Suite 400, Ft. Lauderdale, FL 33301 | P: 954.358.0900 • F: 954.358.0901 | 2240 Woolbright Road, Suite 300, Boynton Beach, FL, 33426 | P: 561.613.0900 F: 561.877.8363

Information furnished regarding this property is from sources deemed reliable, but no warranty or representation as to the accuracy thereof and it is submitted subject to errors, omissions, prior sale, lease or withdrawal without prior notice.

# WINDOLPH PLAZA

1020 NW 6th St, Deerfield Beach, FL 33442



COMMERCIAL BROKERAGE AND PROPERTY MANAGEMENT

## Floor Plans

### **BAY A**

For illustration purposes only\*

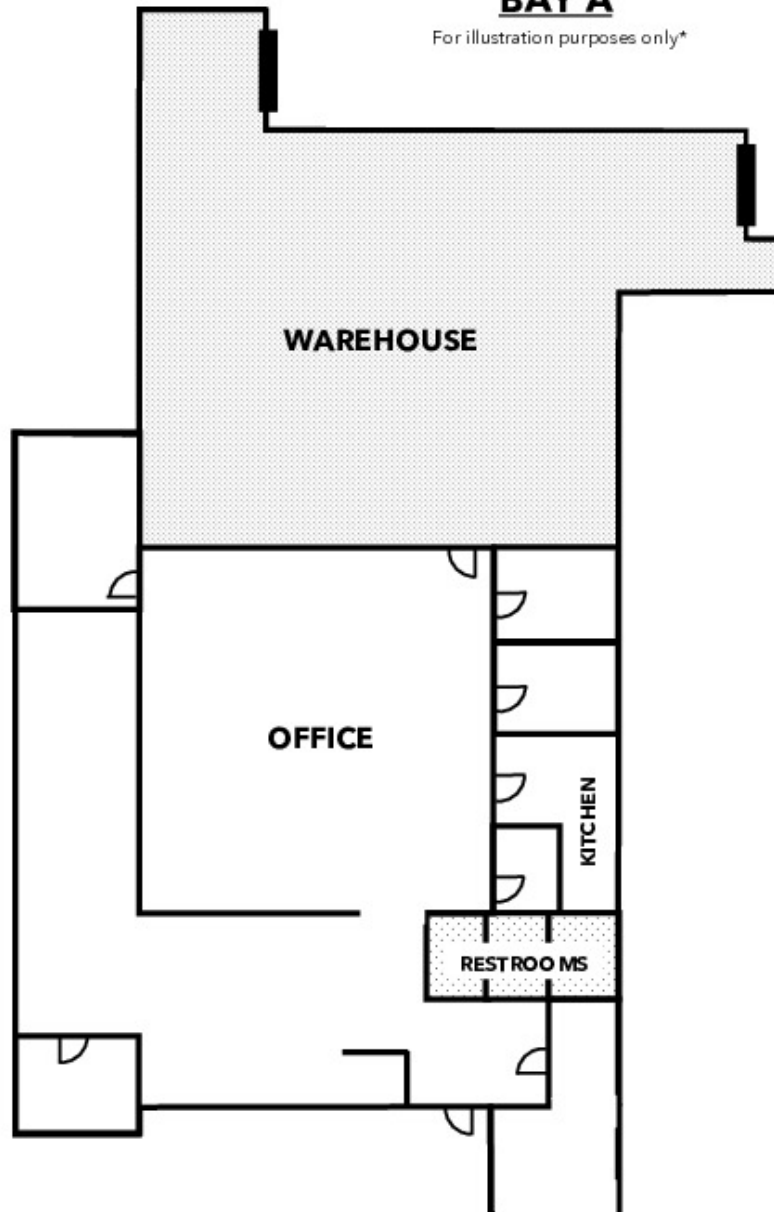

COMMERCIAL BROKERAGE AND PROPERTY MANAGEMENT

**Keith R. Graves, CCIM, SIOR**  
Senior Vice President  
954.652.2031  
kgraves@bergercommercial.com

**Daniel Forman**  
Sales Associate  
954.652.2004  
dforman@bergercommercial.com

**Jonathan Thiel**  
Senior Vice President  
954.652.2020  
jthiel@bergercommercial.com