

# O'CONNOR COMMONS I

1068 – 2,139 SF FOR LEASE

4925 N O'Connor rd Irving,  
Texas



## PROPERTY HIGHLIGHTS

- 42,568 SF Two-Story Office Building
- 1068 RSF – 2,178 RSF Available
- Quoted Rate: \$19.00 + Electric
- 3.15/1,000 Parking Ratio Available
- Class B Office Building

# O'CONNOR COMMONS I

1068 – 2,178 SF FOR LEASE

49 25 N O'Connor rd Irving,  
Texas

## FLOOR 1 FLOOR PLAN

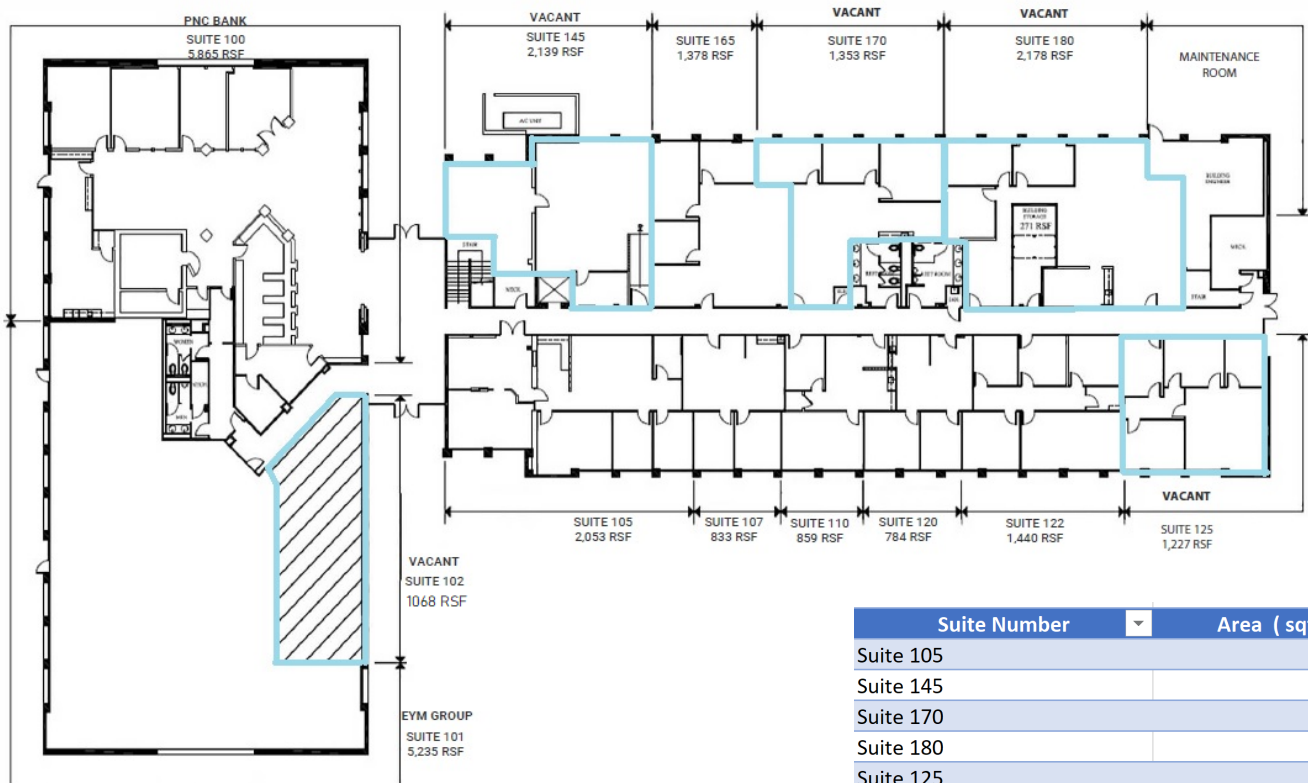

Suite Number	Area (sqft)
Suite 105	1068
Suite 145	2139
Suite 170	1353
Suite 180	2178
Suite 125	1227

O'CONNOR COMMONS - BUILDING "A"  
First Floor

4925 N. O'Connor rd.  
Irving, Texas

# O'CONNOR COMMONS I

1068 – 2,178 SF FOR LEASE

4925 N O'Connor rd Irving,  
Texas



Bar Louie  
Boi Na Braza  
Burgerim  
Delicious Deli  
El Famoso  
Freshii  
Gloria's Latin Cuisine  
Grimaldi's Pizzeria  
Irving Convention Center  
Italian Cafe  
Jinbeh Japanese  
Nosh & Bottle  
POP FACTORY  
Subsz N Stuff Deli  
Thirsty Lion  
Top Round Roast  
Beef  
Toyota Music Factory  
Trevi's Restaurant  
Vetted Well

Andalous  
The Blue Fish  
Bombay Chowpatty  
Bread Zeppelin  
Fast & Furious  
Five Guys  
Jersey Mike's Subs  
Lemon Shark Poke  
Lime Bar & Kitchen  
Little Katana  
la Madeleine  
Modern Market  
Eatery  
Nothing Bundt Cakes  
Pista House  
The Ranch  
Red Hot & Blue  
Southern Spice  
Terra Mediterranean  
Zoe's Kitchen

African Village  
Burger King  
Chop & Pop  
City Pizza Wings  
Domino's Pizza  
Empa Mundo  
Everest Restaurant  
Himalayan Aroma  
Little Caesars  
Marino's Pizza  
McDonald's  
Pho Empire  
Po' Melvin's  
Sonic Drive-In  
Subway  
Taqueria Charly  
Temptation  
Thai Chai Yo Bistro  
Wendy's

# O'CONNOR COMMONS I

1068 – 2,178 SF FOR LEASE

4925 N O'Connor rd Irving,  
Texas



## DRIVE TIMES

9 minutes to DFW Airport

14 minutes to Southlake Town Square

15 minutes to Grapevine Main Street Restaurants

15 minutes to downtown Dallas

15 minutes to Dallas Love Field Airport

30 minutes to downtown Fort Worth