



OFFICE/WAREHOUSE SPACE FOR LEASE

28039 W COMMERCIAL AVENUE, LAKE BARRINGTON, IL

Recent Improvements:
New Roof
New Parking Lot
New Tenant Monument Sign



BUILDING FEATURES:

- 2,463 SF Available ASAP
- Functional warehouse space with office to suit
- Flex space building
- Located near Pepper Road & Northwest Highway
- Easy Access near Routes 14, 59 & 22
- Grade Level Drive-in-door access/loading
- Includes bonus mezzanine space
- Abundant parking and outdoor storage potential
- 14' ceiling clear height
- Tenant signage available on new monument sign
- **Large Secure Fenced-in Yard area available for lease (Call for pricing) **
- **Rental Rate: \$12.00 PSF Modified Gross**

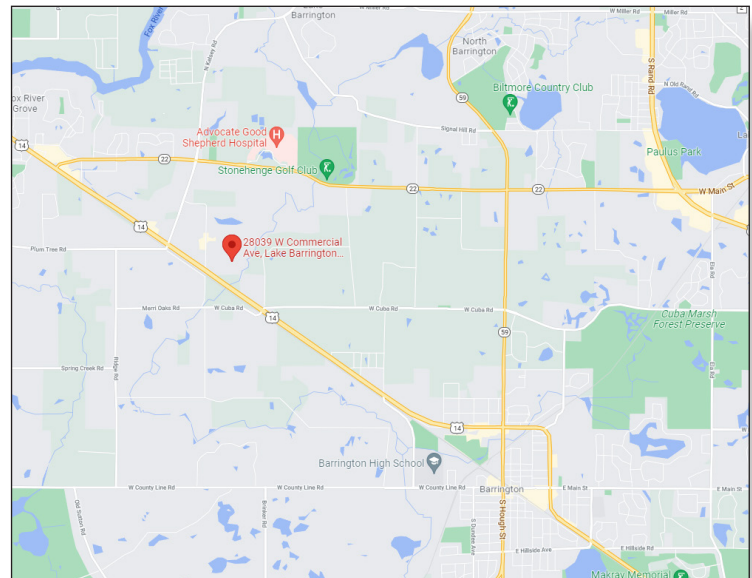

AVAILABLE SPACE:

SUITE	SIZE (SF)	OFFICE (SF)	LOADING
5	2,463 SF	500 SF	I-Drive In door
			Available ASAP

FOR MORE INFORMATION:

RANDY OLCZYK
Direct: 847.246.9611
randy@chicagolandcommercial.com

TOM CALLAHAN
Direct: 847.246.9636
Tom@chicagolandcommercial.com



4811 Emerson Ave Suite 112, Palatine, IL 60067



OFFICE/WAREHOUSE SPACE FOR LEASE

28039 W COMMERCIAL AVENUE, LAKE BARRINGTON, IL

AREA MAPS

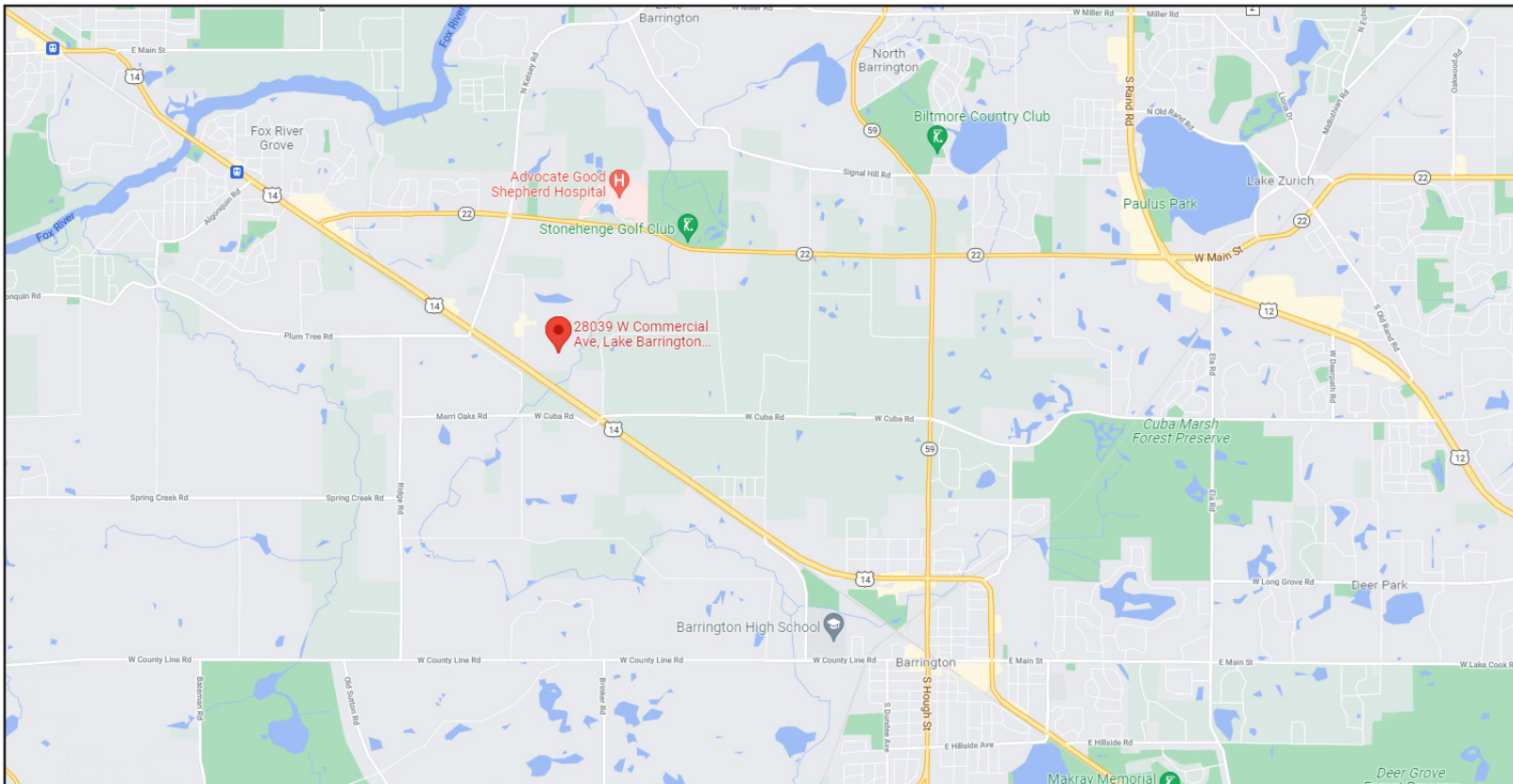



OFFICE/WAREHOUSE SPACE FOR LEASE

28039 W COMMERCIAL AVENUE, LAKE BARRINGTON, IL

SUITE 1 & 2 PHOTOGRAPHS

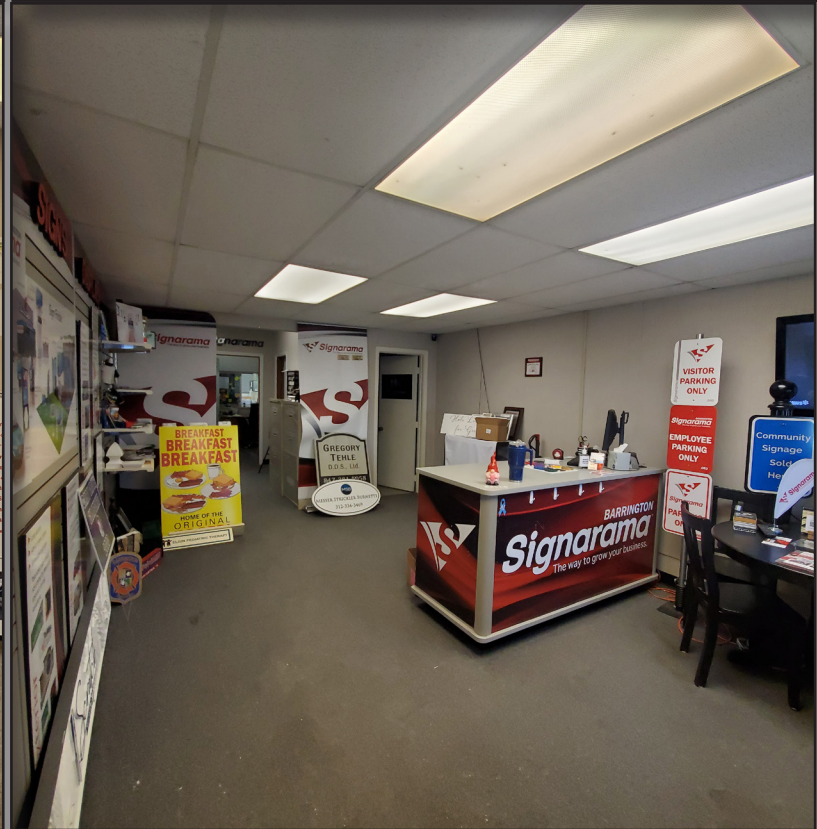
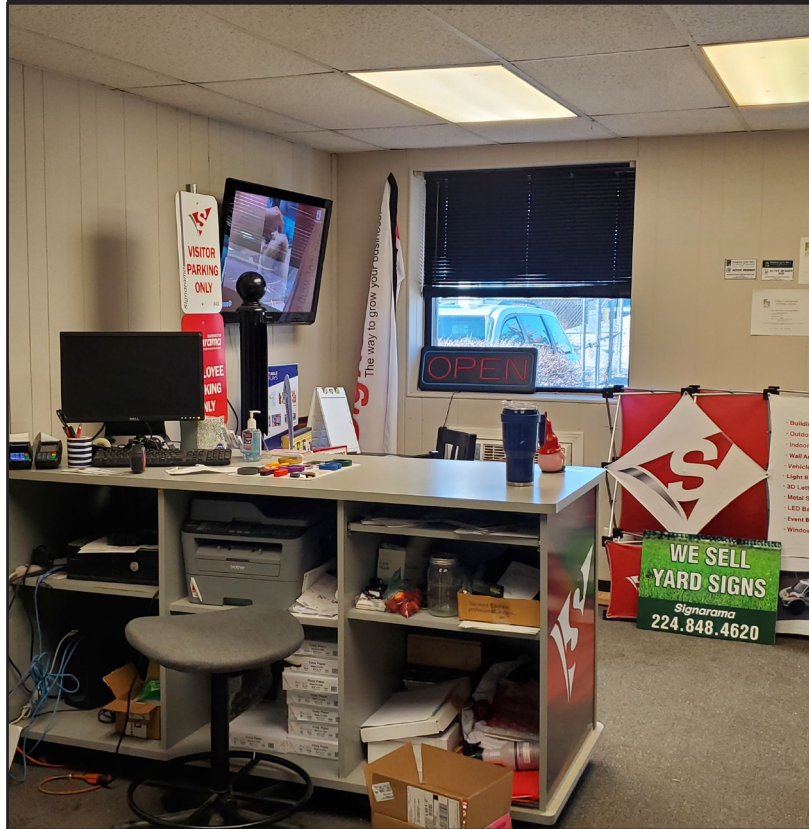
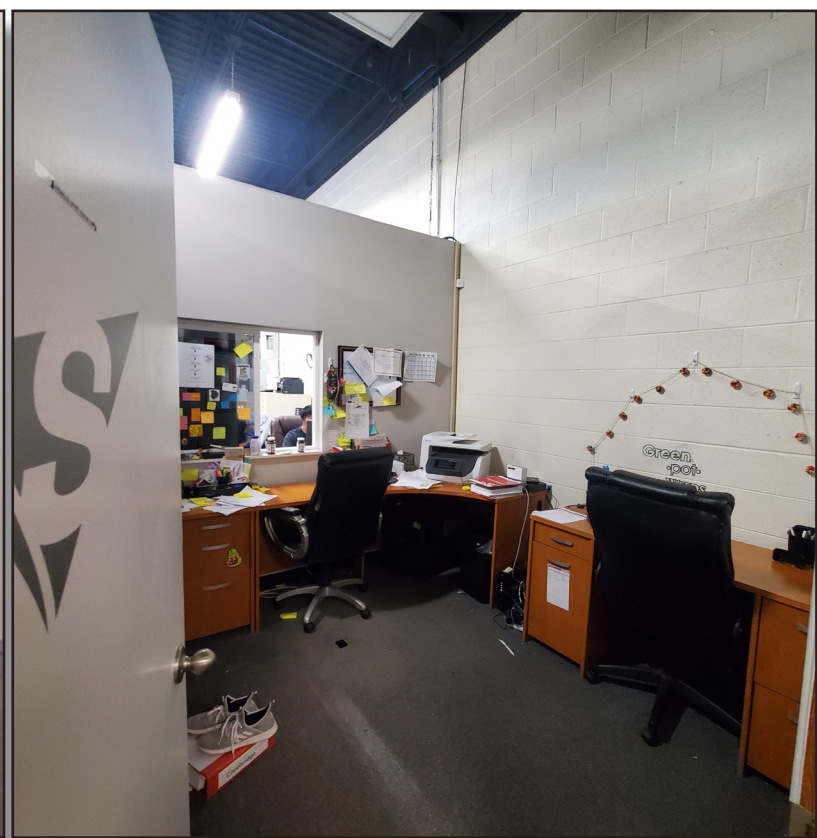



OFFICE/WAREHOUSE SPACE FOR LEASE

28039 W COMMERCIAL AVENUE, LAKE BARRINGTON, IL

SECURE OUTDOOR STORAGE/YARD SPACE FOR LEASE (CALL FOR PRICING)

