

GRAND PARKWAY

9400 FM 2920

3 INDUSTRIAL BUILDINGS WITH 541,000_± SF



The first North Grand Parkway industrial opportunity of it's kind serving Cypress, Klein, Tomball, Magnolia and The Woodlands.

LINCOLN
PROPERTY
COMPANY

POPULATION REACH



AREA RETAILERS

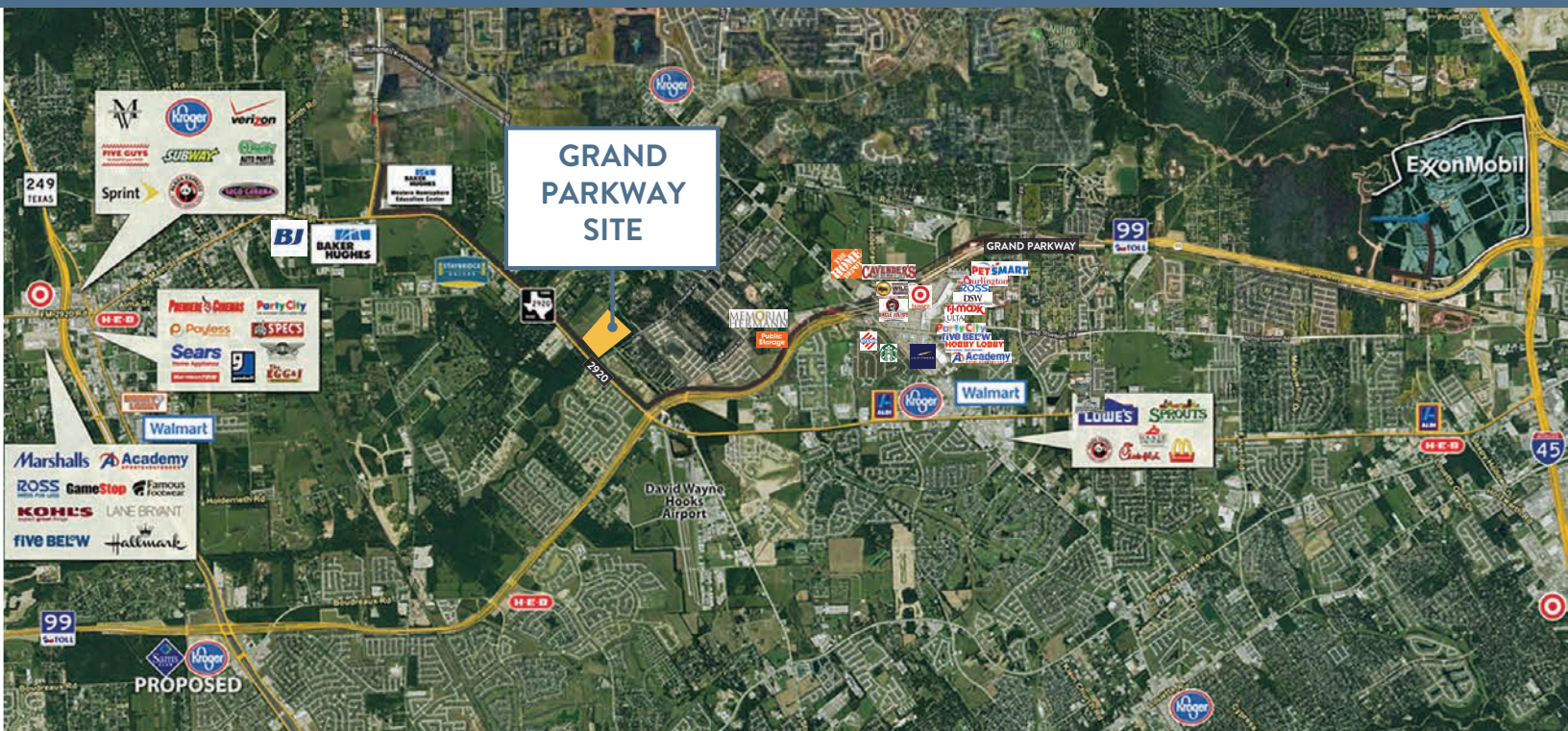

SITE PLAN

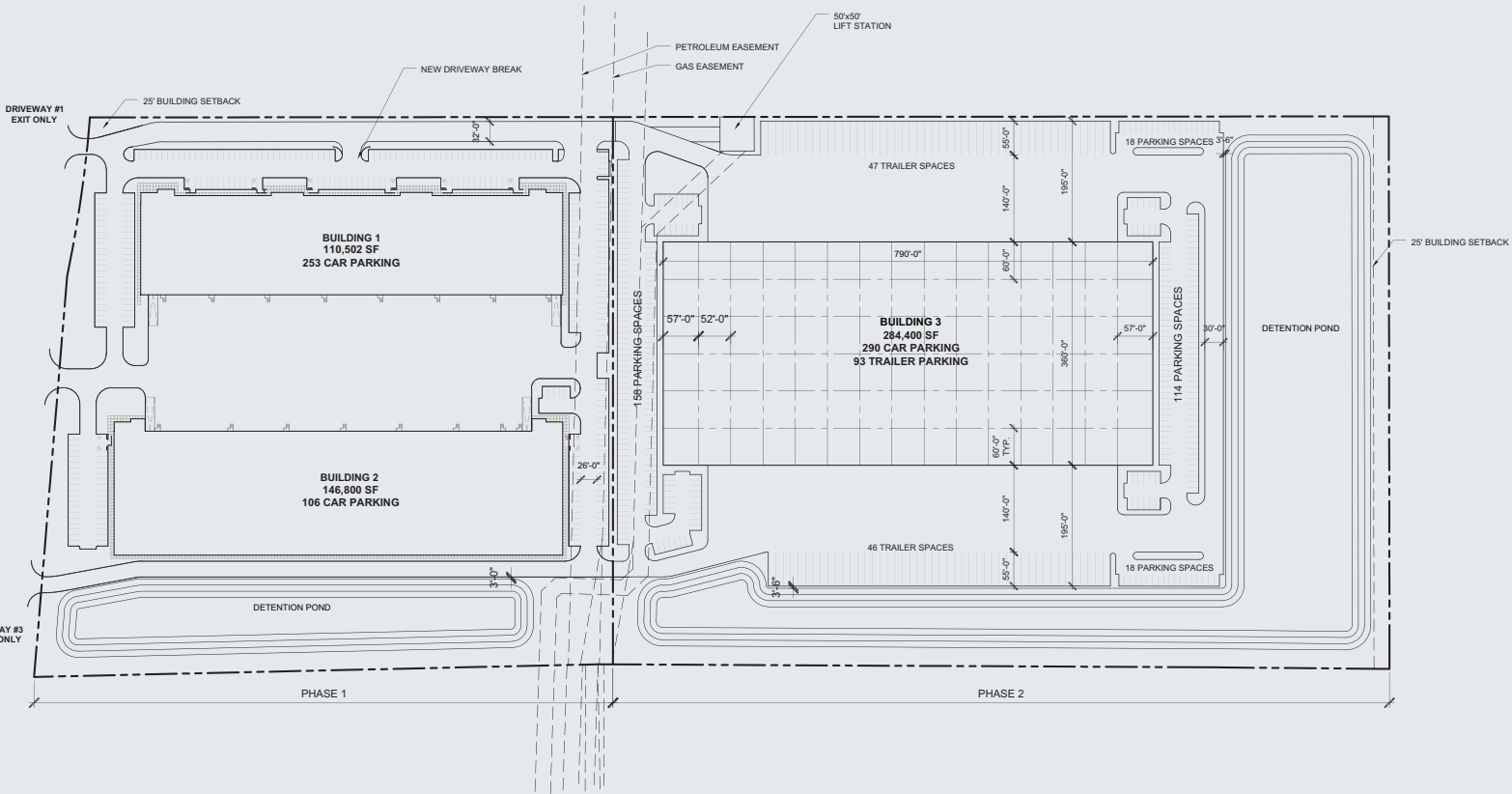

BUILDING FEATURES

UNDER CONSTRUCTION / DRIED IN READY FOR TENANT CONSTRUCTION

	SIZE	CLEAR HEIGHT	DEPTH	POWER	PARKING SPACES	DOCK DOORS/RAMPS	TRAILER SPACES
BUILDING 1	110,502 SF	24'	160'	2,000 AMPS	253	40/2	--
BUILDING 2	146,800 SF	32'	200'	2,000 AMPS	106	37/2	--
BUILDING 3	284,400 SF	36'	360'	3,000 AMPS	309	100/4	93+

*All ramps have oversized doors (12'x14')



**GRAND
PARKWAY**
44 ACRES SITE

**DAVID WAYNE
HOOKS MEMORIAL
AIRPORT**

LINCOLN PROPERTY COMPANY

WWW.LPCHOUSTON.COM

FOR LEASING INFORMATION:

Kevin Wyatt, Senior Vice President
kwyatt@lpc.com
281.875.7800

Robert Willard, Leasing Representative
rwillard@lpc.com
281.875.7811

SuAnna Sanchez, Leasing Representative
ssanchez@lpc.com
281.875.7655