

**3483 CHICAGO AVENUE
RIVERSIDE, CA 92507**

**FOR LEASE
± 8,327 SF
INDUSTRIAL**



JACKIE BEAUCHAMP

(951) 684-1251 | jbeauchamp@mcgre.com

DRE License # #01461175 | #01899258



**MARTIN
COMMERCIAL
GROUP**
Commercial Real Estate Services

WWW.MCGRE.COM

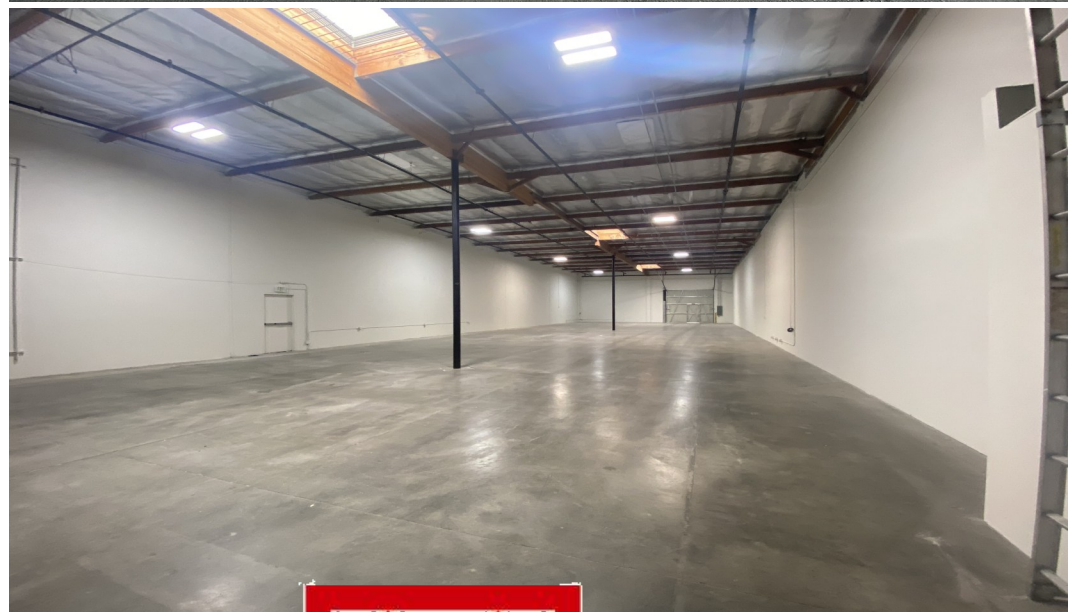

JACKIE BEAUCHAMP

(951) 684-1251 | jbeauchamp@mcgre.com

DRE License # #01461175 | #01899258



**MARTIN
COMMERCIAL
GROUP**

Commercial Real Estate Services

WWW.MCGRE.COM

**3483 CHICAGO AVENUE
RIVERSIDE, CA 92507**

**FOR LEASE
± 8,327 SF
INDUSTRIAL**



PROPERTY HIGHLIGHTS

- Riverside Business Park
- 204,677 SF Multi-Tenant Industrial Complex
- ± 8,327 SF Industrial Unit Coming Soon!
- Reception/showroom, 4 offices, warehouse
- Two Interior Restroom(s)
- BMP Zoning (Verify)
- Near downtown Riverside, Near UCR
- Ample Parking
- Easy Access to 215/60 Freeways

CALL AGENT TO SHOW!



**MARTIN
COMMERCIAL
GROUP**
Commercial Real Estate Services

The information contained herein has been obtained from sources we deem reliable. While we have no reason to doubt its accuracy, we do not guarantee it.

**CORPORATE OFFICE: 1495 E. WARNER AVENUE ~ SANTA ANA, CA 92705
Orange County 714-241-1141
Inland Empire: 951-684-1251**

**3483 CHICAGO AVENUE
RIVERSIDE, CA 92507**

**FOR LEASE
± 8,327 SF
INDUSTRIAL**

AVAILABLE SUITES

SUITE	SQ. FT.	BASE RENT	CAM	DESCRIPTION	AVAIL. DATE
3483 Chicago Avenue	8,327 +/-	TBD	.12/SF	Showroom, 4 additional private offices, 2 Interior restrooms, Warehouse, 1 GL Loading Door	7/1/2025



**MARTIN
COMMERCIAL
GROUP**
Commercial Real Estate Services

The information contained herein has been obtained from sources we deem reliable. While we have no reason to doubt its accuracy, we do not guarantee it.

**CORPORATE OFFICE: 1495 E. WARNER AVENUE ~ SANTA ANA, CA 92705
Orange County 714-241-1141
Inland Empire: 951-684-1251**

**3483 CHICAGO AVENUE
RIVERSIDE, CA 92507**

**FOR LEASE
± 8,327 SF
INDUSTRIAL**

FLOORPLAN

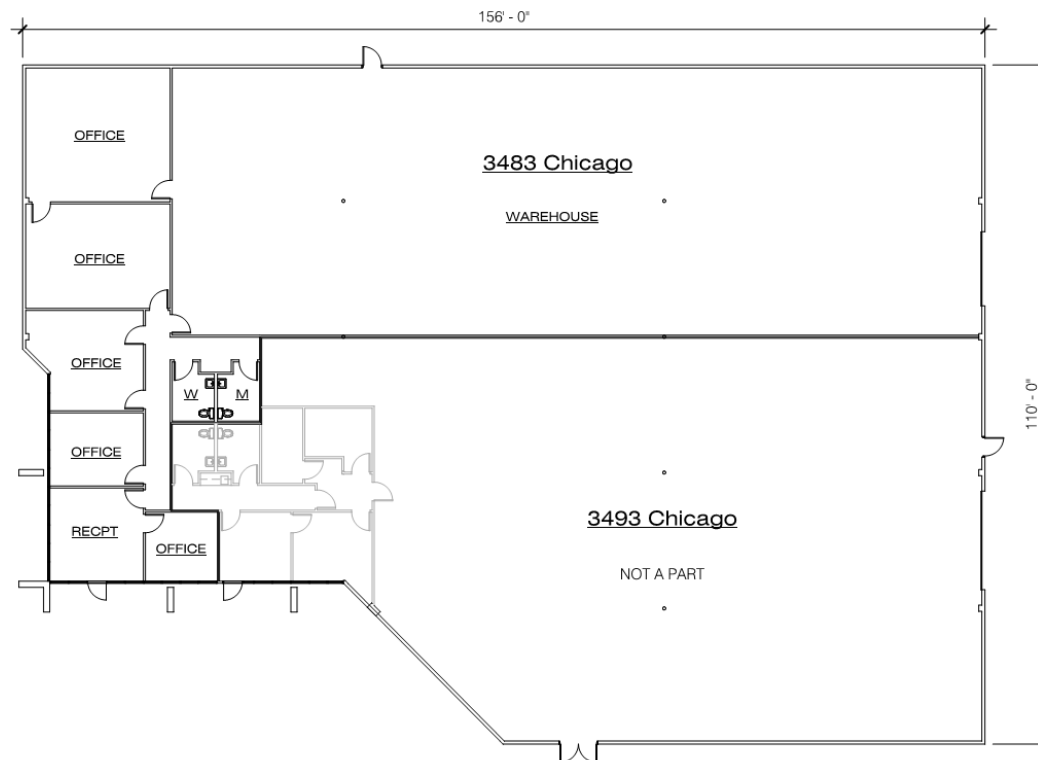

FLOOR PLAN - 3483 Chicago, Riverside
1" = 20'-0"



The information contained herein has been obtained from sources we deem reliable. While we have no reason to doubt its accuracy, we do not guarantee it.

**CORPORATE OFFICE: 1495 E. WARNER AVENUE ~ SANTA ANA, CA 92705
Orange County 714-241-1141
Inland Empire: 951-684-1251**