

SOUTHEAST CORPORATE CENTER

11900 EAST CORNELL AVE AURORA, CO 80014



FLOOR PLAN

THIRD FLOOR | 33,030 SF

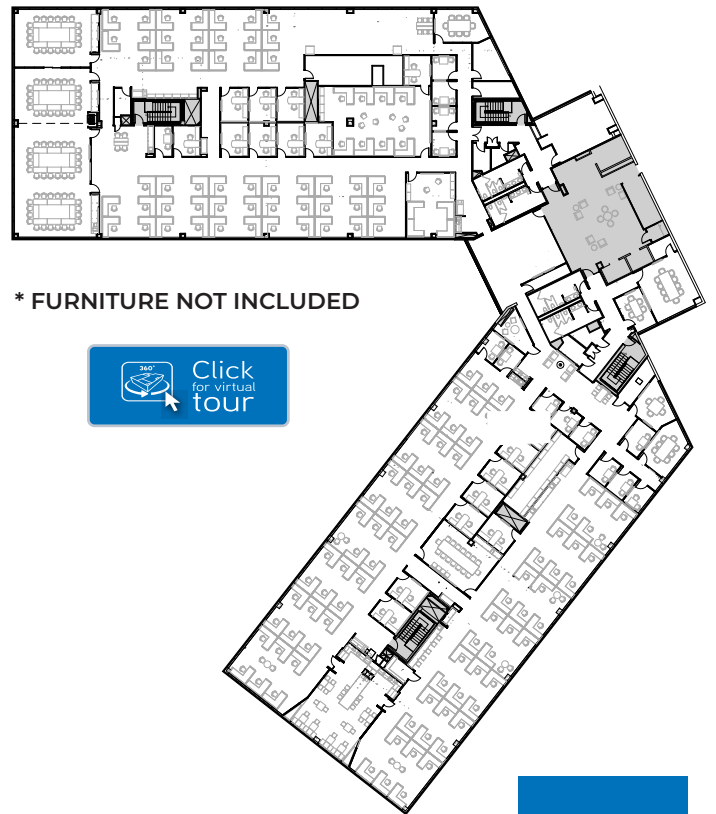

* FURNITURE NOT INCLUDED



BUILDING FEATURES

- FULL FLOOR UPDATED FINISHES
- ON-SITE SECURITY
- SECURE BUILDING
- BUILDING SIGNAGE
- COVERED AND SURFACE PARKING
- EASY ACCESS FROM PARKER RD AND 225
- WALKABLE TO LIGHT RAIL
- INSTITUTIONAL DEBT FREE OWNERSHIP
- UPCOMING LOBBY RENOVATIONS



WALKING DISTANCE FROM SOUTHEAST CORPORATE CENTER

- | | | | |
|-------------------|---|---------------------|-----------------------------------|
| 1 7/11 | 4 A BIT TWISTED
BREWERY & BBQ | 7 IHOP | 10 POPEYES |
| 2 SNARFS | 5 KING SOOPERS | 8 9 MILE PHO | 11 ARC THRIFT STORE |
| 3 WINGSTOP | 6 KING SOOPERS
PHARMACY | 9 STARBUCKS | 12 LITTLE CAESARS
PIZZA |



LEASING INFORMATION

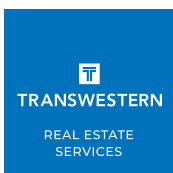

**John
Miller**
720.889.4088
john.miller@transwestern.com

5251 DTC Parkway | Suite 1100 | Greenwood Village, CO 80111 T 303.639.3000 www.transwestern.com

The information provided herein was obtained from sources believed reliable; however, Transwestern makes no guarantees, warranties or representations as to the completeness of accuracy thereof. The presentation of this property is submitted subject to errors, omissions, change of price or conditions, prior to sale or lease, or withdrawal without notice. Copyright © 2022 Transwestern.