

16692-A

Hale Ave.

Irvine, California

**±6,800 SF
FOR LEASE**



±6,800 SF FOR LEASE INDUSTRIAL FLEX BUILDING

- Available within 60 days
- Freestanding, one-story flex building
- 100% HVAC
- Drive around access
- Key-card access
- Located within Irvine Business Complex
- Walking distance to The District at Tustin Legacy

PROPERTY HIGHLIGHTS

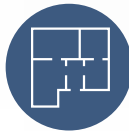

6,800 SF
UNIT A



1974
YEAR BUILT



16 FT
CLEAR HEIGHT



2:1
PARKING RATIO



1 GL
DOOR



400
AMPS (VERIFY)

NEWMARK



16692-A
Hale Ave.
Irvine, California

DIAMOND DJ
JAMBOREE

±6,800 SF FOR LEASE INDUSTRIAL FLEX BUILDING



UNIT A: ±6,800 SF

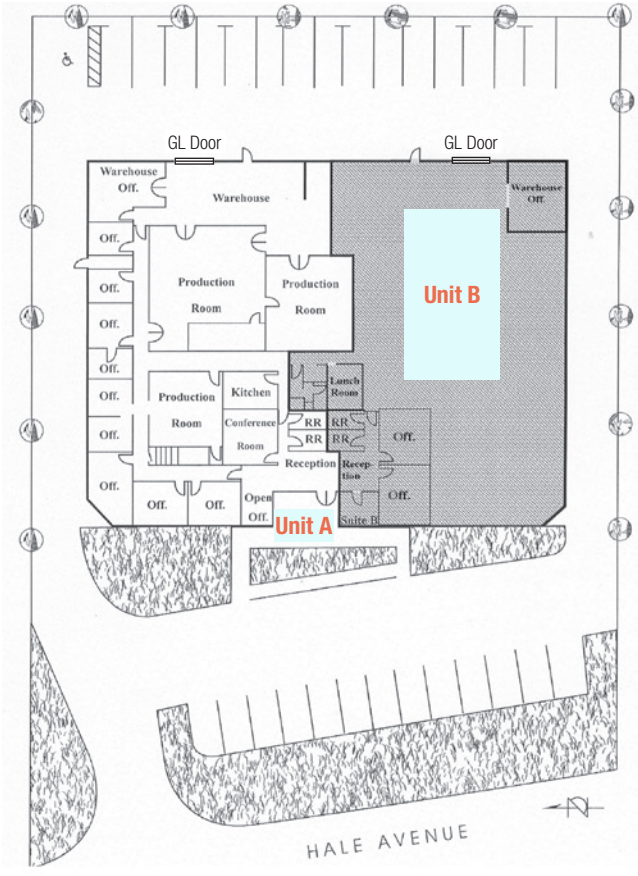

For more information, please contact:



Troy Wooton
Senior Managing Director
t 949-608-2020
troy.wooton@nrmk.com
CA RE Lic. #01377431



Zac Fielder
Director
t 949-608-2121
zac.fielder@nrmk.com
CA RE Lic. #01989549

Corporate License #01355491



The distributor of this communication is performing acts for which a real estate license is required. The information contained herein has been obtained from sources deemed reliable but has not been verified and no guarantee, warranty or representation, either express or implied, is made with respect to such information. Terms of sale or lease and availability are subject to change or withdrawal without notice.