

**FIRE EVACUATION
PLAN**

LEGEND

- ➡ PRIMARY MEANS OF EGRESS
- ➡ EMERGENCY EXIT
- ⊕ FIRE EXTINGUISHER LOCATIONS

MANAGEMENT RESPONSIBILITIES

- 1) DESIGNATE USE OF FIRE EXTINGUISHERS
- 2) TOTAL HEAD COUNT OF EMPLOYEES

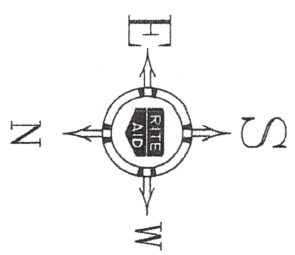

	
STORE PLANNING DEPARTMENT P. O. BOX 3165 HARRISBURG, PA 17105 (717) 761-2633	
3980	1179 E. 233RD ST BRONX, NY
DRAWN BY: JRP	DATE: 07/16/12

BAYCHESTER AVE

STRANG AVE
PARKING LOT

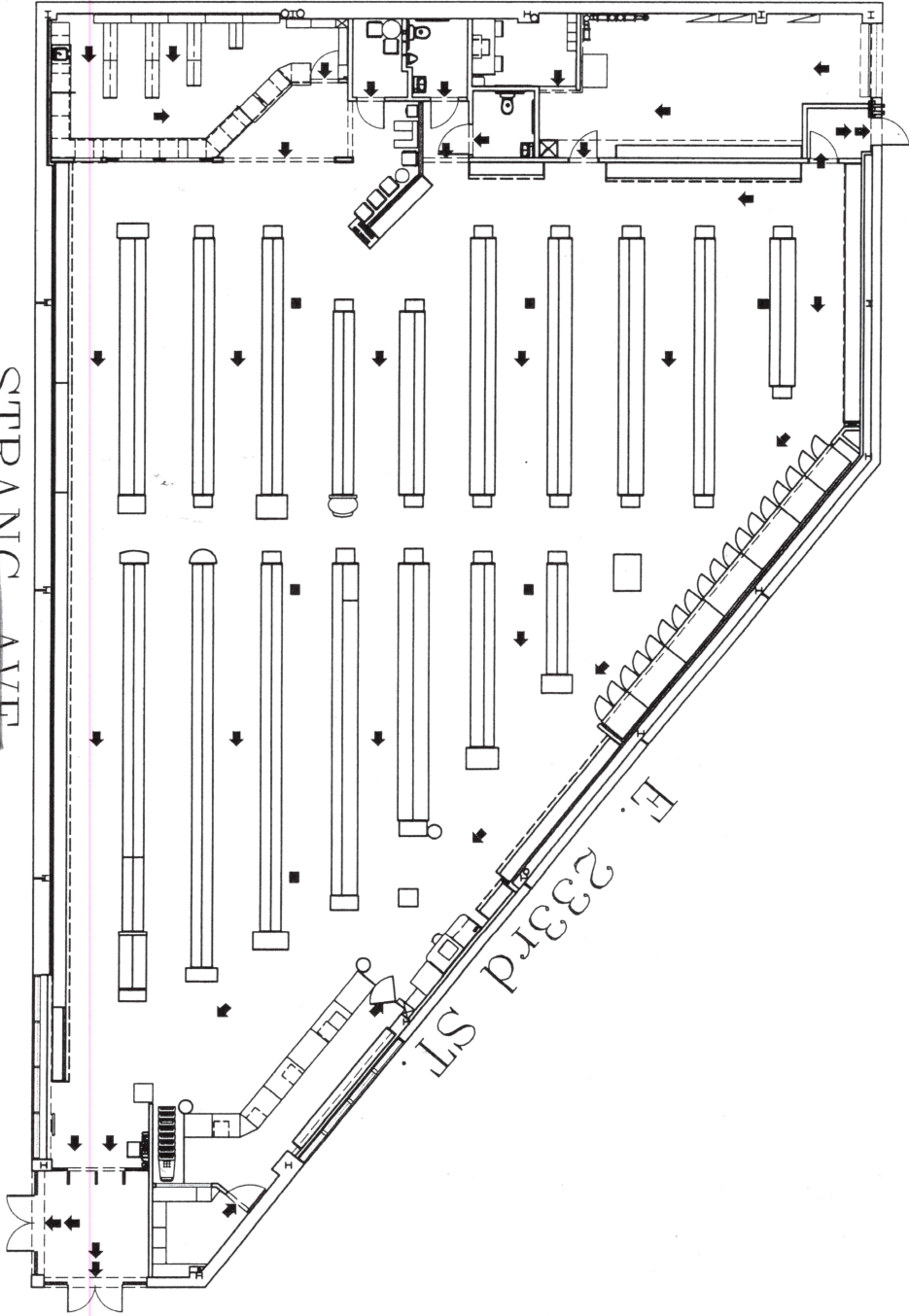

E. 233rd ST

FIRE EVACUATION PLAN

LEGEND

- ➡ PRIMARY MEANS OF EGRESS
- ➡➡ EMERGENCY EXIT
- ⊕ FIRE EXTINGUISHER LOCATIONS

MANAGEMENT RESPONSIBILITIES

- 1) DESIGNATE USE OF FIRE EXTINGUISHERS
- 2) TOTAL HEAD COUNT OF EMPLOYEES

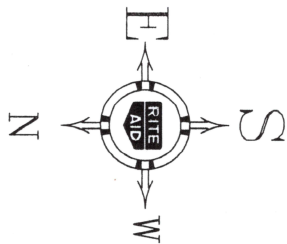

STORE PLANNING DEPARTMENT
 P.O. BOX 3165
 HARRISBURG, PA 17105
 (717) 761-2698

3980
 1179 E. 233RD ST
 BRONX, NY

DATE: 07/16/18