



Bradfordville Vacant Lot BC-1 Zoning

6875-Lot Thomasville Rd, Tallahassee, FL 32312



Joseph Serpico

Serpico Realty, Inc.

1923 Capital Cir NE, Suite 1, Tallahassee, FL 32308

serpico@serpicorealty.com

(850) 339-0119



Bradfordville Vacant Lot with BC-1 Zoning

\$15,000/month

Level lot in Bradfordville, the newest, fastest growing area of Tallahassee, FL.
Near Publix, Target, Walgreen's, banks and more.
Note:
No postal number address available yet
"6875" is the property behind lot
USE Tax ID# 1415204020000...

- Highway signage, holding pond in place, will soon have traffic light access



Rental Rate:	\$15,000/month
Property Type:	Land
Property Subtype:	Commercial
Proposed Use:	Commercial
Zoning:	BC-1

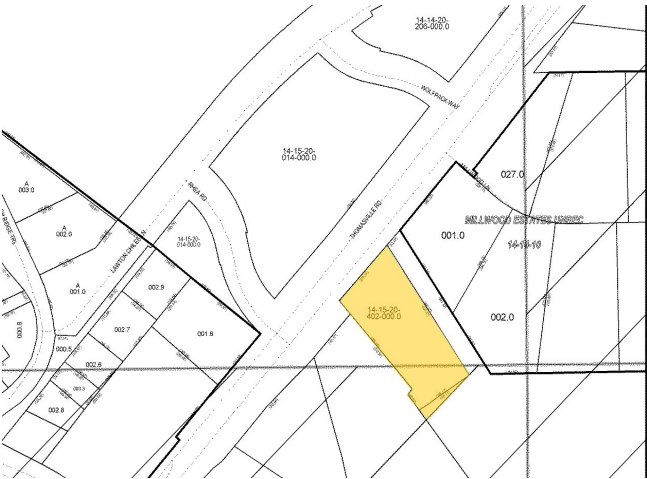

1

Available lot for lease

Space Available	1.81 AC
Rental Rate	\$15,000/month
Date Available	Now

Vacant 1.81 Acre lot, fronting on Thomasville Road
northTax ID: 1415204020000

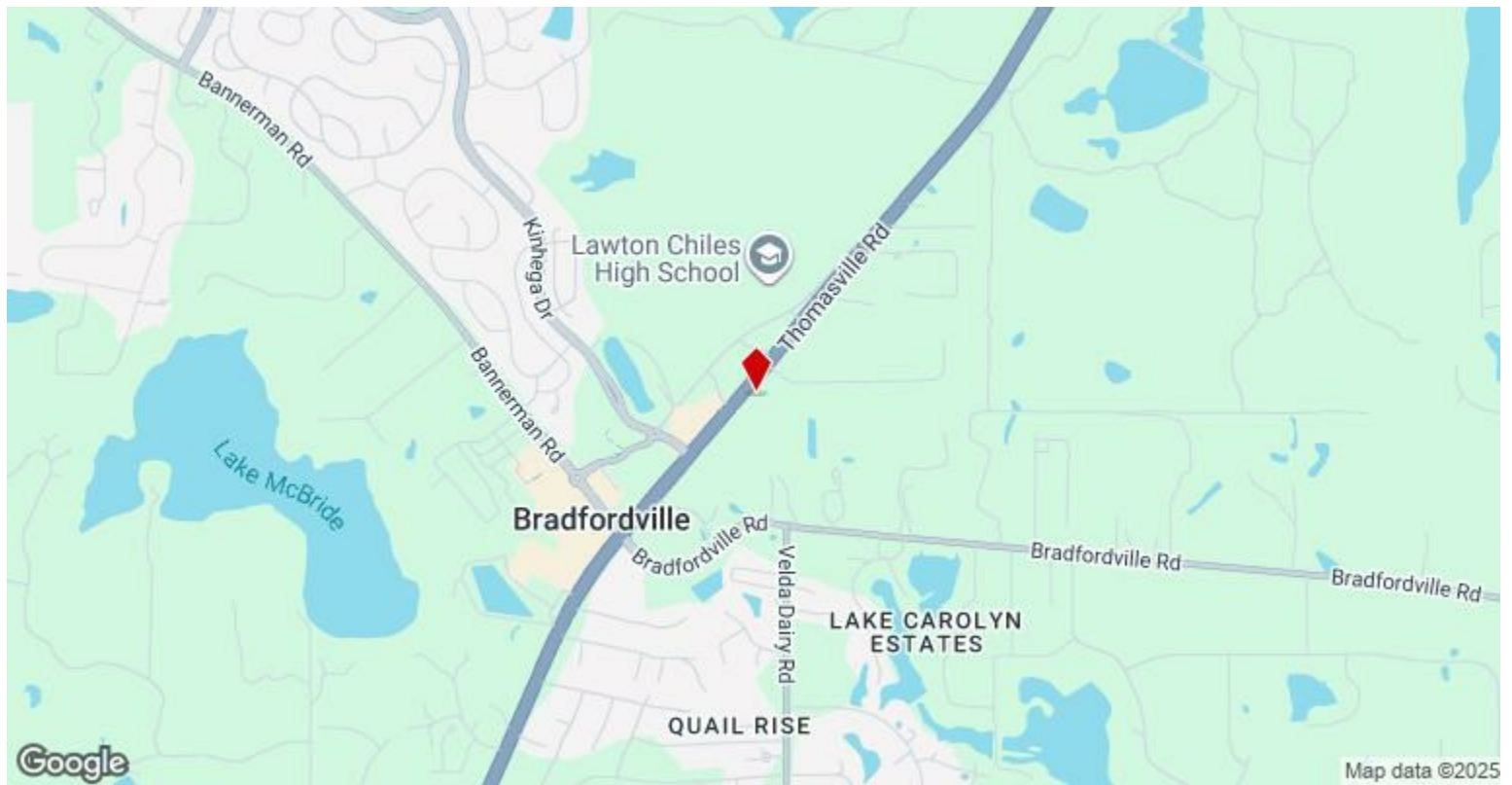

6875 Thomasville Rd, Tallahassee, FL 32312

Level lot in Bradfordville, the newest, fastest growing area of Tallahassee, FL. Near Publix, Target, Walgreen's, banks and more. Note: No postal number address available yet "6875" is the property behind lot USE Tax ID# 1415204020000

Property Photos



Other



Building Photo

Property Photos



Property Photos

