

CBRE

JOIN COMMON GROUNDS BREW & ROASTERY

  
COMMON  
GROUNDS  
Brew & Roastery

201

CLEARWATER DR.

RETAIL FOR LEASE

WEST PALM BEACH



FLOOR PLAN

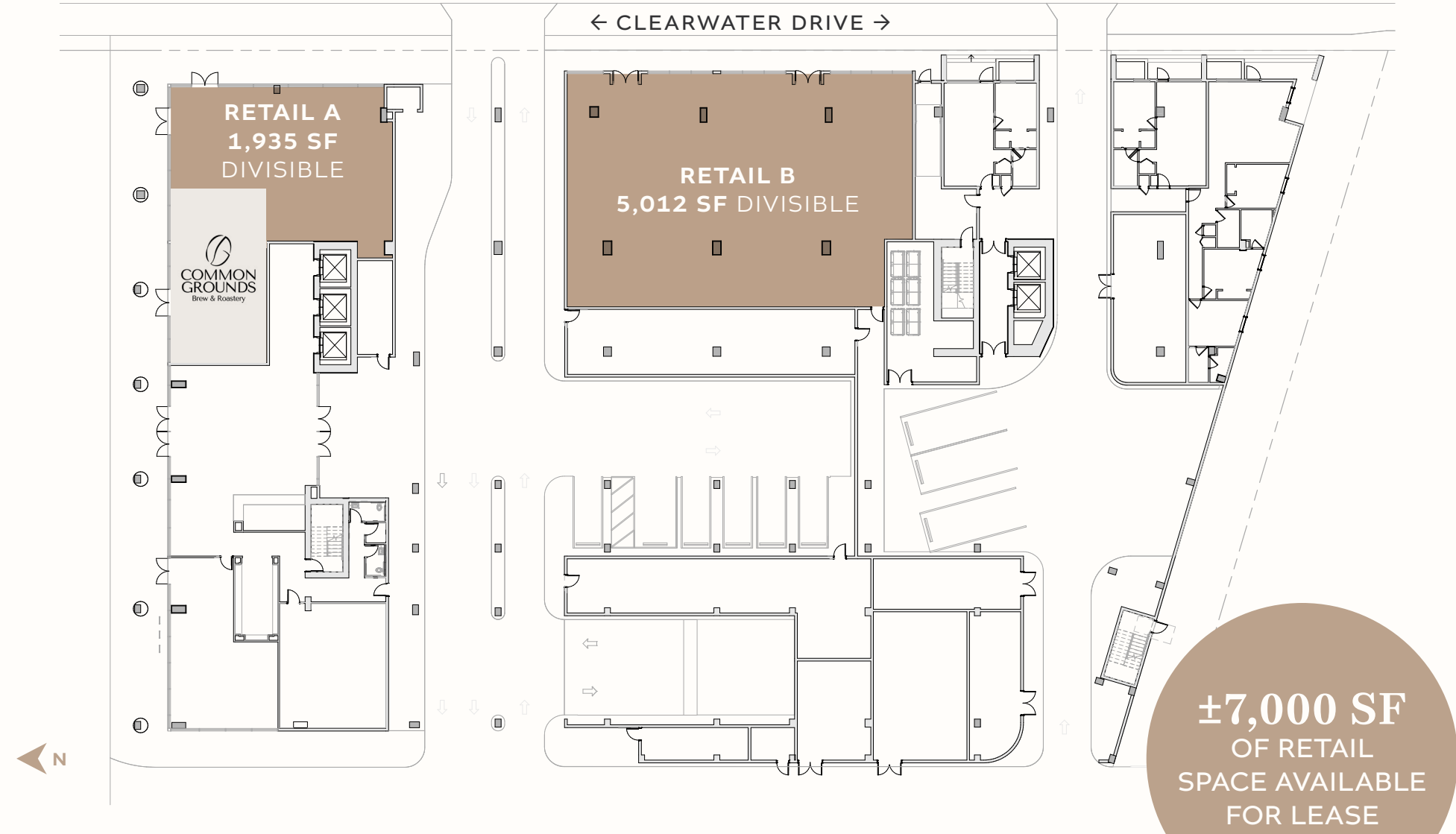

AROUND THE  
NEIGHBORHOOD:



Approximately 970 existing  
and future residential units





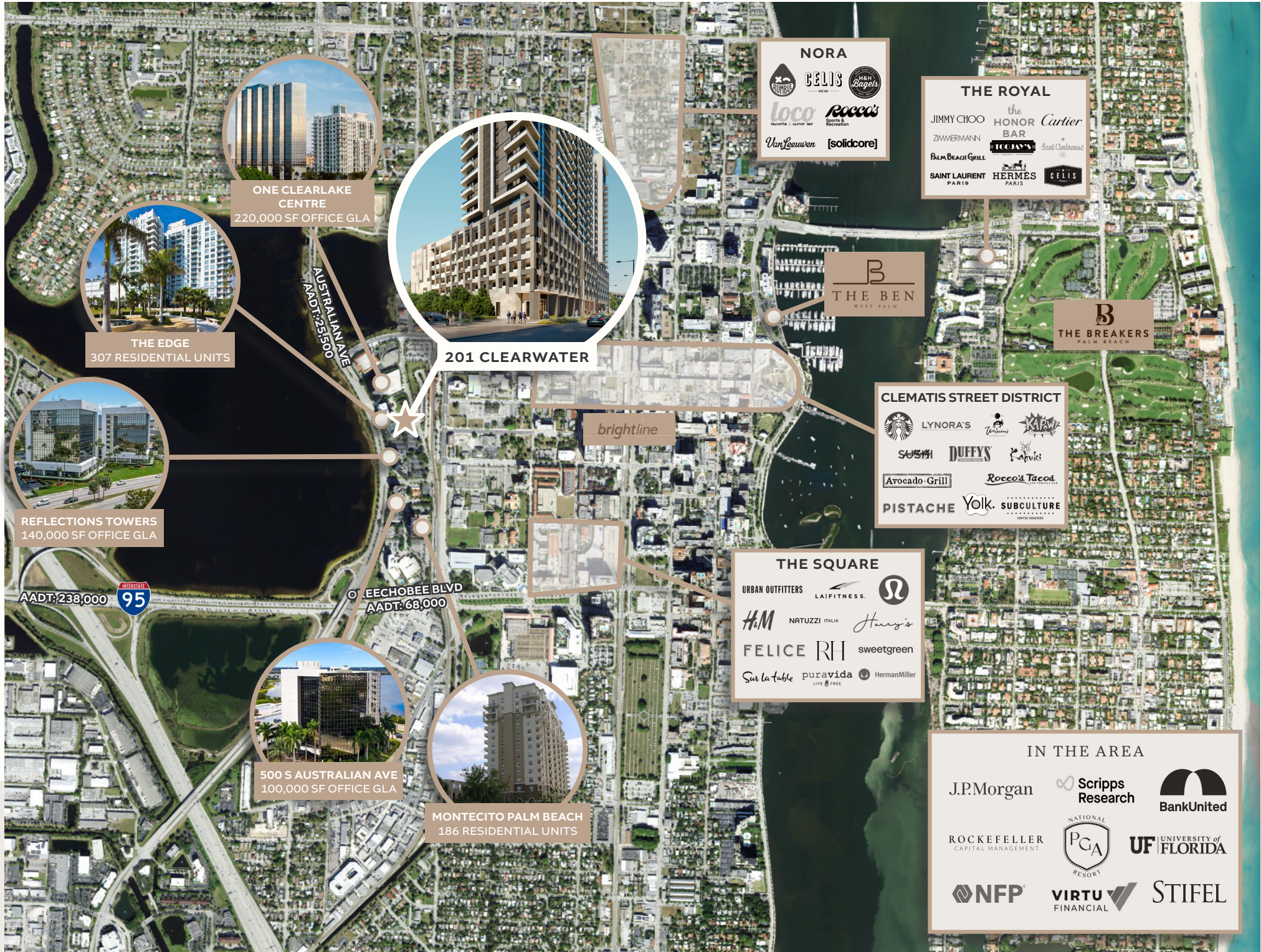



Approximately 460,000  
SF of Office Space





MARKET HIGHLIGHTS

-  Retail space available at the base of a luxury 457 unit building
-  High profile opportunity located in the sought after and rapidly expanding West Palm Beach market
-  Property situated just off of I-95 and north of Okeechobee Blvd.
-  Excellent branding and signage opportunities
-  Surface level, garage parking available
-  Ideal opportunity for a variety of users including fitness, restaurant, service and medical

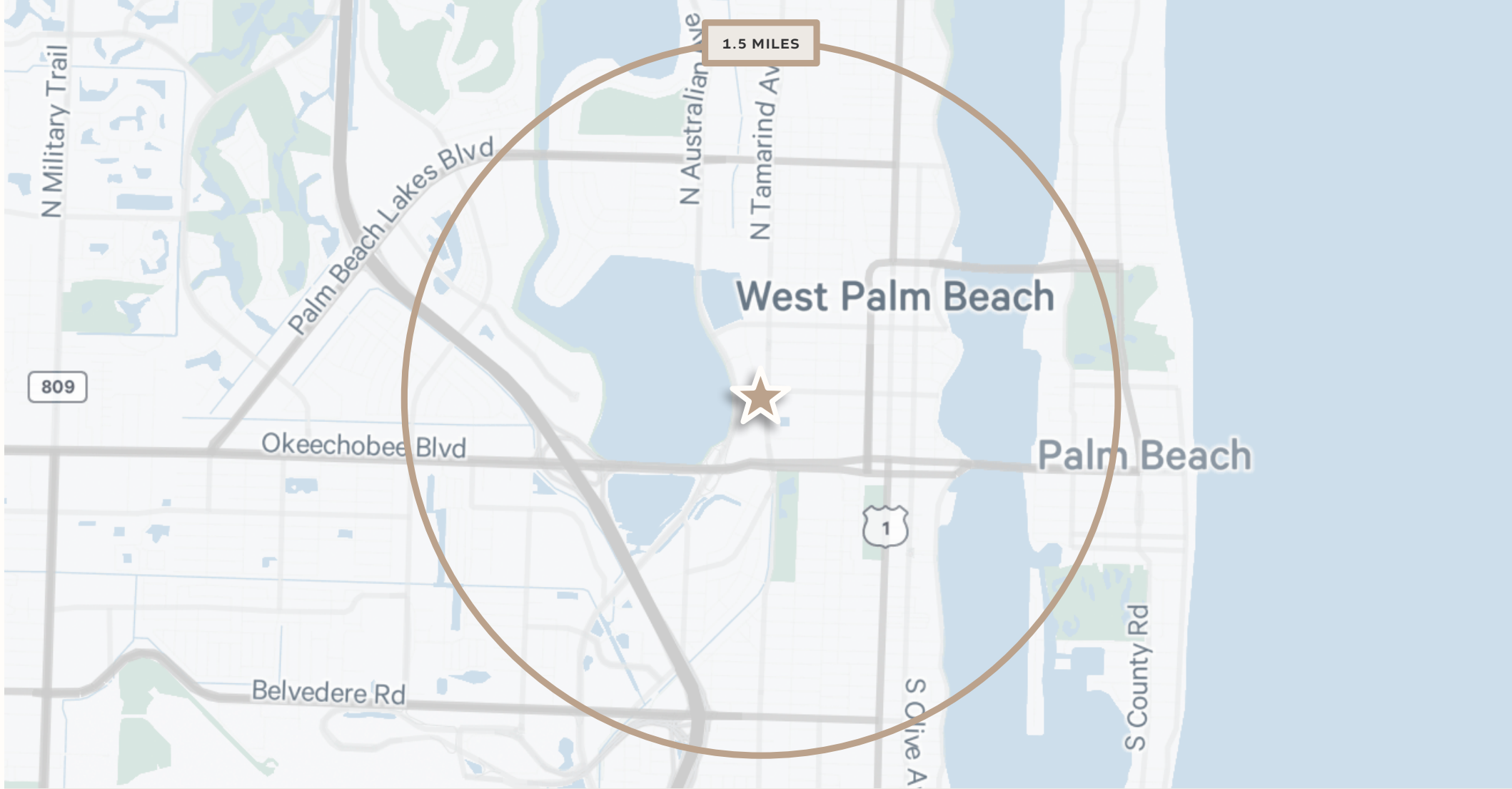

AREA DEMOGRAPHICS

\$96,597	34,873	65,017	50,266
AVERAGE HOUSEHOLD INCOME	TOTAL POPULATION	DAYTIME POPULATION	EMPLOYEES





## FOR MORE INFORMATION, CONTACT:

Jack Siragusa  
First Vice President  
+1 561 371 9214  
[jack.siragusa@cbre.com](mailto:jack.siragusa@cbre.com)

Sara Williams  
+1 561 227 1806  
[sara.williams@cbre.com](mailto:sara.williams@cbre.com)