

LANE4

4,351 SF
AVAILABLE



MISSION 7000 RETAIL SPACE FOR LEASE

7002 JOHNSON DR • MISSION, KS

SPENCER STEWART
816.268.9103 / sstewart@lane4group.com

MISSION 7000

- Retail space available in the heart of Mission, KS
 - Also ideal for: restaurant, service, or medical
- Prime location on a hard corner with great visibility:
 - 39,000+ CPD on Metcalf Ave, and 23,000+ CPD on Johnson Dr
- Facade and pylon signage opportunities

| DEMOGRAPHICS | 1 MI | 3 MI | 5 MI |
|-------------------|----------|-----------|-----------|
| Population | 10,439 | 91,083 | 255,958 |
| Average HH Income | \$91,927 | \$100,907 | \$111,738 |
| # of Businesses | 901 | 4,038 | 12,391 |
| # of Employees | 15,974 | 56,283 | 175,076 |



4,351 SF

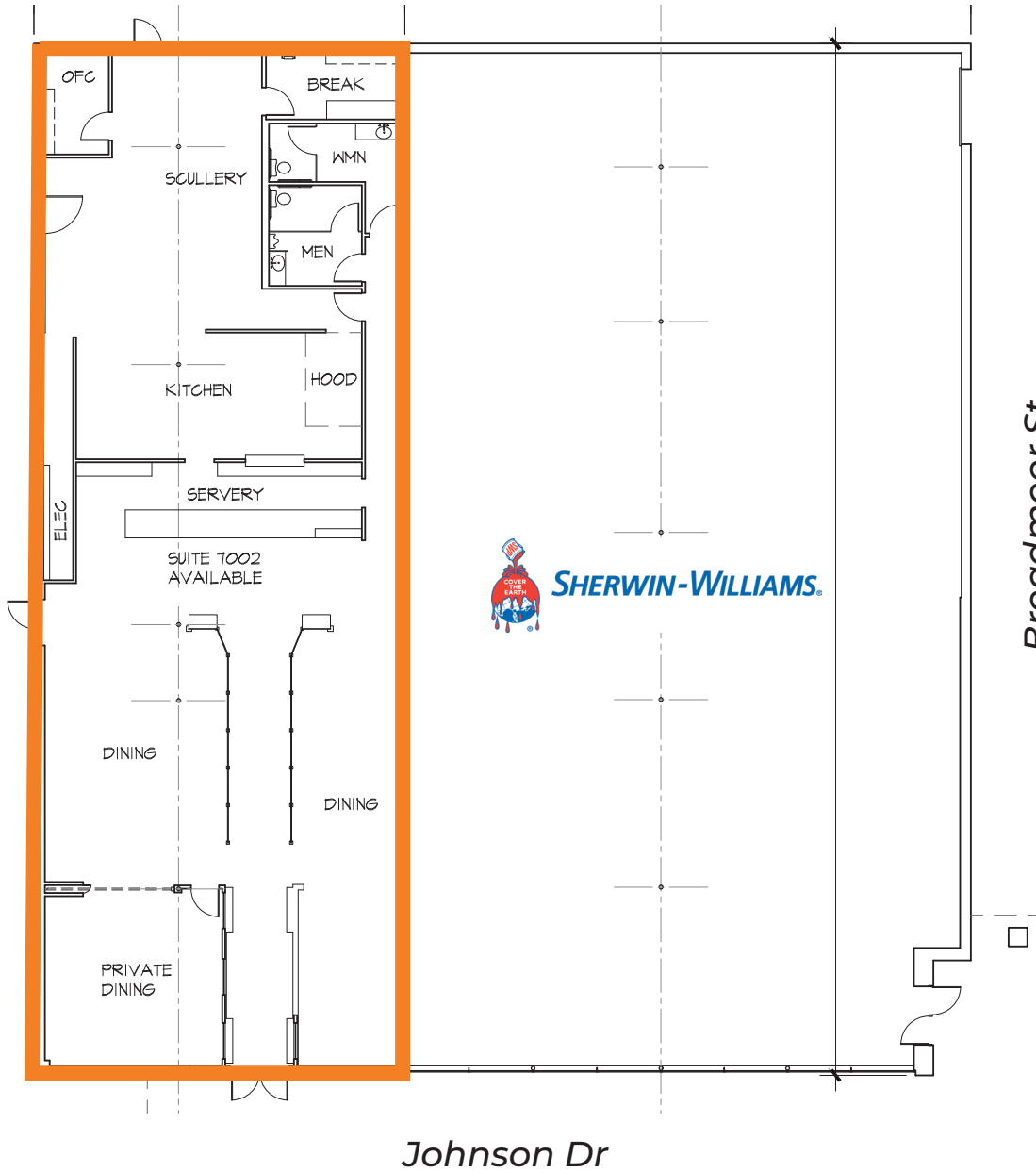



Merriam Town Center

CINEMARK
The Best Seat In Town

DICK'S SPORTING GOODS
Marshall's
PET SMART

THE HOME DEPOT
ROSS DRESS FOR LESS
OfficeMax

BOB'S FURNITURE
OLD NAVY **Walgreens**

Mission Apartments
307 Units
- Proposed -

Mission Gateway
Mixed-Use Development
- Proposed -

Fairway Apartments
221 Units, Under Construction

HOBBY LOBBY

23,671 CPD

Shawnee Mission North High School

169

NATURAL GROCERS

Planet Fitness

Johnson Dr

SITE

HyVee

Downtown Mission

BAR **ROCK CREEK** **Lalman's Donuts**

Sully's pub **The Point**

LONGBOARDS wraps & bowls **SANDHILLS BREWING**

Shawnee Mission Pkwy

TARGET

39,164 CPD

63rd St

GENESIS

Antioch Rd

Metcalf Ave

Nail Ave

Roe Ave

The Village

hen house **ACE Hardware**

FRENCH MARKET **Caffetteria**

Duke **ELSTON** **bijin**

SCOOBIE **clique**

GOLDEN & PINE **Tavern**

