

# FOR LEASE

Up to 9,629 RSF



## SINGLE-STORY OFFICE SPACE

### Kirts on the Blvd

50-200 Kirts Blvd  
Troy MI, 48084

### Property Highlights

- Prime Troy Location
- Single-Story Office Buildings
- Beautiful and Well-Maintained Exteriors/Landscaping
- Professional Local Ownership / Management
- Convenient On-Site Parking for Tenants and Visitors
- High Visibility and Easy Access to I-75
- Competitive Rental Rates
- Close Distance to all Local Amenities such as Restaurants, Cafes and Retail
- Walkable On-Site Amenities including Gym, Restaurants and Yoga Studio
- Outdoor Green Space
- High Speed Internet / Fiber Options, Reliable HVAC and LED Lighting
- Open Layouts that can be Modified to Suit your Needs

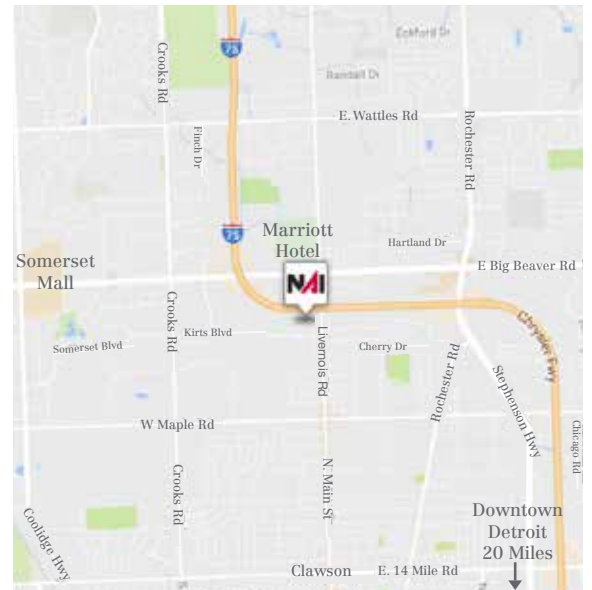

The information contained herein has been given to us by the owner of the property or other sources we deem reliable. We have no reason to doubt its accuracy, but we do not guarantee it. All information should be verified prior to lease or purchase.



For more information, contact:

**Lesley Gutman**      **Sheila Fogarty**

248 860 6800

248 798 9813

lgutman@farbman.com

fogarty@farbman.com

# FLOOR PLAN

Up to 9,629 RSF

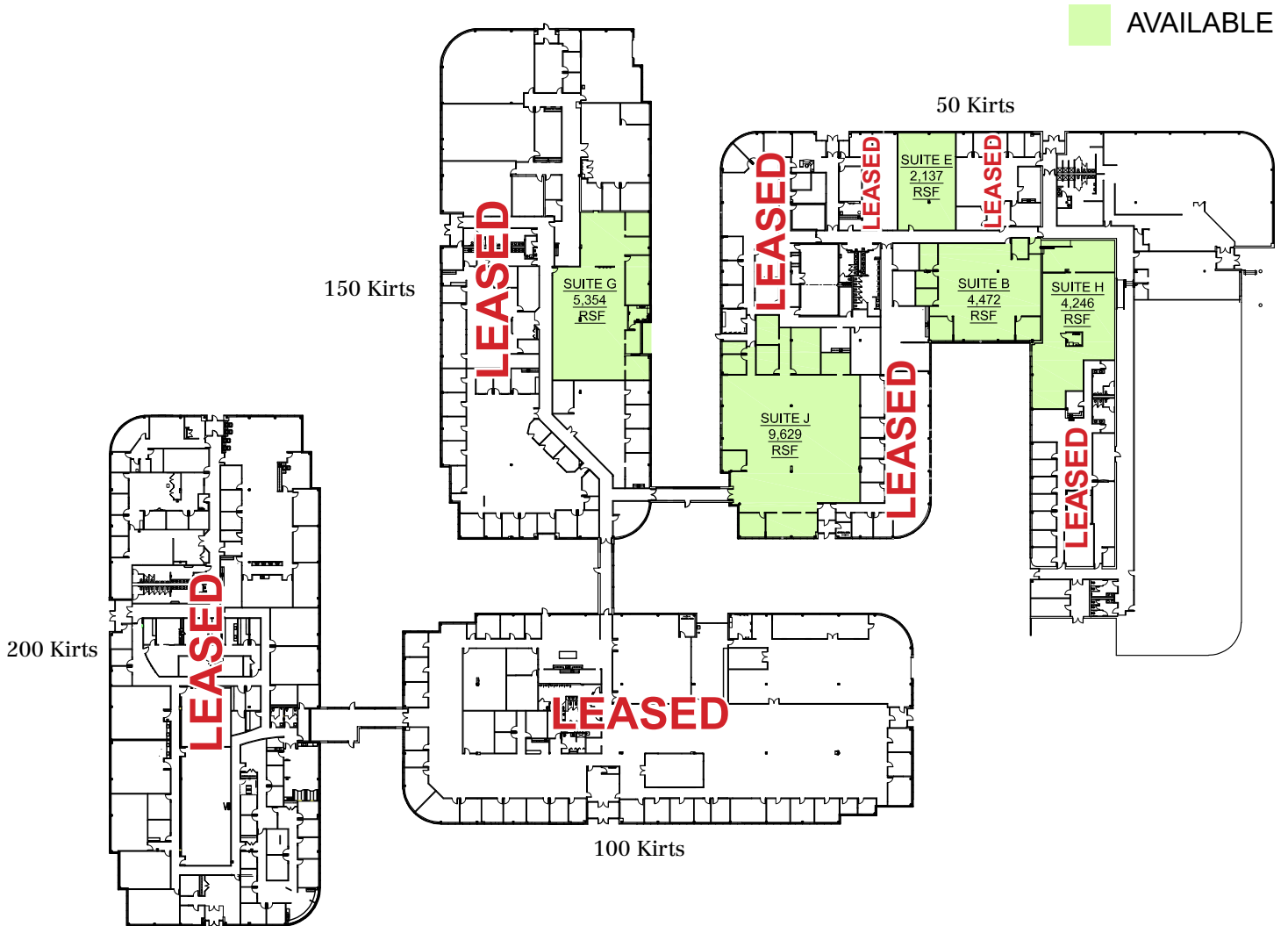

## Availability

Suite	RSF
150 Kirts, Suite G	5,354
50 Kirts, Suite B	4,472
50 Kirts, Suite E	2,137
50 Kirts, Suite H	4,246
50 Kirts, Suite J	9,629

# OVERHEAD VIEW

Up to 9,629 RSF

